



## MEDWAY COUNCIL

Licensing Authority, Gun Wharf, Dock Road, Chatham, Kent ME4 4TR

### Premises Licence

Premises Licence Number

**Medway-08-PREM-0493**

#### Part 1 - Premises Details

Postal address of premises, or if none, ordnance survey map reference or description <b>Cricketers 88 High Street Rainham</b>	
Post town <b>Gillingham, Kent</b>	Post code <b>ME8 7JH</b>
Telephone number <b>01634 387272</b>	
Where the licence is time limited the dates: <b>Not Applicable</b>	
Licensable Activities authorised by the licence <b>Sale of Retail of Alcohol, Live Music (on the premises), Recorded Music (on the premises), Anything Similar – DJ, Disco &amp; Karaoke (on the premises) and Late Night Refreshment (on the premises).</b>	
The times the licence authorises the carrying out of licensable activities <b><u>Sale of Retail of Alcohol</u></b> <b>Sunday to Thursday 09:00 to 00:00 and Friday to Saturday 09:00 to 01:00.</b> <b>Non Standard Times:- Extended 1 hour on the following occasions: St. Patrick's Day, St. George's Day, Bank Holidays (set by Government) Easter – Friday, Saturday, Sunday &amp; Monday, May – Saturday, Sunday &amp; Monday, Whitsun – Saturday, Sunday &amp; Monday, August – Saturday, Sunday &amp; Monday, Christmas – Christmas Eve, Christmas Day &amp; Boxing Day and New Year – New Years Day. Extended from the end of permitted hours New Years Eve to the beginning of permitted hours New Years Day.</b>	
<b><u>Live Music, Recorded Music &amp; Anything Similar</u></b> <b>Sunday to Thursday 09:00 to 00:00 and Friday to Saturday 09:00 to 01:00.</b> <b>Non Standard Times:- Extended 1 hour on the following occasions: St. Patrick's Day, St. George's Day, Bank Holidays (set by Government) Easter – Friday, Saturday, Sunday &amp; Monday, May – Saturday, Sunday &amp; Monday, Whitsun – Saturday, Sunday &amp; Monday, August – Saturday, Sunday &amp; Monday, Christmas – Christmas Eve, Christmas Day &amp; Boxing Day and New Year – New Years Day. Extended from the end of permitted hours New Years Eve to the beginning of permitted hours New Years Day.</b>	
<b><u>Late Night Refreshment</u></b> <b>Sunday to Thursday 23:00 to 00:00 and Friday to Saturday 23:00 to 01:00.</b> <b>Non Standard Times:- Extended 1 hour on the following occasions: St. Patrick's Day, St. George's Day, Bank Holidays (set by Government) Easter – Friday, Saturday, Sunday &amp; Monday, May – Saturday, Sunday &amp; Monday, Whitsun – Saturday, Sunday &amp; Monday, August – Saturday, Sunday &amp; Monday, Christmas – Christmas Eve, Christmas Day &amp; Boxing Day and New Year – New Years Day. Extended from the end of permitted hours New Years Eve to the beginning of permitted hours New Years Day.</b>	

<p>The opening hours of the premises  <b>Sunday to Thursday 09:00 to 00:30, Friday to Saturday 09:00 to 01:30.</b>  <b>Non Standard Times:-</b> Opening hours will be extended one hour after the times and occasions listed above.  <b>The premises may open outside authorised hours for non-licensable activities subject to planning or other legislation.</b></p>
<p>Where the licence authorises supplies of alcohol whether these are on and/or off supplies  <b>On and Off Supplies</b></p>

## Part 2

<p>Name, (registered) address, telephone number and e-mail (where relevant) of holder of premises licence  <b>Greene King Brewing &amp; Retailing Limited</b>  <b>Westgate Brewery</b>  <b>Bury St. Edmunds</b>  <b>Suffolk IP33 1QT</b>  <b>Tel: 01284 763222</b></p>
<p>Registered number of holder, for example company number, charity number (where applicable)  <b>Limited Company - 3298903</b></p>
<p>Name, address and telephone number of designated premises supervisor where the premises licence authorises the supply of alcohol  <b>Lyndsay Pilbeam</b></p>
<p>Personal licence number and issuing authority of personal licence held by designated premises supervisor where the premises licence authorises the supply of alcohol</p>

**Signed on behalf of the issuing licensing authority**

## Legal and Governance

### Annex 1 – Mandatory Conditions

#### **Condition 1**

**No supply of alcohol may be made under this licence:-**

- (a) At a time when there is no designated premises supervisor in respect of it or
- (b) At a time when the designated premises supervisor does not hold a personal licence or his/her personal licence is suspended.

**Every retail sale or supply of alcohol made under this licence must be made or authorised by a person who holds a personal licence.**

#### **Condition 2**

**Only individuals licensed by the Security Industry Authority (SIA) may be used at the premises to guard against:-**

- (a) Unauthorised access or occupation (e.g. through door supervision)
- (b) Outbreaks of disorder
- (c) Damage

#### **Condition 3**

- (1) The responsible person must ensure that staff on relevant premises do not carry out, arrange or participate in any irresponsible promotions in relation to the premises.

- (2) In this paragraph, an irresponsible promotion means any one or more of the following activities, or substantially similar activities, carried on for the purpose of encouraging the sale or supply of alcohol for consumption on the premises**
- (a) Games or other activities which require or encourage, or are designed to require or encourage, individuals to**
    - (i) Drink a quantity of alcohol within a time limit (other than to drink alcohol sold or supplied on the premises before the cessation of the period in which the responsible person is authorised to sell or supply alcohol) or**
    - (ii) Drink as much alcohol as possible (whether within a time limit or otherwise)**
  - (b) Provision of unlimited or unspecified quantities of alcohol free or for a fixed or discounted fee to the public or to a group defined by a particular characteristic in a manner which carries a significant risk of undermining a licensing objective;**
  - (c) Provision of free or discounted alcohol or any other thing as a prize to encourage or reward the purchase and consumption of alcohol over a period of 24 hours or less in a manner which carries significant risk of undermining a licensing objective;**
  - (d) Selling or supplying alcohol in association with promotional posters or flyers on, or in the vicinity of, the premises which can reasonably be considered to condone, encourage or glamorise anti-social behaviour or to refer to the effects of drunkenness in any favourable manner;**
  - (e) Dispensing alcohol directly by one person into the mouth of another (other than where that other person is unable to drink without assistance by reason of disability).**

**Condition 4**

**The responsible person must ensure that free potable water is provided on request to customers where it reasonably available.**

**Condition 5**

- (1) The premises licence holder or club premises certificate holder must ensure that an age verification policy is adopted in respect of the premises in relation to the sale or supply of alcohol**
- (2) The designated premises supervisor in relation to the premises licence must ensure that the supply of alcohol at the premises is carried on in accordance with the age verification policy.**
- (3) The policy must require individuals who appear to the responsible person to be under 18 years of age (or such older age as may be specified in the policy) to produce on request, before being served alcohol, identification bearing their photograph, date of birth and either**
  - (a) a holographic mark, or**
  - (b) an ultraviolet feature**

**Condition 6**

**The responsible person must ensure that:-**

- (a) Where any of the following alcoholic drinks is sold or supplied for consumption on the premises (other than alcoholic drinks sold or supplied having been made up in advance ready for sale or supply in a securely closed container) it is available to customers in the following measures:-**
  - (i) beer or cider: ½ pint;**
  - (ii) gin, rum, vodka or whisky: 25ml or 35 ml; and**
  - (iii) still wine in a glass: 125ml; and**
- (b) These measures are displayed in a menu, price list or other printed material which is available to customers on the premises; and**

- (c) Where a customer does not in relation to a sale of alcohol specify the quantity of alcohol to be sold, the customer is made aware that these measures are available.

**Condition 7**

- (1) A relevant person shall ensure that no alcohol is sold or supplied for consumption on or off the premises for a price, which is less than the permitted price.
- (2) For the purpose of the condition set out in paragraph 1:-
- (a) “duty” is to be construed in accordance with the Alcoholic Liquor Duties Act 1979(6);
- (b) “permitted price” is the price found by applying the formula:-  $P = D + (D \times V)$  where:-
- (i) P is the permitted price,
  - (ii) D is the amount of duty chargeable in relation to the alcohol as if the duty were charged on the date of the sale or supply of the alcohol, and
  - (iii) V is the rate of value added tax chargeable in relation to the alcohol as if the value added tax were charged on the date of the sale or supply of the alcohol;
- (c) “relevant person” means, in relation to premises in respect of which there is in force a premises licence:-
- (i) the holder of the premises licence
  - (ii) the designated premises supervisor (if any) in respect of such a licence, or
  - (iii) the personal licence holder who makes or authorises a supply of alcohol under such a licence;
- (d) “relevant person” means, in relation to premises in respect of which there is in force a club premises certificate, any member or officer of the club present on the premises in a capacity which enables the member or officer to prevent the supply in question; and
- (e) “value added tax” means value added tax charged in accordance with the Value Added Tax Act 1994(7)
- (3) Where the permitted price given by Paragraph (b) of paragraph (2) would (apart from this paragraph) not be a whole number of pennies, the price given by that sub-paragraph shall be taken to be the price actually given by that sub-paragraph rounded up to the nearest penny.
- (4) (1) Sub-paragraph (2) applies where the permitted price given by Paragraph (b) of paragraph (2) on a day (“the first day”) would be different from the permitted price on the next day (“the second day”) as a result of a change to the rate of duty or value added tax.
- (2) The permitted price which would apply on the first day applies to sales or supplies of alcohol which take place before the expiry of the period of 14 days beginning on the second day.

**Annex 2 – Conditions consistent with the Operating Schedule**

**Condition 8**

CCTV cameras installed, internally and externally. Maintained in good working order, in accordance with CCTV Code of Practice. The system to have an incorporated recording facility and recordings to be stored for one calendar month. The CCTV system to be fully operational throughout the hours that the premises are open for licensable activity. Access of the recordings to be made available to Police and Local Authority officers on request.

**Condition 9**

When regulated entertainment, which generates significant noise, is taking place, doors and windows will be kept shut.

**Condition 10**

Reproduced or live music is to be set at a level so as not to be audible at the facade of the nearest residential property.

**Condition 11**

The designated premises supervisor, duty manager or relevant person should assess noise levels on a regular basis, to prevent excessive breakout.

**Condition 12**

All staff to be trained in all aspects of the licensing legislation and in particular under age sales to support the responsibilities of the Designated Premises Supervisor. Training records will be maintained and available for inspection on request of Police and Licensing Officers.

**Condition 13**

No regulated entertainment to take place outdoors.

**Condition 14**

A notice is displayed at the entrance/exit of the premises to remind customers to leave the premises quietly.

**Condition 15**

A noise limiter shall be installed at the premises by a competent person and set to an agreed level acceptable to the Local Authority Environmental Health department. Once installed and set, the limiter will be maintained in good working order.

**Condition 16**

Children are not allowed on the premises after 22:00 (10pm).

**Condition 17**

No licensable activities or consumption of alcohol to take place in any outdoor area after 23:00. No vessels, glasses or bottles to be allowed out in any outside area after 23:00.

**Condition 18**

To assist the Police in tackling drug abuse in the 'night time economy' by incorporating the use of Ion Track swabbing as a condition of entry when requested by Police. Regular swabbing of public areas as agreed with Police.

Annex 3 – Conditions attached after a hearing by the licensing authority

**Condition 19**

With the exception of 10 pre-booked events per annum, booked not less than 14 days in advance, there shall be no Regulated Entertainment in the form of DJs at the premises.

**Condition 20**

With the exception of 10 pre-booked events per annum, booked not less than 14 days in advance, there will be no dedicated dancefloor. For the avoidance of doubt, tables and chairs will not be moved or removed from the ordinary layout of the premises to create a dancefloor in line with this condition.

**Condition 21**

Where a pre-booked event ("the event") involving regulated entertainment is to be held at the premises, the premises licence holder shall complete a written risk assessment at least 48 hours prior to the commencement of the event. A copy of the written risk assessment is to be kept at the premises for inspection by the Police Licensing Team or Responsible Authority officer. If any requirement for additional staffing or door staff (above any requirement already stipulated in these conditions) is identified by the risk assessment, such measures will be implemented.



**Condition 22**

When pre-booked events involving regulated entertainment are taking place on either a Friday or Saturday evening and the premises is to remain open for licensable activities after 23:00 hours there shall be a minimum of four SIA registered door staff on duty from 21:00 until close.

**Condition 23**

Food in the form of substantial table meals will be available to customers until 22:00 hours on Friday and Saturday nights.

**Condition 24**

In the event that a serious assault is committed at the premises (or appears to have been committed), the Premises Licence Holder or Designated Premises Supervisor (DPS) will immediately ensure that:

- (a) The police (and where appropriate, the ambulance service) are called without delay.
- (b) All measures that are reasonably practicable are taken to apprehend any suspects and detain them pending the arrive of the police;
- (c) The crime scene is preserved so as to enable a full forensic investigation to be carried out by the police; and
- (d) Such other measures are taken (as appropriate) to fully protect the safety of all persons on the premises

**Condition 25**

The Premises Licence Holder shall ensure that any patrons drinking and/or smoking outside the premises do so in an orderly manner and are supervised by staff so as to ensure there is no public nuisance or obstruction of the highway.

**Condition 26**

Non-intoxicating beverages, including drinking water, shall be available in all parts of the premises where alcohol is sold or supplied for consumption on the premises.

**Condition 27**

All persons entering or re-entering the premises via the front door after 22:00 on a Friday and Saturday night shall be subject to a search policy and monitored by the premises CCTV system.

**Condition 28**

All SIA staff engaged outside the entrance to the premises shall wear high visibility yellow jackets or vests.

**Condition 29**

An incident log shall be kept at the premises, and made available on request to an authorised officer of the Council or the Police. It must be completed within 24 hours of the incident and will record the following:

- (a) All crimes reported to the venue
- (b) All ejections of patrons
- (c) Any complaints received concerning crime and disorder
- (d) Any incidents of disorder
- (e) All seizures of drugs or offensive weapons
- (f) Any faults in the CCTV system, searching equipment or scanning equipment
- (g) Any refusal of the sale of alcohol
- (h) Any visit by a relevant authority or emergency service

The incident log shall be provided to the Business Development Manager on a weekly basis.

**Condition 30**

A direct telephone number for the duty manager at the premises shall be available at all times the premises is open for licensable activities. This telephone number is to be made available to residents and businesses in the vicinity.

**Condition 31**

There shall be a personal licence holder on duty on the premises from 6pm daily

**Condition 32**

The Premises Licence Holder shall invite the Police Licensing Team to meet once every quarter to discuss any issues pertaining to operation of the premises.

**Condition 33**

On Friday and Saturday nights when the premises is to remain open for licensable activities after 23:00 hours all glassware (including bottles) are to be removed from public areas at 22:00 hours and all drinks are to be served in plastic polycarbonate vessels thereafter.

**Condition 34**

On Friday and Saturday nights when the premises is to remain open for licensable activities after 23:00 hours there shall be a minimum of 4 SIA registered door staff on duty from 21:00 until close. Where the premises is to close at 23:00 or earlier on Friday and Saturday nights then there shall be a minimum of two SIA registered door staff on duty from 21:00 until close.

**Condition 35**

External background music to be turned off at 21:00 (9pm).

**Condition 36**

In the event that the Premises intends to show and advertise any "designated sporting event" (as defined in the Sporting Events Control of Alcohol Act 1985) the premises licence holder shall ensure that:-

- (a) A written risk assessment is completed for the designated sporting event.
- (b) A copy of the written risk assessment is kept at the premises for inspection by the Police Licensing Team or Responsible Authority Officer.
- (c) The DPS acts on the advice of the Police Licensing Team or Responsible Authority Officers in relation to suggested amendments to the written risk at the premises for inspection by the Police Licensing Team or Responsible Authority Officer; and
- (d) SIA door supervisors are engaged on a risk assessed basis in accordance with the written risk assessment.

**Condition 37**

A Challenge 25 proof of age scheme shall be operated at the premises where the only acceptable forms of identification are recognised photographic identification cards, such as a driving licence, passport or proof of age card with the PASS Hologram.

Annex 4 – Plans

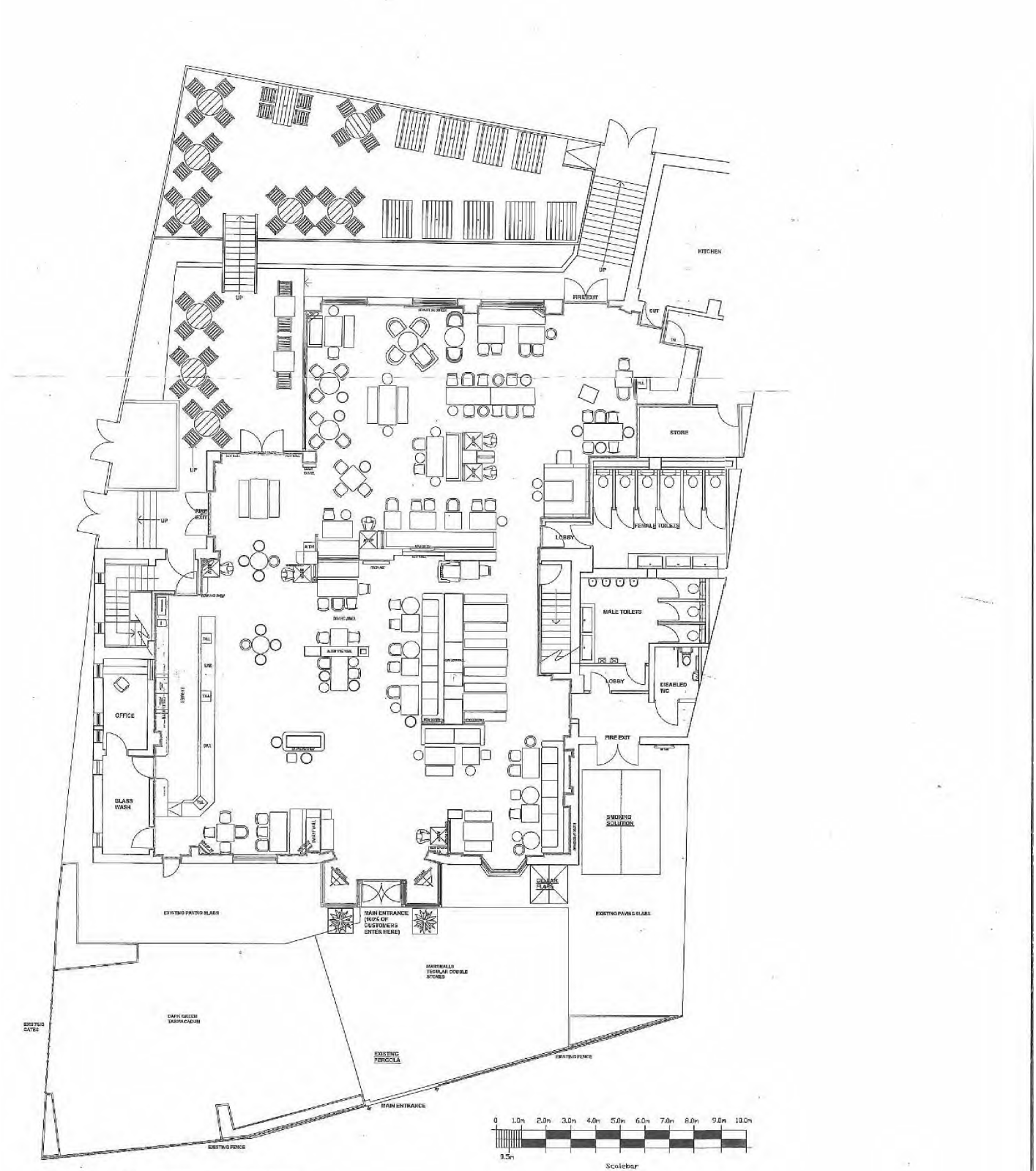

GROUND FLOOR LAYOUT AS PROPOSED.

TOTAL PROPOSED COVERS: 203

PROPOSED EDA: 302

1. ANY ALTERATIONS TO THE EXISTING FIRE ALARM SYSTEM TO BE DESIGNED & INSTALLED TO BS5839 PT 1.
2. ANY NEW FIRE SIGNAGE TO BE IN ACCORDANCE WITH BS5499 PT 1.
3. ANY ALTERATIONS TO THE EMERGENCY LIGHTING TO BE DESIGNED & INSTALLED IN ACCORDANCE WITH BS5266 PT 1.