

- LEGEND - EXISTING**
- Site of Special Scientific Interest (SSSI)
 - Oil pipeline and 6m easement
 - High pressure gas main
 - Ditch to be retained
 - Culvert to be retained
- LEGEND - PROPOSED**
- Asphalt carriageway
 - Carriageway overrun area
 - Traffic island
 - Footway
 - Footway - shared
 - Footway - cycleway
 - Highway verge with grass, shrubs and trees
 - Grasscrete
 - Attenuation Feature
 - Earthwork embankment/cutting with 1:3 gradient
 - Vehicle crossover
 - Tactile blister paving for controlled crossing
 - Tactile blister paving for uncontrolled crossing
 - Tactile ladder paving
 - Tactile tramline paving
 - Kerb
 - Dropped and transition kerbs
 - Splayed Kerb
 - Edging kerb
 - Road marking - white
 - Road marking - yellow
 - Road marking - aluminium studs to 1055.1
 - Guard rail
 - Vehicle Restraint System (VRS)
 - Culvert, headwall and drainage connection
 - Retaining wall
 - Bus shelter
 - Bus stop
 - Bollard - plain face
 - Bollard - reflective
 - Belisha beacon
 - Traffic signal
 - Traffic sign (remain/proposed/relocated)
 - Externally illuminated sign
 - Road name plate (remain/proposed/relocated)
 - Lighting column
 - Land cut-off drain
 - Realigned ditch basin
 - Realigned ditch bank

- NOTES**
- All dimensions are in metres unless otherwise specified.
 - Do not scale from this drawing.
 - Background survey information supplied by SDS surveys (dated Jun 2019 - Aug 2021), Greenhatch Group (Jul 2020), JLP Surveys (Mar 2016). For full survey details see original survey drawings.
 - For sheet layout see dwg 006804-PCL-HGN-ZZ-DR-WM-0003

Rev	Date	Description	Drn	Chk	App
P02	28/06/2022	RATCLIFFE HIGHWAY BELLMOUTH DESIGN AMENDED	SM	IG	KL
P01	07/04/2022	DESIGN FREEZE 1	SM	IG	AZ



Client: **Medway**

Project: **MEDWAY HIF HOO PENINSULA PHASE 2 - UPCHAT RBT, NEW RELIEF RD & MAIN RD HOO**

Drawing Title: **GENERAL ARRANGEMENT SHEET 1 OF 11**

Drawing Status: **S3 FOR REVIEW AND COMMENT**

Drawn	Designed	Date	Scale	Size
SM	KL	APR 2022	1:500	A1

Drawing No. 006804-PCL-HGN-P2-DR-WM-0001 Rev P02

SAFETY, HEALTH AND ENVIRONMENTAL INFORMATION

In addition to the hazards/risks normally associated with the type of work detailed on this drawing, note the following significant risks and information identified by the designer

CONSTRUCTION

C001 Gas pipeline crosses under road

DEMOLITION

--- No significant hazards

MAINTENANCE & OPERATION

--- No significant hazards

It is assumed that all works be carried out by a competent contractor working to an approved method statement.
Approved by: Yet be reviewed

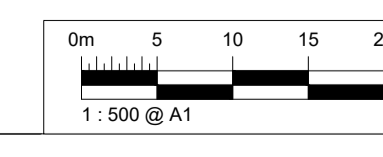

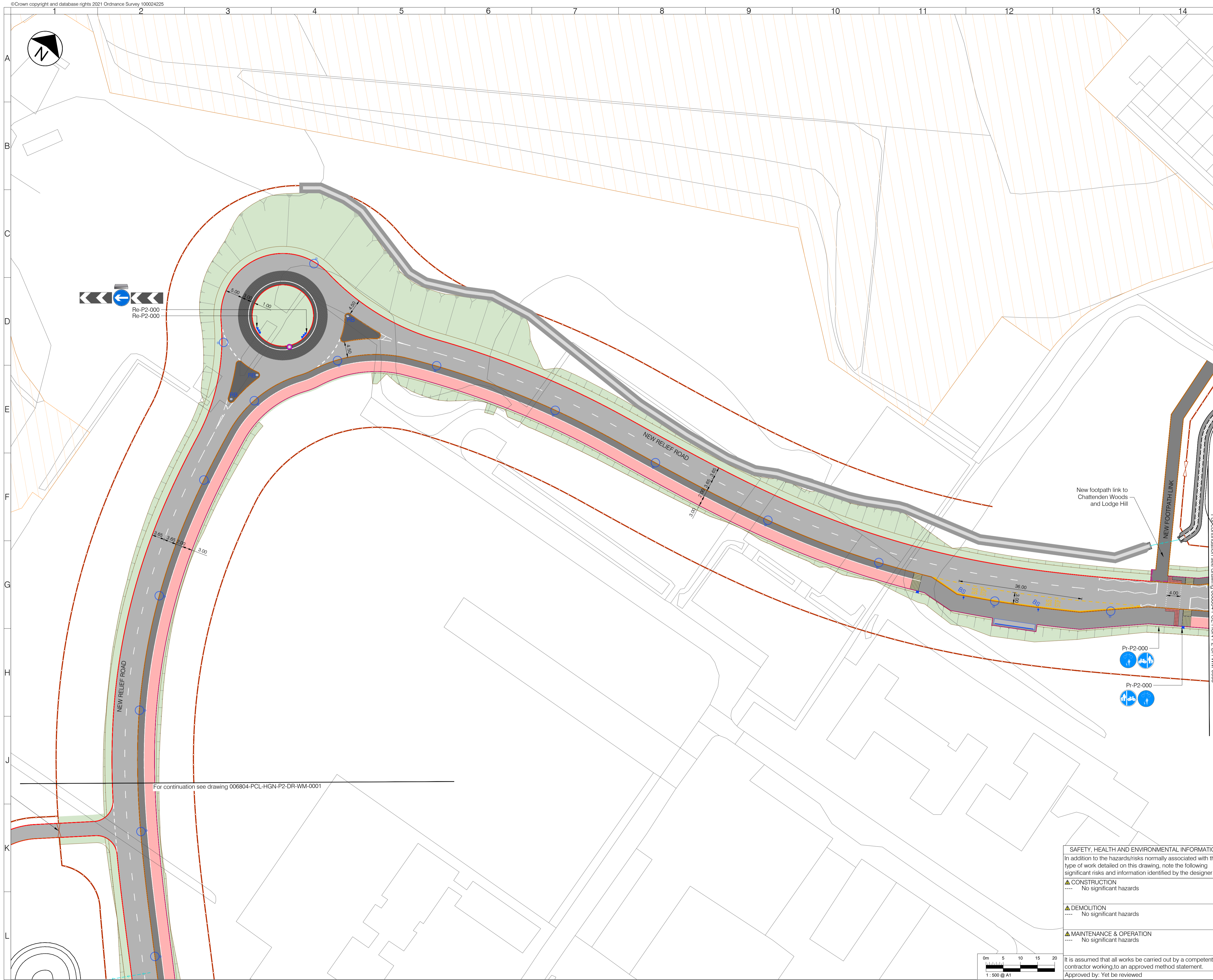

- LEGEND - EXISTING**
- Site of Special Scientific Interest (SSSI)
 - Oil pipeline and 6m easement
 - High pressure gas main
 - Ditch to be retained
 - Culvert to be retained
- LEGEND - PROPOSED**
- Asphalt carriageway
 - Carriageway overrun area
 - Traffic island
 - Footway
 - Footway - shared
 - Footway - cycleway
 - Highway verge with grass, shrubs and trees
 - Grasscrete
 - Attenuation Feature
 - Earthwork embankment/cutting with 1:3 gradient
 - Vehicle crossover
 - Tactile blister paving for controlled crossing
 - Tactile blister paving for uncontrolled crossing
 - Tactile ladder paving
 - Tactile tramline paving
 - Kerb
 - Dropped and transition kerbs
 - Splayed Kerb
 - Edging kerb
 - Road marking - white
 - Road marking - yellow
 - Road marking - aluminium studs to 1055.1
 - Guard rail
 - Vehicle Restraint System (VRS)
 - Culvert, headwall and drainage connection
 - Retaining wall
 - Bus shelter
 - Bus stop
 - Bollard - plain face
 - Bollard - reflective
 - Belisha beacon
 - Traffic sign
 - Traffic sign (remain/proposed/relocated)
 - Externally illuminated sign
 - Road name plate (remain/proposed/relocated)
 - Lighting column
 - Land cut-off drain
 - Realigned ditch basin
 - Realigned ditch bank

- NOTES**
- All dimensions are in metres unless otherwise specified.
 - Do not scale from this drawing.
 - Background survey information supplied by SDS surveys (dated Jun 2019 - Aug 2021), Greenhatch Group (Jul 2020), JLP Surveys (Mar 2016). For full survey details see original survey drawings.
 - For sheet layout see dwg 006804-PCL-HGN-ZZ-DR-WM-0003

Rev	Date	Description	Drm	Chk	App
P02	28/06/2022	RATCLIFFE HIGHWAY BELLMOUTH DESIGN AMENDED	SM	IG	KL
P01	07/04/2022	DESIGN FREEZE 1	SM	IG	AZ



Client: **Medway**

Project: **MEDWAY HIF HOO PENINSULA PHASE 2 - UPCHAT RBT, NEW RELIEF RD & MAIN RD HOO**

Drawing Title: **GENERAL ARRANGEMENT SHEET 2 OF 11**

Drawing Status: **S3 FOR REVIEW AND COMMENT**

Drawn	Designed	Date	Scale	Size
SM	KL	APR 2022	1:500	A1

Drawing No. 006804-PCL-HGN-P2-DR-WM-0002 Rev P02

SAFETY, HEALTH AND ENVIRONMENTAL INFORMATION

In addition to the hazards/risks normally associated with the type of work detailed on this drawing, note the following significant risks and information identified by the designer

- ▲ CONSTRUCTION
--- No significant hazards
- ▲ DEMOLITION
--- No significant hazards
- ▲ MAINTENANCE & OPERATION
--- No significant hazards

It is assumed that all works be carried out by a competent contractor working to an approved method statement.
Approved by: Yet to be reviewed

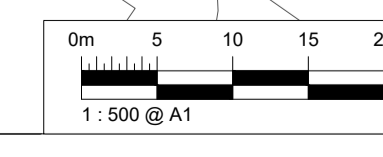

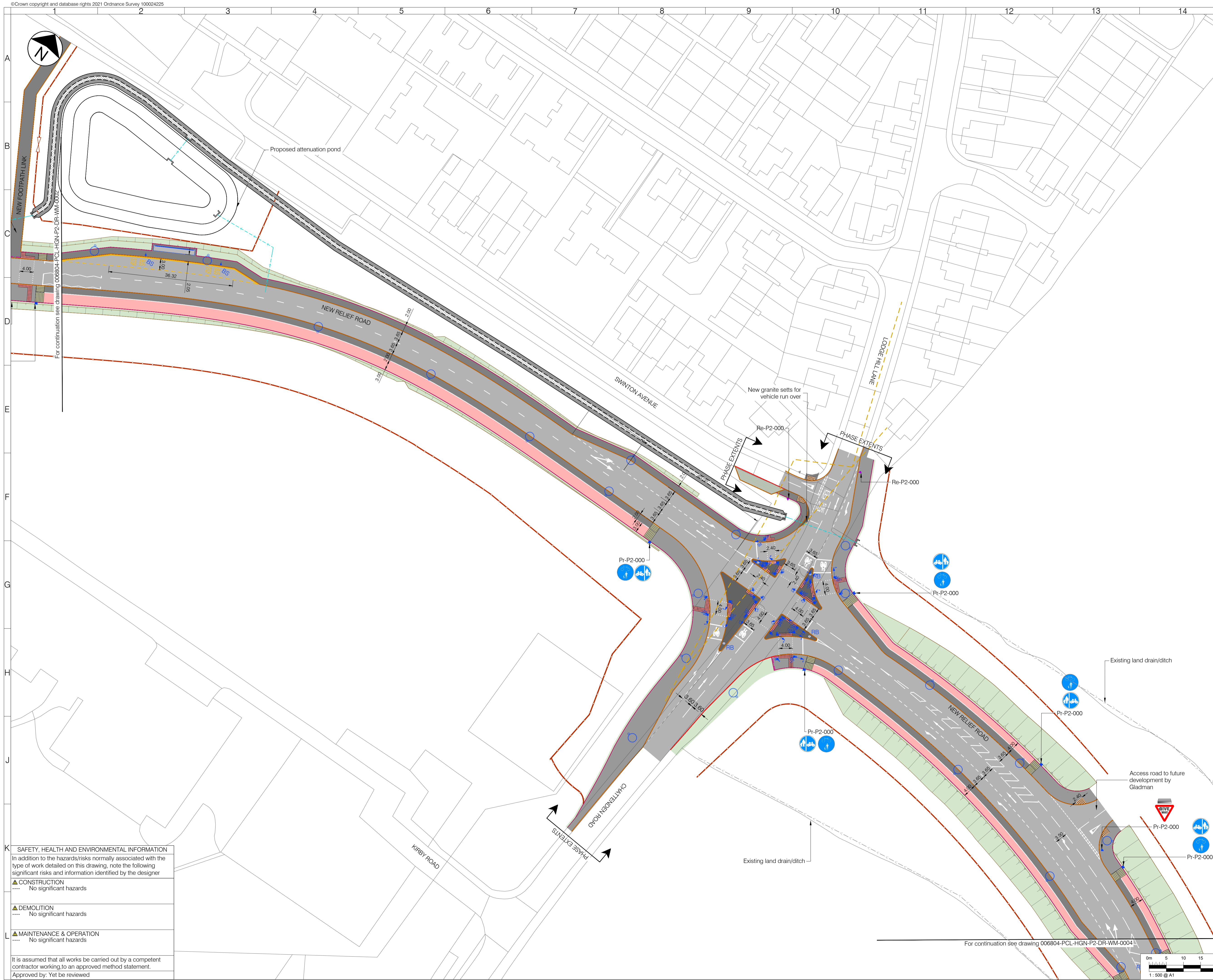

- LEGEND - EXISTING**
- Site of Special Scientific Interest (SSSI)
 - Oil pipeline and 6m easement
 - High pressure gas main
 - Ditch to be retained
 - Culvert to be retained
- LEGEND - PROPOSED**
- Asphalt carriageway
 - Carriageway overrun area
 - Traffic island
 - Footway
 - Footway - shared
 - Footway - cycleway
 - Highway verge with grass, shrubs and trees
 - Grasscrete
 - Attenuation Feature
 - Earthwork embankment/cutting with 1:3 gradient
 - Vehicle crossover
 - Tactile blister paving for controlled crossing
 - Tactile blister paving for uncontrolled crossing
 - Tactile ladder paving
 - Tactile tramline paving
 - Kerb
 - Dropped and transition kerbs
 - Splayed Kerb
 - Edging kerb
 - Road marking - white
 - Road marking - yellow
 - Road marking - aluminium studs to 1055.1
 - Guard rail
 - Vehicle Restraint System (VRS)
 - Culvert, headwall and drainage connection
 - Retaining wall
 - Bus shelter
 - Bus stop
 - Bollard - plain face
 - Bollard - reflective
 - Belisha beacon
 - Traffic signal
 - Traffic sign (remain/proposed/relocated)
 - Externally illuminated sign
 - Road name plate (remain/proposed/relocated)
 - Lighting column
 - Land cut-off drain
 - Realigned ditch basin
 - Realigned ditch bank

- NOTES**
1. All dimensions are in metres unless otherwise specified.
 2. Do not scale from this drawing.
 3. Background survey information supplied by SDS surveys (dated Jun 2019 - Aug 2021), Greenhatch Group (Jul 2020), JLP Surveys (Mar 2016). For full survey details see original survey drawings.
 4. For sheet layout see dwg 006804-PCL-HGN-ZZ-DR-WM-0003

Rev	Date	Description	Drn	Chk	App
P02	28/06/2022	RATCLIFFE HIGHWAY BELLMOUTH DESIGN AMENDED	SM	IG	KL
P01	07/04/2022	DESIGN FREEZE 1	SM	IG	AZ

PROJECT CENTRE

www.marstonholdings.co.uk/projectcentre

Client
Medway

Project
MEDWAY
HIF HOO PENINSULA
PHASE 2 - UPCHAT RBT, NEW RELIEF RD & MAIN RD HOO

Drawing Title
GENERAL ARRANGEMENT
SHEET 3 OF 11

Drawing Status
S3 FOR REVIEW AND COMMENT

Drawn	Designed	Date	Scale	Size
SM	KL	APR 2022	1:500	A1

Drawing No.
006804-PCL-HGN-P2-DR-WM-0003

Rev
P02

SAFETY, HEALTH AND ENVIRONMENTAL INFORMATION

In addition to the hazards/risks normally associated with the type of work detailed on this drawing, note the following significant risks and information identified by the designer

CONSTRUCTION
No significant hazards

DEMOLITION
No significant hazards

MAINTENANCE & OPERATION
No significant hazards

It is assumed that all works be carried out by a competent contractor working to an approved method statement.
Approved by: Yet to be reviewed

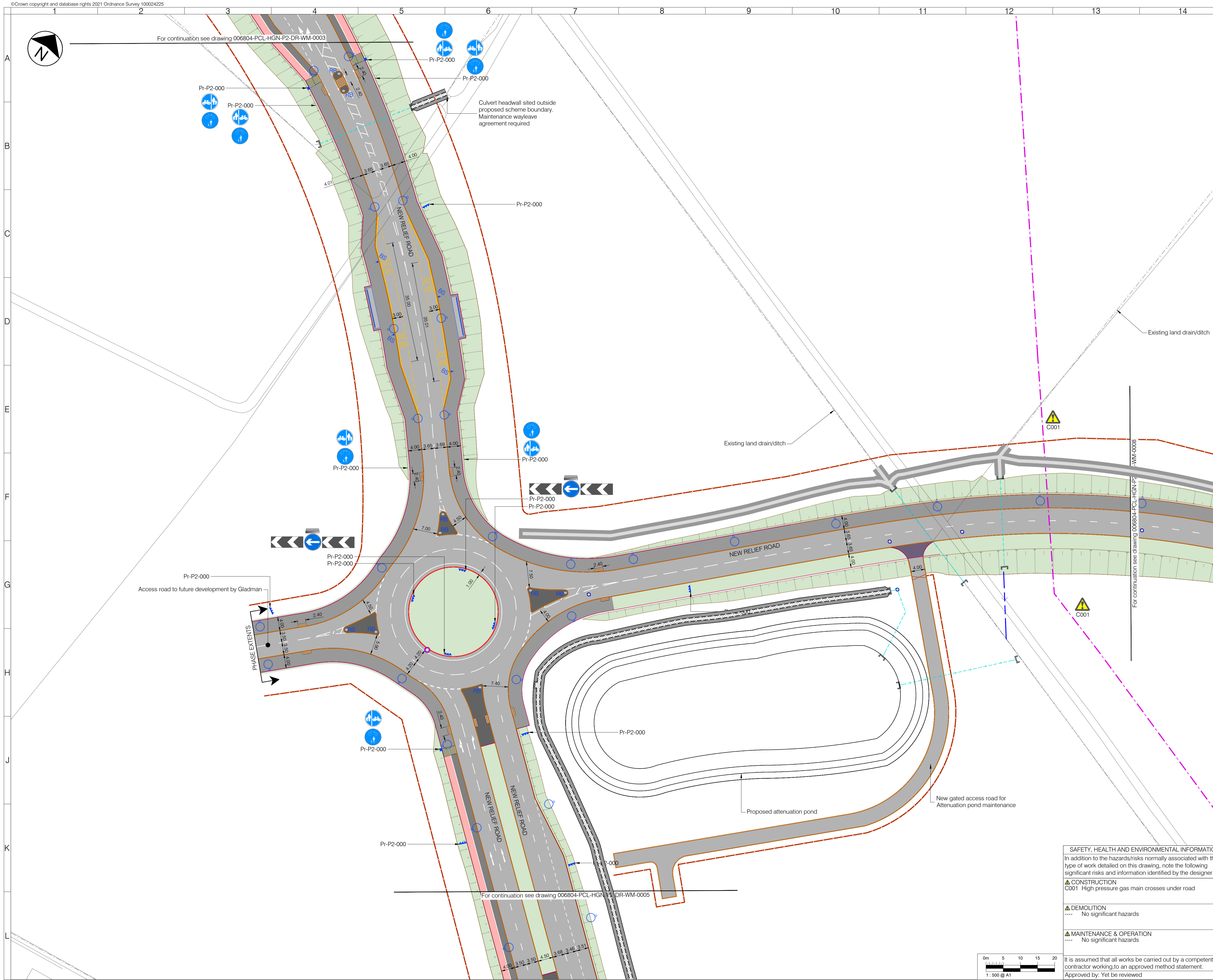

LEGEND - EXISTING

- Site of Special Scientific Interest (SSSI)
- Oil pipeline and 6m easement
- High pressure gas main
- Ditch to be retained
- Culvert to be retained

LEGEND - PROPOSED

- Asphalt carriageway
- Carriageway overrun area
- Traffic island
- Footway
- Footway - shared
- Footway - cycleway
- Highway verge with grass, shrubs and trees
- Grasscrete
- Attenuation Feature
- Earthwork embankment/cutting with 1:3 gradient
- Vehicle crossover
- Tactile blister paving for controlled crossing
- Tactile blister paving for uncontrolled crossing
- Tactile ladder paving
- Tactile tramline paving
- Kerb
- Dropped and transition kerbs
- Splayed Kerb
- Edging kerb
- Road marking - white
- Road marking - yellow
- Road marking - aluminium studs to 1055.1
- Guard rail
- Vehicle Restraint System (VRS)
- Culvert, headwall and drainage connection
- Retaining wall
- Bus shelter
- Bus stop
- Bollard - plain face
- Bollard - reflective
- Belisha beacon
- Traffic signal
- Traffic sign (remain/proposed/relocated)
- Externally illuminated sign
- Road name plate (remain/proposed/relocated)
- Lighting column
- Land cut-off drain
- Realigned ditch basin
- Realigned ditch bank

- NOTES**
- All dimensions are in metres unless otherwise specified.
 - Do not scale from this drawing.
 - Background survey information supplied by SDS surveys (dated Jun 2019 - Aug 2021), Greenhatch Group (Jul 2020), JLP Surveys (Mar 2016). For full survey details see original survey drawings.
 - For sheet layout see dwg 006804-PCL-HGN-ZZ-DR-WM-0003

P02	28/06/2022	RATCLIFFE HIGHWAY BELLMOUTH DESIGN AMENDED	SM	IG	KL
P01	07/04/2022	DESIGN FREEZE 1	SM	IG	AZ
Rev	Date	Description	Drm	Chk	App



Client: **Medway**

Project: **MEDWAY HIF HOO PENINSULA PHASE 2 - UPCHAT RBT, NEW RELIEF RD & MAIN RD HOO**

Drawing Title: **GENERAL ARRANGEMENT SHEET 4 OF 11**

Drawing Status: **S3 FOR REVIEW AND COMMENT**

Drawn	Designed	Date	Scale	Size
SM	KL	APR 2022	1:500	A1

Drawing No. 006804-PCL-HGN-P2-DR-WM-0004 Rev P02

SAFETY, HEALTH AND ENVIRONMENTAL INFORMATION

In addition to the hazards/risks normally associated with the type of work detailed on this drawing, note the following significant risks and information identified by the designer

- ▲ CONSTRUCTION
C001 High pressure gas main crosses under road
- ▲ DEMOLITION
--- No significant hazards
- ▲ MAINTENANCE & OPERATION
--- No significant hazards

It is assumed that all works be carried out by a competent contractor working to an approved method statement.
Approved by: Yet to be reviewed

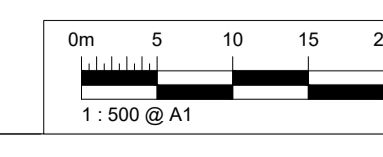

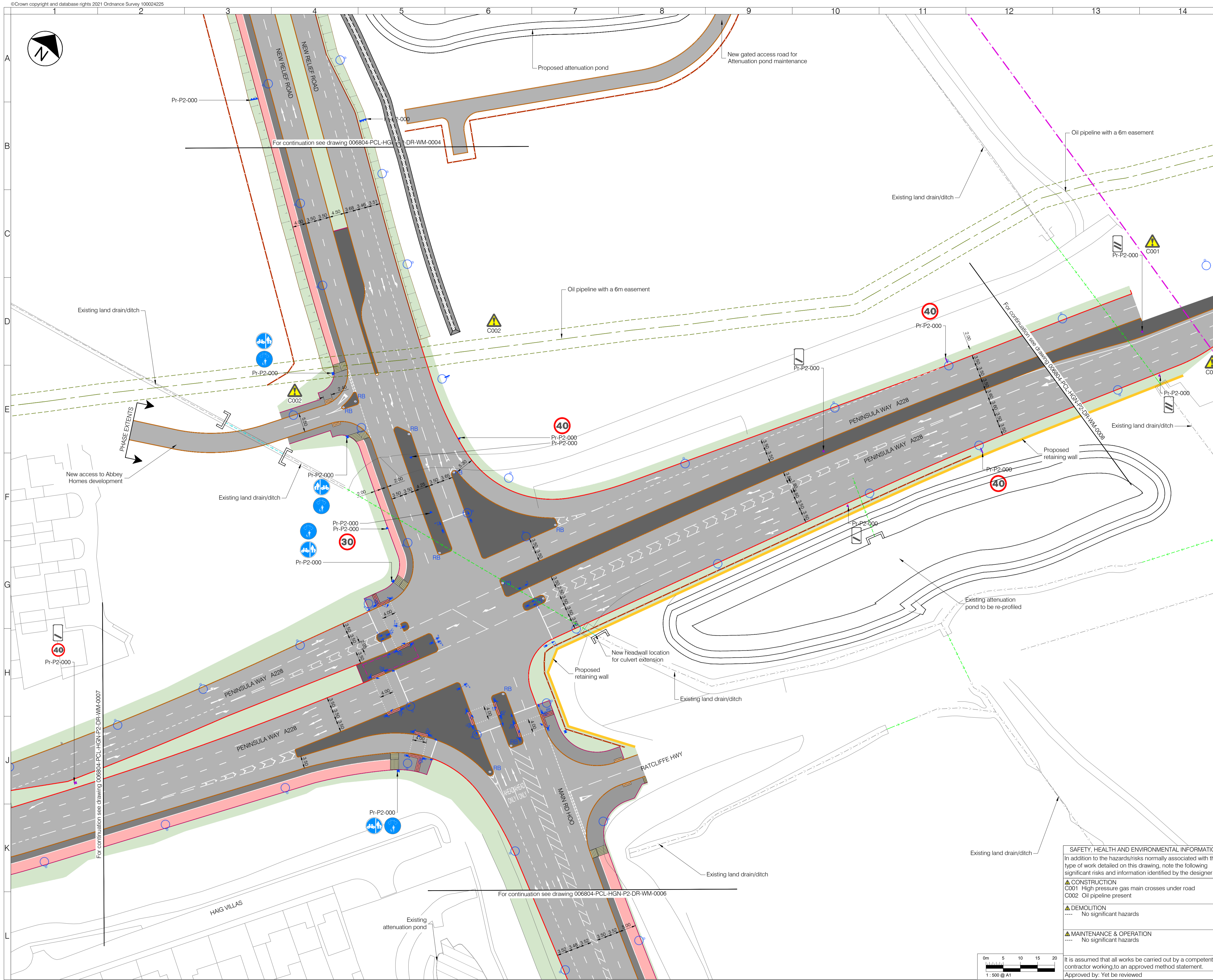

LEGEND - EXISTING

- Site of Special Scientific Interest (SSSI)
- Oil pipeline and 6m easement
- High pressure gas main
- Ditch to be retained
- Culvert to be retained

LEGEND - PROPOSED

- Asphalt carriageway
- Carriageway overrun area
- Traffic island
- Footway
- Footway - shared
- Footway - cycleway
- Highway verge with grass, shrubs and trees
- Grasscrete
- Attenuation Feature
- Earthwork embankment/cutting with 1:3 gradient
- Vehicle crossover
- Tactile blister paving for controlled crossing
- Tactile blister paving for uncontrolled crossing
- Tactile ladder paving
- Tactile tramline paving
- Kerb
- Dropped and transition kerbs
- Splayed Kerb
- Edging kerb
- Road marking - white
- Road marking - yellow
- Road marking - aluminium studs to 1055.1
- Guard rail
- Vehicle Restraint System (VRS)
- Culvert, headwall and drainage connection
- Retaining wall
- Bus shelter
- Bus stop
- Bollard - plain face
- Bollard - reflective
- Belisha beacon
- Traffic sign
- Traffic sign (remain/proposed/relocated)
- Externally illuminated sign
- Road name plate (remain/proposed/relocated)
- Lighting column
- Land cut-off drain
- Realigned ditch basin
- Realigned ditch bank

- NOTES**
- All dimensions are in metres unless otherwise specified.
 - Do not scale from this drawing.
 - Background survey information supplied by SDS surveys (dated Jun 2019 - Aug 2021), Greenhatch Group (Jul 2020), JLP Surveys (Mar 2016). For full survey details see original survey drawings.
 - For sheet layout see dwg 006804-PCL-HGN-ZZ-DR-WM-0003

Rev	Date	Description	Drn	Chk	App
P02	28/06/2022	RATCLIFFE HIGHWAY BELLMOUTH DESIGN AMENDED	SM	IG	KL
P01	07/04/2022	DESIGN FREEZE 1	SM	IG	AZ

PROJECT CENTRE
www.marstonholdings.co.uk/projectcentre

Client: **Medway**

Project: **MEDWAY HIF HOO PENINSULA PHASE 2 - UPCHAT RBT, NEW RELIEF RD & MAIN RD HOO**

Drawing Title: **GENERAL ARRANGEMENT SHEET 5 OF 11**

Drawing Status: **S3 FOR REVIEW AND COMMENT**

Drawn	Designed	Date	Scale	Size
SM	KL	APR 2022	1:500	A1

Drawing No. 006804-PCL-HGN-P2-DR-WM-0005 Rev P02

SAFETY, HEALTH AND ENVIRONMENTAL INFORMATION

In addition to the hazards/risks normally associated with the type of work detailed on this drawing, note the following significant risks and information identified by the designer

- CONSTRUCTION**
 - C001 High pressure gas main crosses under road
 - C002 Oil pipeline present
- DEMOLITION**
 - No significant hazards
- MAINTENANCE & OPERATION**
 - No significant hazards

It is assumed that all works be carried out by a competent contractor working to an approved method statement.
Approved by: Yet to be reviewed

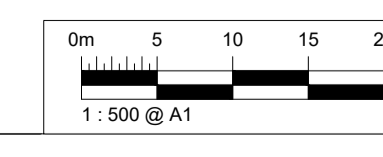



LEGEND - EXISTING

- Site of Special Scientific Interest (SSSI)
- Oil pipeline and 6m easement
- High pressure gas main
- Ditch to be retained
- Culvert to be retained

LEGEND - PROPOSED

- Asphalt carriageway
- Carriageway overrun area
- Traffic island
- Footway
- Footway - shared
- Footway - cycleway
- Highway verge with grass, shrubs and trees
- Grasscrete
- Attenuation Feature
- Earthwork embankment/cutting with 1:3 gradient
- Vehicle crossover
- Tactile blister paving for controlled crossing
- Tactile blister paving for uncontrolled crossing
- Tactile ladder paving
- Tactile tramline paving
- Kerb
- Dropped and transition kerbs
- Splayed Kerb
- Edging kerb
- Road marking - white
- Road marking - yellow
- Road marking - aluminium studs to 1055.1
- Guard rail
- Vehicle Restraint System (VRS)
- Culvert, headwall and drainage connection
- Retaining wall
- Bus shelter
- Bus stop
- Bollard - plain face
- Bollard - reflective
- Belisha beacon
- Traffic sign
- Traffic sign (remain/proposed/relocated)
- Externally illuminated sign
- Road name plate (remain/proposed/relocated)
- Lighting column
- Land cut-off drain
- Realigned ditch basin
- Realigned ditch bank

- NOTES**
- All dimensions are in metres unless otherwise specified.
 - Do not scale from this drawing.
 - Background survey information supplied by SDS surveys (dated Jun 2019 - Aug 2021), Greenhatch Group (Jul 2020), JLP Surveys (Mar 2016). For full survey details see original survey drawings.
 - For sheet layout see dwg 006804-PCL-HGN-ZZ-DR-WM-0003

Rev	Date	Description	Drn	Chk	App
P02	28/06/2022	RATCLIFFE HIGHWAY BELLMOUTH DESIGN AMENDED	SM	IG	KL
P01	07/04/2022	DESIGN FREEZE 1	SM	IG	AZ



Client: **Medway**

Project: **MEDWAY HIF HOO PENINSULA PHASE 2 - UPCHAT RBT, NEW RELIEF RD & MAIN RD HOO**

Drawing Title: **GENERAL ARRANGEMENT SHEET 6 OF 11**

Drawing Status: **S3 FOR REVIEW AND COMMENT**

Drawn	Designed	Date	Scale	Size
SM	KL	APR 2022	1:500	A1

Drawing No. 006804-PCL-HGN-P2-DR-WM-0006 Rev P02

SAFETY, HEALTH AND ENVIRONMENTAL INFORMATION

In addition to the hazards/risks normally associated with the type of work detailed on this drawing, note the following significant risks and information identified by the designer

▲ CONSTRUCTION
 ---- No significant hazards

▲ DEMOLITION
 ---- No significant hazards

▲ MAINTENANCE & OPERATION
 ---- No significant hazards

It is assumed that all works be carried out by a competent contractor working to an approved method statement.
 Approved by: Yet be reviewed

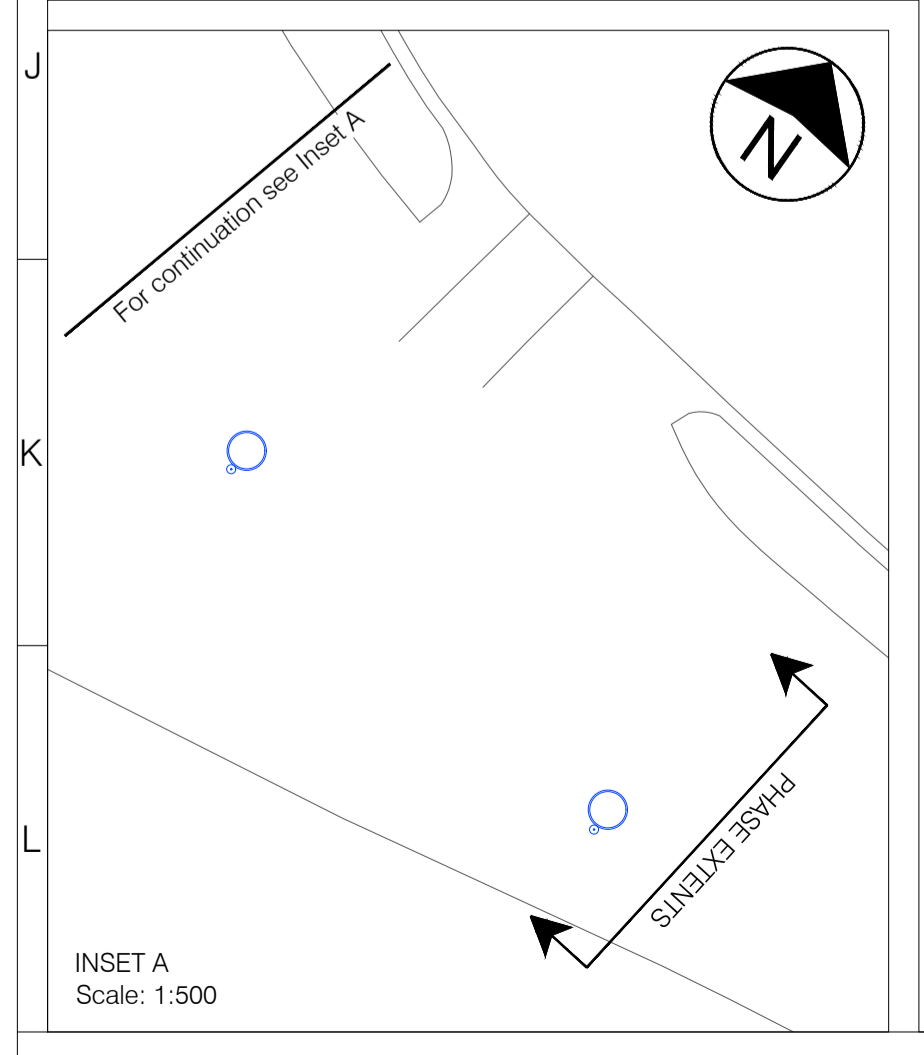
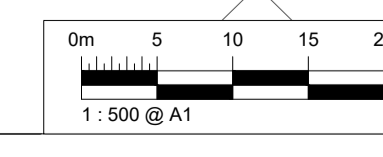

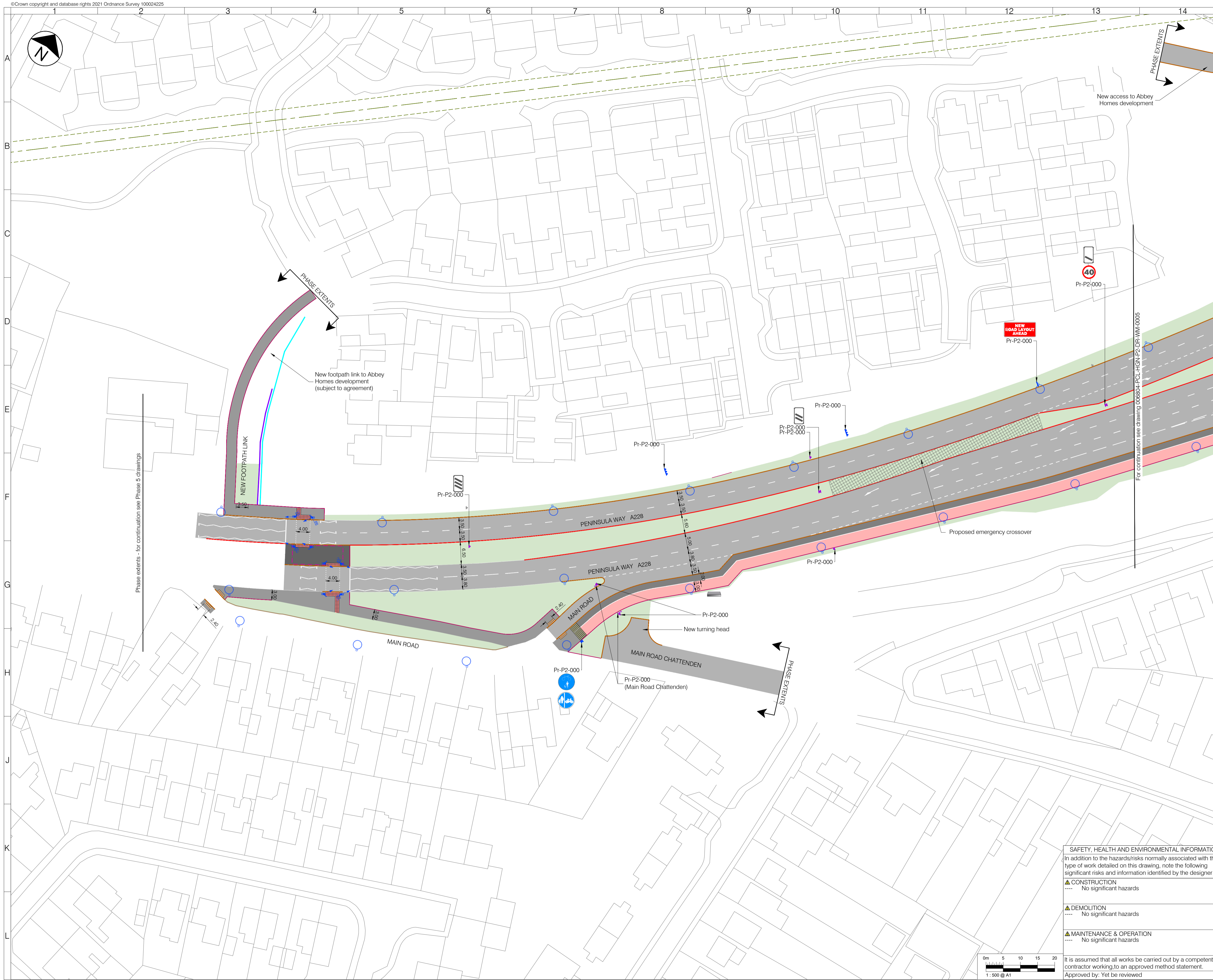

- LEGEND - EXISTING**
- Site of Special Scientific Interest (SSSI)
 - Oil pipeline and 6m easement
 - High pressure gas main
 - Ditch to be retained
 - Culvert to be retained
- LEGEND - PROPOSED**
- Asphalt carriageway
 - Carriageway overrun area
 - Traffic island
 - Footway
 - Footway - shared
 - Footway - cycleway
 - Highway verge with grass, shrubs and trees
 - Grasscrete
 - Attenuation Feature
 - Earthwork embankment/cutting with 1:3 gradient
 - Vehicle crossover
 - Tactile blister paving for controlled crossing
 - Tactile blister paving for uncontrolled crossing
 - Tactile ladder paving
 - Tactile tramline paving
 - Kerb
 - Dropped and transition kerbs
 - Splayed Kerb
 - Edging kerb
 - Road marking - white
 - Road marking - yellow
 - Road marking - aluminium studs to 1055.1
 - Guard rail
 - Vehicle Restraint System (VRS)
 - Culvert, headwall and drainage connection
 - Retaining wall
 - Bus shelter
 - Bus stop
 - Bollard - plain face
 - Bollard - reflective
 - Bellsha beacon
 - Traffic signal
 - Traffic sign (remain/proposed/relocated)
 - Externally illuminated sign
 - Road name plate (remain/proposed/relocated)
 - Lighting column
 - Land cut-off drain
 - Realigned ditch basin
 - Realigned ditch bank

- NOTES**
- All dimensions are in metres unless otherwise specified.
 - Do not scale from this drawing.
 - Background survey information supplied by SDS surveys (dated Jun 2019 - Aug 2021), Greenhatch Group (Jul 2020), JLP Surveys (Mar 2016). For full survey details see original survey drawings.
 - For sheet layout see dwg 006804-PCL-HGN-ZZ-DR-WM-0003

Rev	Date	Description	Drm	Chk	App
P02	28/06/2022	RATCLIFFE HIGHWAY BELLMOUTH DESIGN APPROVED	SM	IG	KL
P01	07/04/2022	DESIGN FREEZE 1	SM	IG	AZ

PROJECT CENTRE
www.marstonholdings.co.uk/projectcentre

Client: **Medway**

Project: **MEDWAY HIF HOO PENINSULA PHASE 2 - UPCHAT RBT, NEW RELIEF RD & MAIN RD HOO**

Drawing Title: **GENERAL ARRANGEMENT SHEET 7 OF 11**

Drawing Status: **S3 FOR REVIEW AND COMMENT**

Drawn	Designed	Date	Scale	Size
SM	KL	APR 2022	1:500	A1

Drawing No. 006804-PCL-HGN-P2-DR-WM-0007 Rev P02

SAFETY, HEALTH AND ENVIRONMENTAL INFORMATION

In addition to the hazards/risks normally associated with the type of work detailed on this drawing, note the following significant risks and information identified by the designer

▲ CONSTRUCTION
--- No significant hazards

▲ DEMOLITION
--- No significant hazards

▲ MAINTENANCE & OPERATION
--- No significant hazards

It is assumed that all works be carried out by a competent contractor working to an approved method statement.
Approved by: Yet to be reviewed

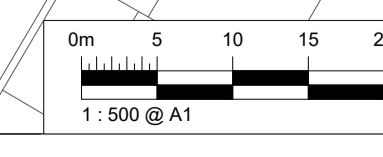

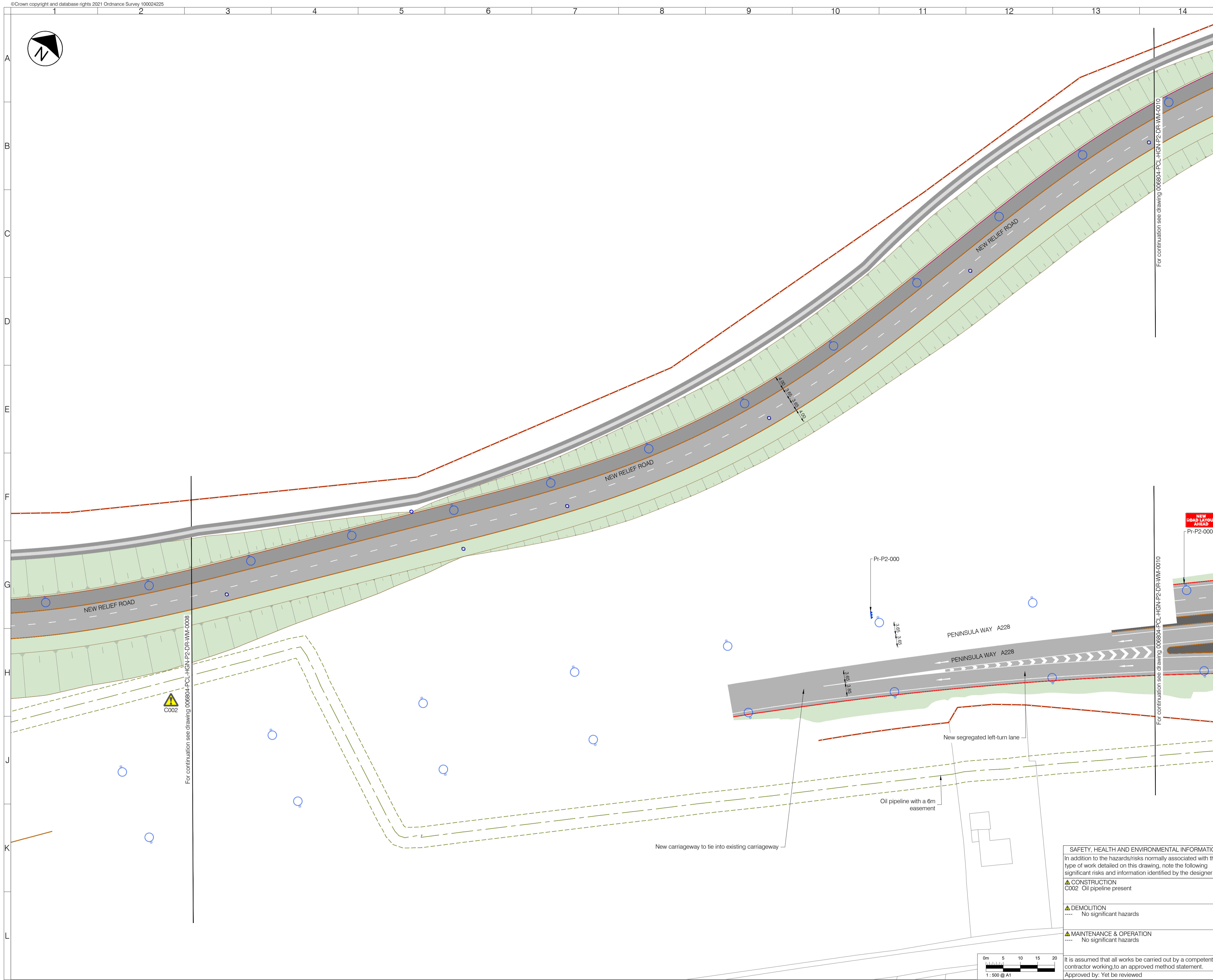

- LEGEND - EXISTING**
- Site of Special Scientific Interest (SSSI)
 - Oil pipeline and 6m easement
 - High pressure gas main
 - Ditch to be retained
 - Culvert to be retained
- LEGEND - PROPOSED**
- Asphalt carriageway
 - Carriageway overrun area
 - Traffic island
 - Footway
 - Footway - shared
 - Footway - cycleway
 - Highway verge with grass, shrubs and trees
 - Grasscrete
 - Attenuation Feature
 - Earthwork embankment/cutting with 1:3 gradient
 - Vehicle crossover
 - Tactile blister paving for controlled crossing
 - Tactile blister paving for uncontrolled crossing
 - Tactile ladder paving
 - Tactile tramline paving
 - Kerb
 - Dropped and transition kerbs
 - Splayed Kerb
 - Edging kerb
 - Road marking - white
 - Road marking - yellow
 - Road marking - aluminium studs to 1055.1
 - Guard rail
 - Vehicle Restraint System (VRS)
 - Culvert, headwall and drainage connection
 - Retaining wall
 - Bus shelter
 - Bus stop
 - Bollard - plain face
 - Bollard - reflective
 - Belisha beacon
 - Traffic sign
 - Traffic sign (remain/proposed/relocated)
 - Externally illuminated sign
 - Road name plate (remain/proposed/relocated)
 - Lighting column
 - Land cut-off drain
 - Realigned ditch basin
 - Realigned ditch bank

- NOTES**
- All dimensions are in metres unless otherwise specified.
 - Do not scale from this drawing.
 - Background survey information supplied by SDS surveys (dated Jun 2019 - Aug 2021), Greenhatch Group (Jul 2020), JLP Surveys (Mar 2016). For full survey details see original survey drawings.
 - For sheet layout see dwg 006804-PCL-HGN-ZZ-DR-WM-0003

Rev	Date	Description	Drn	Chk	App
P02	28/06/2022	RATCLIFFE HIGHWAY BELLMOUTH DESIGN AMENDED	SM	IG	KL
P01	07/04/2022	DESIGN FREEZE 1	SM	IG	AZ



Client
Medway

Project
MEDWAY
HIF HOO PENINSULA
PHASE 2 - UPCHAT RBT, NEW RELIEF RD & MAIN RD HOO

Drawing Title
GENERAL ARRANGEMENT
SHEET 9 OF 11

Drawing Status
S3 FOR REVIEW AND COMMENT

Drawn	Designed	Date	Scale	Size
SM	KL	APR 2022	1:500	A1

Drawing No.
006804-PCL-HGN-P2-DR-WM-0009

Rev
P02

SAFETY, HEALTH AND ENVIRONMENTAL INFORMATION

In addition to the hazards/risks normally associated with the type of work detailed on this drawing, note the following significant risks and information identified by the designer

CONSTRUCTION

▲ C002 Oil pipeline present

DEMOLITION

--- No significant hazards

MAINTENANCE & OPERATION

--- No significant hazards

It is assumed that all works be carried out by a competent contractor working to an approved method statement.
Approved by: Yet be reviewed

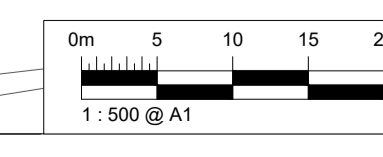

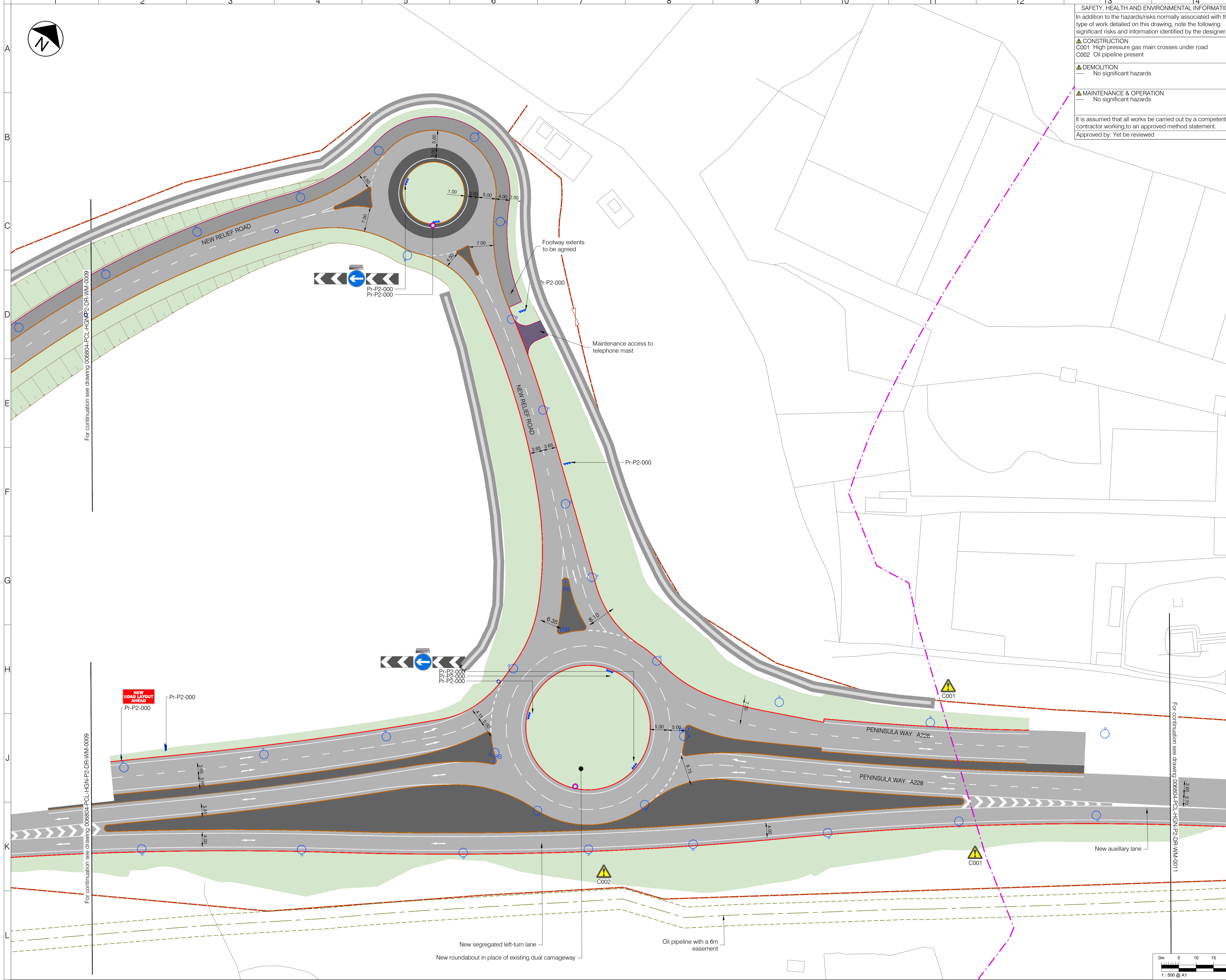

SAFETY, HEALTH AND ENVIRONMENTAL INFORMATION
 In addition to the hazards/risks normally associated with the type of work detailed on this drawing, note the following significant risks and information identified by the designer

CONSTRUCTION
 C001 High pressure gas main crosses under road
 C002 Oil pipeline present

DEMOLITION
 --- No significant hazards

MAINTENANCE & OPERATION
 --- No significant hazards

It is assumed that all works be carried out by a competent contractor working to an approved method statement.
 Approved by: Yet to be reviewed

- LEGEND - EXISTING**
- Site of Special Scientific Interest (SSSI)
 - Oil pipeline and 6m easement
 - High pressure gas main
 - Ditch to be retained
 - Culvert to be retained
 - Oil pipeline present
- LEGEND - PROPOSED**
- Asphalt carriageway
 - Carriageway overrun area
 - Traffic island
 - Footway
 - Footway - shared
 - Footway - cycleway
 - Highway verge with grass, shrubs and trees
 - Grasscrete
 - Attenuation Feature
 - Earthwork embankment/cutting with 1:3 gradient
 - Vehicle crossover
 - Tactile blister paving for controlled crossing
 - Tactile blister paving for uncontrolled crossing
 - Tactile ladder paving
 - Tactile tramline paving
 - Kerb
 - Dropped and transition kerbs
 - Splayed Kerb
 - Edging kerb
 - Road marking - white
 - Road marking - yellow
 - Road marking - aluminium studs to 1055.1
 - Guard rail
 - Vehicle Restraint System (VRS)
 - Culvert, headwall and drainage connection
 - Retaining wall
 - Bus shelter
 - Bus stop
 - Bollard - plain face
 - Bollard - reflective
 - Belisha beacon
 - Traffic signal
 - Traffic sign (remain/proposed/relocated)
 - Externally illuminated sign
 - Road name plate (remain/proposed/relocated)
 - Lighting column
 - Land cut-off drain
 - Realigned ditch basin
 - Realigned ditch bank

- NOTES**
- All dimensions are in metres unless otherwise specified.
 - Do not scale from this drawing.
 - Background survey information supplied by SDS surveys (dated Jun 2019 - Aug 2021), Greenhatch Group (Jul 2020), JLP Surveys (Mar 2016). For full survey details see original survey drawings.
 - For sheet layout see dwg 006804-PCL-HGN-ZZ-DR-WM-0003

Rev	Date	Description	Drm	Chk	App
P02	28/06/2022	RATCLIFFE HIGHWAY BELLMOUTH DESIGN AMENDED	SM	IG	KL
P01	07/04/2022	DESIGN FREEZE 1	SM	IG	AZ



Client: **Medway**

Project: **MEDWAY HIF HOO PENINSULA PHASE 2 - UPCHAT RBT, NEW RELIEF RD & MAIN RD HOO**

Drawing Title: **GENERAL ARRANGEMENT SHEET 10 OF 11**

Drawing Status: **S3 FOR REVIEW AND COMMENT**

Drawn	Designed	Date	Scale	Size
SM	KL	APR 2022	1:500	A1

Drawing No. 006804-PCL-HGN-P2-DR-WM-0010 Rev P02

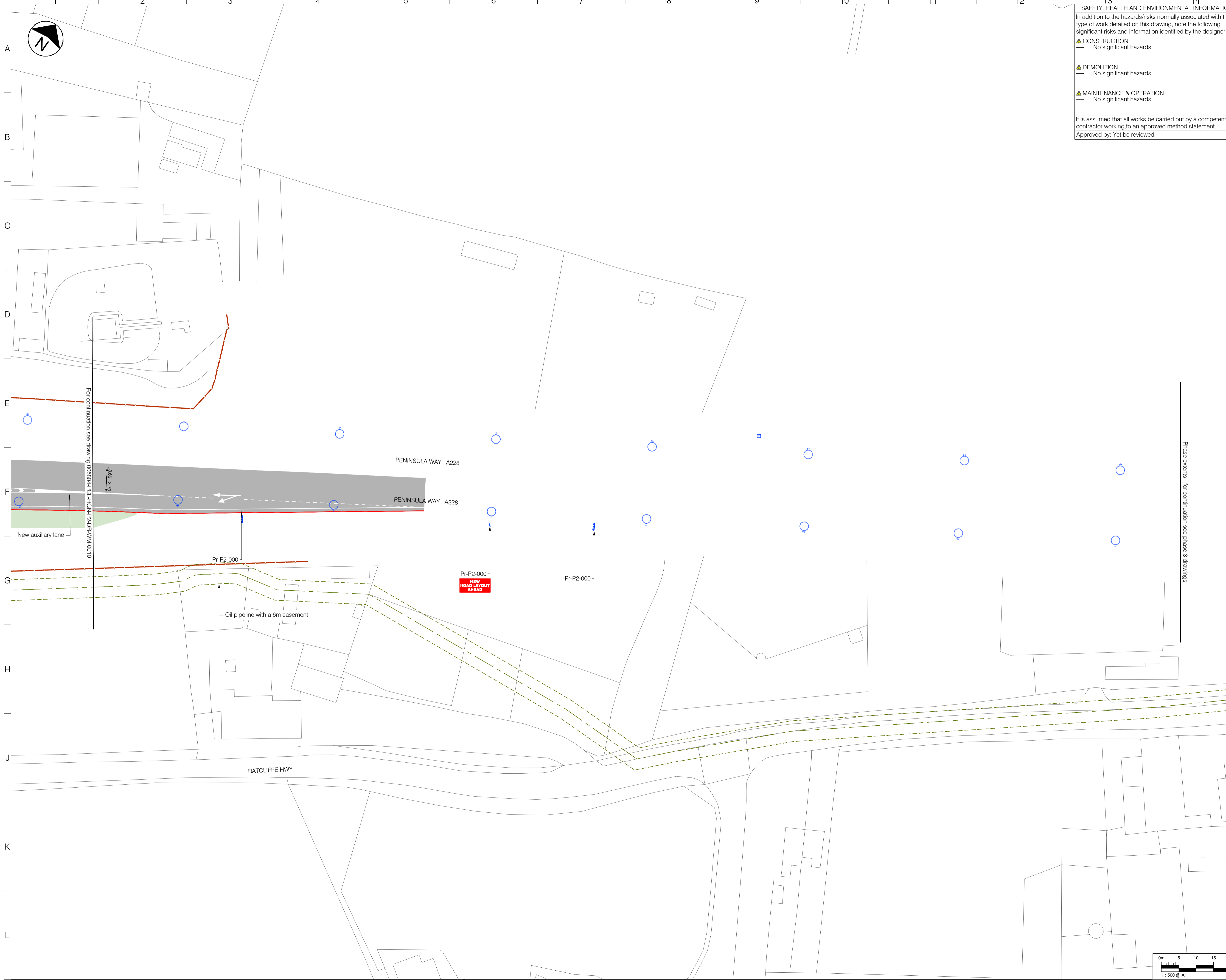

SAFETY, HEALTH AND ENVIRONMENTAL INFORMATION
 In addition to the hazards/risks normally associated with the type of work detailed on this drawing, note the following significant risks and information identified by the designer

▲ CONSTRUCTION
 ---- No significant hazards

▲ DEMOLITION
 ---- No significant hazards

▲ MAINTENANCE & OPERATION
 ---- No significant hazards

It is assumed that all works be carried out by a competent contractor working to an approved method statement.
 Approved by: Yet be reviewed

- LEGEND - EXISTING**
- Site of Special Scientific Interest (SSSI)
 - Oil pipeline and 6m easement
 - High pressure gas main
 - Ditch to be retained
 - Culvert to be retained
- LEGEND - PROPOSED**
- Asphalt carriageway
 - Carriageway overrun area
 - Traffic island
 - Footway
 - Footway - shared
 - Footway - cycleway
 - Highway verge with grass, shrubs and trees
 - Grasscrete
 - Attenuation Feature
 - Earthwork embankment/cutting with 1:3 gradient
 - Vehicle crossover
 - Tactile blister paving for controlled crossing
 - Tactile blister paving for uncontrolled crossing
 - Tactile ladder paving
 - Tactile tramline paving
 - Kerb
 - Dropped and transition kerbs
 - Splayed Kerb
 - Edging kerb
 - Road marking - white
 - Road marking - yellow
 - Road marking - aluminium studs to 1055.1
 - Guard rail
 - Vehicle Restraint System (VRS)
 - Culvert, headwall and drainage connection
 - Retaining wall
 - Bus shelter
 - Bus stop
 - Bollard - plain face
 - Bollard - reflective
 - Belisha beacon
 - Traffic signal
 - Traffic sign (remain/proposed/relocated)
 - Externally illuminated sign
 - Road name plate (remain/proposed/relocated)
 - Lighting column
 - Land cut-off drain
 - Realigned ditch basin
 - Realigned ditch bank

- NOTES**
- All dimensions are in metres unless otherwise specified.
 - Do not scale from this drawing.
 - Background survey information supplied by SDS surveys (dated Jun 2019 - Aug 2021), Greenhatch Group (Jul 2020), JLP Surveys (Mar 2016). For full survey details see original survey drawings.
 - For sheet layout see dwg 006804-PCL-HGN-ZZ-DR-WM-0003

Rev	Date	Description	Drn	Chk	App
P02	28/06/2022	RATCLIFFE HIGHWAY BELLMOUTH DESIGN AMENDED	SM	IG	KL
P01	07/04/2022	DESIGN FREEZE 1	SM	IG	AZ

This drawing has been specifically prepared to meet the requirements of the named client and may contain design and innovative features which differ from conventional design standards.

PROJECT CENTRE

www.marstonholdings.co.uk/projectcentre

Client

Project

MEDWAY
 HIF HOO PENINSULA
 PHASE 2 - UPCHAT RBT, NEW RELIEF RD & MAIN RD HOO

Drawing Title

GENERAL ARRANGEMENT
 SHEET 11 OF 11

Drawing Status

S3 FOR REVIEW AND COMMENT

Drawn	Designed	Date	Scale	Size
SM	KL	APR 2022	1:500	A1

Drawing No. 006804-PCL-HGN-P2-DR-WM-0011

Rev P02

