

LEGEND - EXISTING

- Site of Special Scientific Interest (SSSI)
- Highway verge
- Oil pipeline and 6m easement
- Overhead cables
- Fencing to remain
- MOD fencing to remain
- Lighting column to be retained
- Ditch/land drain
- Culvert

LEGEND - PROPOSED

- Asphalt carriageway
- Concrete carriageway
- Traffic island
- Footway
- Footway - shared
- Highway verge
- Attenuation Feature
- Earthwork embankment/cutting with 1:3 gradient
- Grasscrete
- Vehicle crossover
- Waterbody
- Tactile blister paving for controlled crossing
- Tactile blister paving for uncontrolled crossing
- Kerb
- Dropped and transition kerbs
- Splayed Kerb
- Edging kerb
- Road marking - white
- Road marking - yellow
- Road marking - aluminium studs to 1055.1
- Timber rail fence
- Gate
- Vehicle Restraint System (VRS)
- Existing MOD fence
- MOD fence, 3000(h) x 2400mm(w) weldmesh panel fence with 3 no. row of barbed wire & 750mm Ø concertina razor wire
- Culvert, headwall and drainage connection
- BB
- Belisha beacon
- Traffic sign (remain/proposed/relocated)
- Road name plate (remain/proposed/relocated)
- Lighting column
- Externally illuminated sign
- Traffic signal
- CCTV
- Traffic signal with CCTV

- NOTES**
- All dimensions are in metres unless otherwise specified.
 - Do not scale from this drawing.
 - Background survey information supplied by SDS surveys (dated Jun 2019 - Aug 2021), Greenhatch Group (Jul 2020), JLP Surveys (Mar 2016). For full survey details see original survey drawings.
 - For sheet layout see dwg 006804-PCL-HGN-ZZ-DR-WM-0002
 - For bridge structure details refer to drawing no. 6217-315_E42T/001.

Rev	Date	Description	Drn	Chk	App
P01	07/04/2022	DESIGN FREEZE 1	NB	IG	AZ



Client

Project

MEDWAY
HIF HOO PENINSULA
PHASE 1 - ISLINGHAM FARM ROAD & WOODFIELD WAY

Drawing Title

GENERAL ARRANGEMENT
SHEET 1 OF 4

Drawing Status

S3 WORK IN PROGRESS

Drawn	Designed	Date	Scale	Size
NB	IG	DEC 2021	1:500	A1

Drawing No.

006804-PCL-HGN-P1-DR-WM-0001

Rev

P01

SAFETY, HEALTH AND ENVIRONMENTAL INFORMATION

In addition to the hazards/risks normally associated with the type of work detailed on this drawing, note the following significant risks and information identified by the designer

- CONSTRUCTION**
- C001 Located close to overhead BT cables
- DEMOLITION**
- No significant hazards
- MAINTENANCE & OPERATION**
- No significant hazards

It is assumed that all works be carried out by a competent contractor working to an approved method statement.
Approved by: Yet to be reviewed

Inset A
Scale 1:500

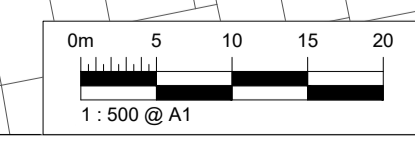

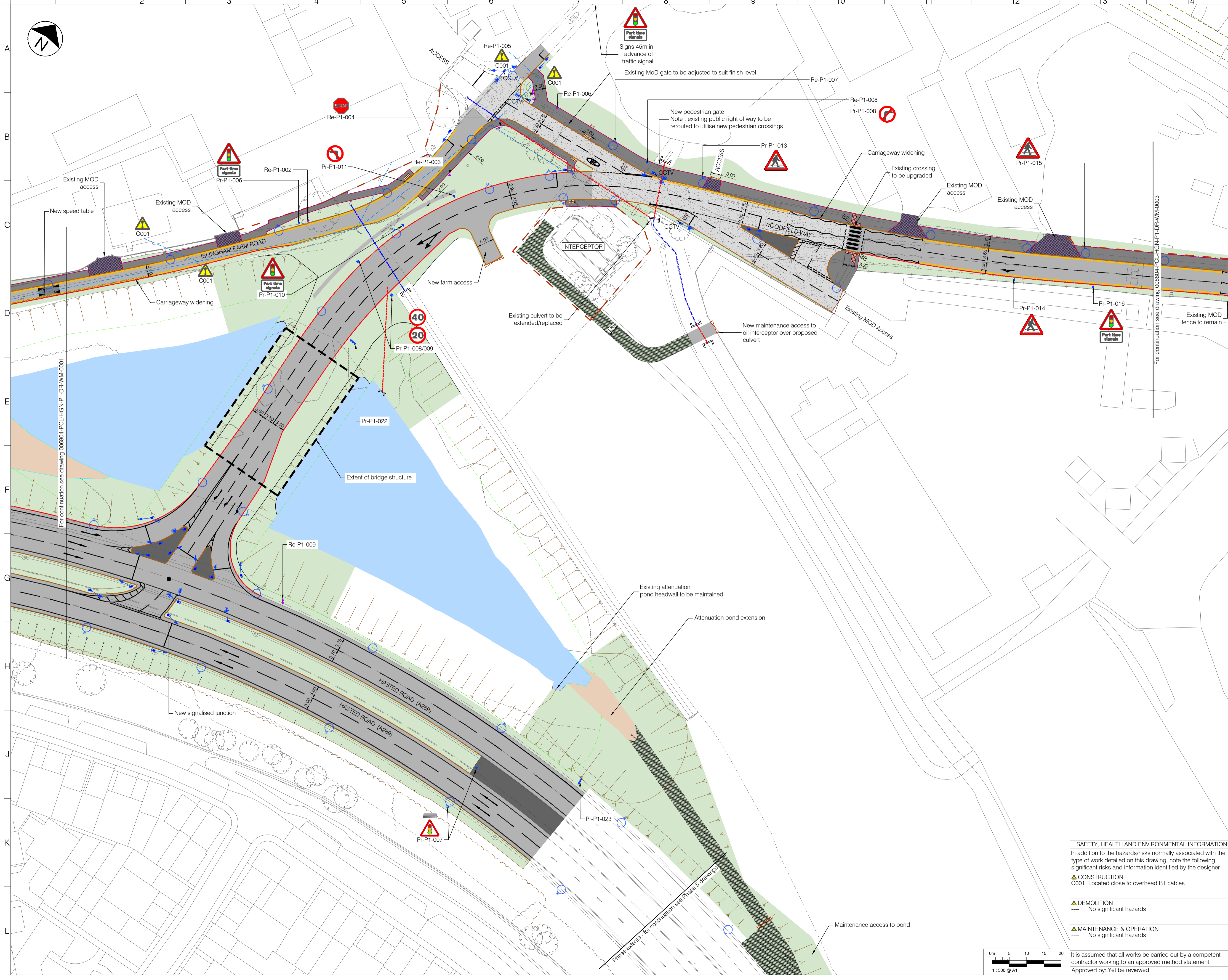

LEGEND - EXISTING

- Site of Special Scientific Interest (SSSI)
- Highway verge
- Oil pipeline and 6m easement
- Overhead cables
- Fencing to remain
- MOD fencing to remain
- Lighting column to be retained
- Ditch/land drain
- Culvert

LEGEND - PROPOSED

- Asphalt carriageway
- Concrete carriageway
- Traffic island
- Footway
- Footway - shared
- Highway verge
- Attenuation Feature
- Earthwork embankment/cutting with 1:3 gradient
- Grasscrete
- Vehicle crossover
- Waterbody
- Tactile blister paving for controlled crossing
- Tactile blister paving for uncontrolled crossing
- Kerb
- Dropped and transition kerbs
- Splayed Kerb
- Edging kerb
- Road marking - white
- Road marking - yellow
- Road marking - aluminium studs to 1055.1
- Timber rail fence
- Gate
- Vehicle Restraint System (VRS)
- Existing MOD fence
- MOD fence, 3000(h) x 2400mm(w) weldmesh panel fence with 3 no. row of barbed wire & 750mm Ø concertina razor wire
- Culvert, headwall and drainage connection
- Belisha beacon
- Traffic sign (remain/proposed/relocated)
- Road name plate (remain/proposed/relocated)
- Lighting column
- Externally illuminated sign
- Traffic signal
- CCTV
- Traffic signal with CCTV

NOTES

- All dimensions are in metres unless otherwise specified.
- Do not scale from this drawing.
- Background survey information supplied by SDS surveys (dated Jun 2019 - Aug 2021), Greenhatch Group (Jul 2020), JLP Surveys (Mar 2016). For full survey details see original survey drawings.
- For sheet layout see dwg 006804-PCL-HGN-ZZ-DR-WM-0002
- For bridge structure details refer to drawing no. 6217-315_E42T/001.

Rev	Date	Description	Drn	Chk	App
P01	07/04/22	DESIGN FREEZE 1	NB	IG	AZ

This drawing has been specifically prepared to meet the requirements of the named client and may contain design and innovative features which differ from conventional design standards.

PROJECT CENTRE
www.marstonholdings.co.uk/projectcentre

Client: **Medway**

Project: **MEDWAY
HIF HOO PENINSULA
PHASE 1 - ISLINGTON FARM ROAD & WOODFIELD WAY**

Drawing Title: **GENERAL ARRANGEMENT
SHEET 2 OF 4**

Drawing Status: **S3 WORK IN PROGRESS**

Drawn	Designed	Date	Scale	Size
NB	IG	DEC 2021	1:500	A1

Drawing No. 006804-PCL-HGN-P1-DR-WM-0002 Rev P01

SAFETY, HEALTH AND ENVIRONMENTAL INFORMATION

In addition to the hazards/risks normally associated with the type of work detailed on this drawing, note the following significant risks and information identified by the designer

CONSTRUCTION
C001 Located close to overhead BT cables

DEMOLITION
---- No significant hazards

MAINTENANCE & OPERATION
---- No significant hazards

It is assumed that all works be carried out by a competent contractor working to an approved method statement.
Approved by: Yet to be reviewed

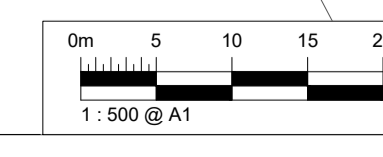

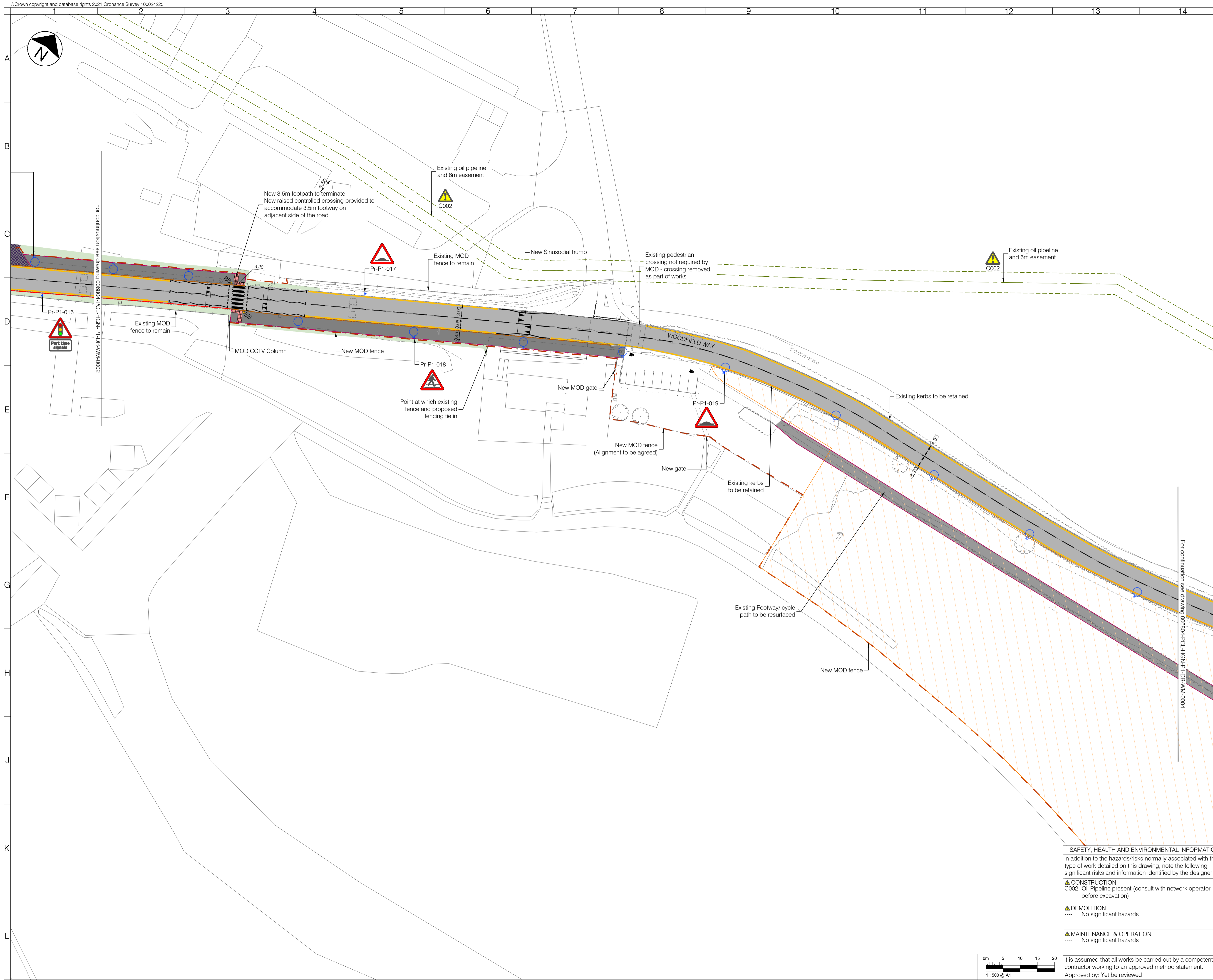

LEGEND - EXISTING

- Site of Special Scientific Interest (SSSI)
- Highway verge
- Oil pipeline and 6m easement
- Overhead cables
- Fencing to remain
- MOD fencing to remain
- Lighting column to be retained
- Ditch/land drain
- Culvert

LEGEND - PROPOSED

- Asphalt carriageway
- Concrete carriageway
- Traffic island
- Footway
- Footway - shared
- Highway verge
- Attenuation Feature
- Earthwork embankment/cutting with 1:3 gradient
- Grasscrete
- Vehicle crossover
- Waterbody
- Tactile blister paving for controlled crossing
- Tactile blister paving for uncontrolled crossing
- Kerb
- Dropped and transition kerbs
- Splayed Kerb
- Edging kerb
- Road marking - white
- Road marking - yellow
- Road marking - aluminium studs to 1055.1
- Timber rail fence
- Gate
- Vehicle Restraint System (VRS)
- Existing MOD fence
- MOD fence, 3000(h) x 2400mm(w) weldmesh panel fence with 3 no. row of barbed wire & 750mm Ø concertina razor wire
- Culvert, headwall and drainage connection
- Belisha beacon
- Traffic sign (remain/proposed/relocated)
- Road name plate (remain/proposed/relocated)
- Lighting column
- Externally illuminated sign
- Traffic signal
- CCTV
- Traffic signal with CCTV

- NOTES**
- All dimensions are in metres unless otherwise specified.
 - Do not scale from this drawing.
 - Background survey information supplied by SDS surveys (dated Jun 2019 - Aug 2021), Greenhatch Group (Jul 2020), JLP Surveys (Mar 2016). For full survey details see original survey drawings.
 - For sheet layout see dwg 006804-PCL-HGN-ZZ-DR-WM-0002
 - For bridge structure details refer to drawing no. 6217-315_E42T/001.

Rev	Date	Description	Drn	Chk	App
P01	07/04/22	DESIGN FREEZE 1		NB	IG AZ



Client: **Medway**

Project: **MEDWAY
HIF HOO PENINSULA
PHASE 1 - ISLINGHAM FARM ROAD & WOODFIELD WAY**

Drawing Title: **GENERAL ARRANGEMENT
SHEET 3 OF 4**

Drawing Status: **S3 WORK IN PROGRESS**

Drawn	Designed	Date	Scale	Size
NB	IG	DEC 2021	1:500	A1

Drawing No. **006804-PCL-HGN-P1-DR-WM-0003** Rev **P01**

SAFETY, HEALTH AND ENVIRONMENTAL INFORMATION

In addition to the hazards/risks normally associated with the type of work detailed on this drawing, note the following significant risks and information identified by the designer

CONSTRUCTION

- C002 Oil Pipeline present (consult with network operator before excavation)

DEMOLITION

- No significant hazards

MAINTENANCE & OPERATION

- No significant hazards

It is assumed that all works be carried out by a competent contractor working to an approved method statement.
Approved by: Yet to be reviewed

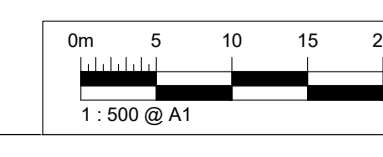

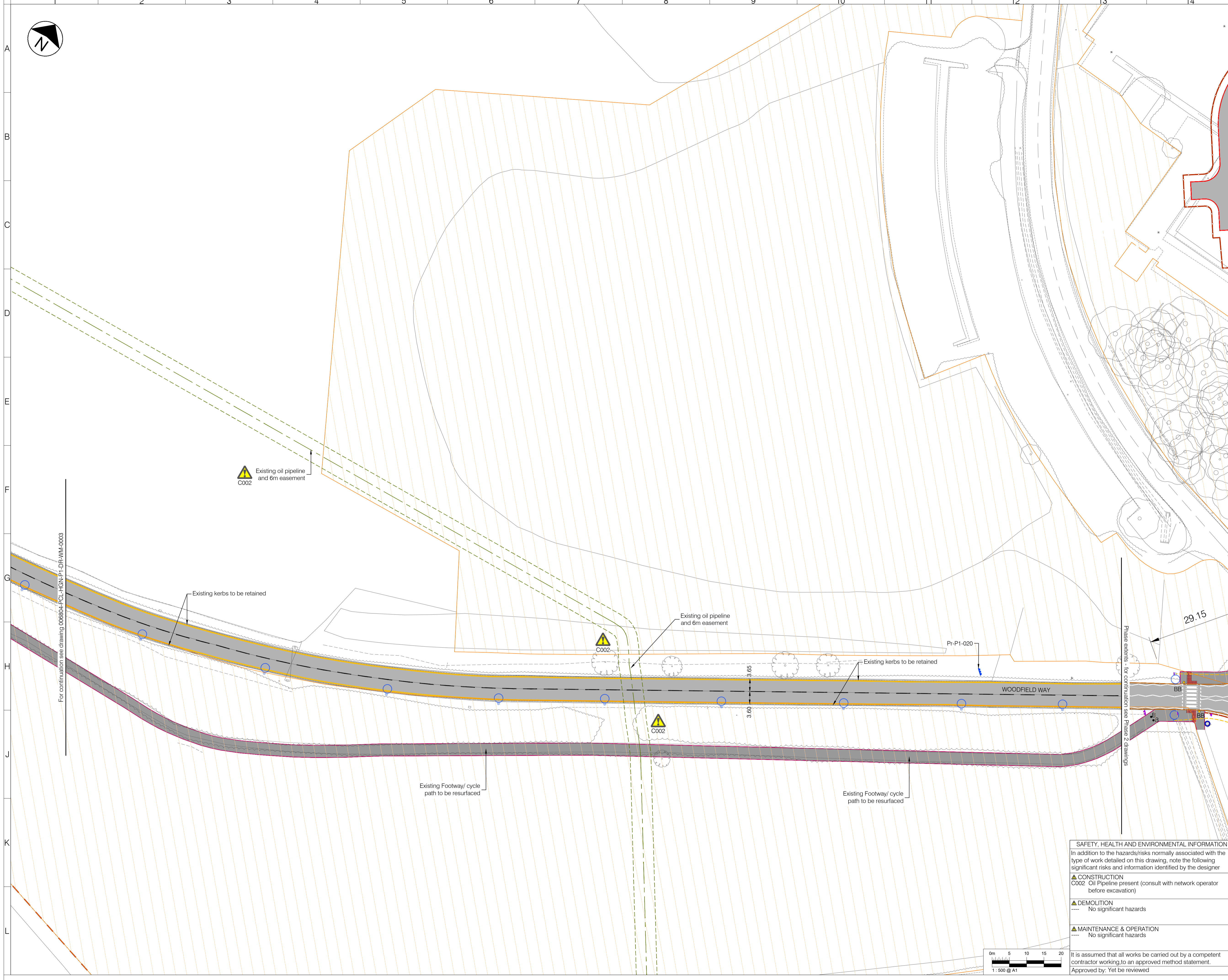

LEGEND - EXISTING

- Site of Special Scientific Interest (SSSI)
- Highway verge
- Oil pipeline and 6m easement
- Overhead cables
- Fencing to remain
- MOD fencing to remain
- Lighting column to be retained
- Ditch/land drain
- Culvert

LEGEND - PROPOSED

- Asphalt carriageway
- Concrete carriageway
- Traffic island
- Footway
- Footway - shared
- Highway verge
- Attenuation Feature
- Earthwork embankment/cutting with 1:3 gradient
- Grasscrete
- Vehicle crossover
- Waterbody
- Tactile blister paving for controlled crossing
- Tactile blister paving for uncontrolled crossing
- Kerb
- Dropped and transition kerbs
- Splayed Kerb
- Edging kerb
- Road marking - white
- Road marking - yellow
- Road marking - aluminium studs to 1055.1
- Timber rail fence
- Gate
- Vehicle Restraint System (VRS)
- Existing MOD fence
- MOD fence, 3000(h) x 2400mm(w) weldmesh panel fence with 3 no. row of barbed wire & 750mm Ø concertina razor wire
- Culvert, headwall and drainage connection
- BB
- Belisha beacon
- Traffic sign (remain/proposed/relocated)
- Road name plate (remain/proposed/relocated)
- Lighting column
- Externally illuminated sign
- Traffic signal
- CCTV
- Traffic signal with CCTV

- NOTES**
- All dimensions are in metres unless otherwise specified.
 - Do not scale from this drawing.
 - Background survey information supplied by SDS surveys (dated Jun 2019 - Aug 2021), Greenhatch Group (Jul 2020), JLP Surveys (Mar 2016). For full survey details see original survey drawings.
 - For sheet layout see dwg 006804-PCL-HGN-ZZ-DR-WM-0002
 - For bridge structure details refer to drawing no. 6217-315_E42T/001.

Rev	Date	Description	Drn	Chk	App
P01	07/04/22	DESIGN FREEZE 1	NB	IG	AZ

This drawing has been specifically prepared to meet the requirements of the named client and may contain design and innovative features which differ from conventional design standards.

PROJECT CENTRE

www.marstonholdings.co.uk/projectcentre

Medway

Client

Project

MEDWAY
HIF HOO PENINSULA
PHASE 1 - ISLINGHAM FARM ROAD & WOODFIELD WAY

Drawing Title

GENERAL ARRANGEMENT
SHEET 4 OF 4

Drawing Status

S3 WORK IN PROGRESS

Drawn	Designed	Date	Scale	Size
NB	IG	DEC 2021	1:500	A1

Drawing No. 006804-PCL-HGN-P1-DR-WM-0004

Rev P01

SAFETY, HEALTH AND ENVIRONMENTAL INFORMATION

In addition to the hazards/risks normally associated with the type of work detailed on this drawing, note the following significant risks and information identified by the designer

CONSTRUCTION

▲ C002 Oil Pipeline present (consult with network operator before excavation)

DEMOLITION

--- No significant hazards

MAINTENANCE & OPERATION

--- No significant hazards

It is assumed that all works be carried out by a competent contractor working to an approved method statement.
Approved by: Yet to be reviewed

