

LICENSING HEARING PANEL

30 JANUARY 2018

LICENSING ACT 2003 APPLICATION FOR A NEW PREMISES LICENCE

288 LONSDALE DRIVE, RAINHAM, KENT, ME8 9JU

Report from: Perry Holmes, Chief Legal Officer

Author: Lisa Hopson, Licensing Officer

Summary

The applicant has applied for a new Premises Licence in respect of 288 Lonsdale Drive, Rainham, Kent, ME8 9JU.

All responsible authorities have been consulted in line with the Licensing Act 2003.

Representations have been received from members of the public; no agreement has been reached.

1. Budget and Policy Framework

- 1.1 Medway Council has published its Statement of Licensing Policy, which it takes into account in all applications relating to the Licensing Act 2003.

2. The application

- 2.1 In accordance with the Licensing Act 2003, the Council has received an application for a new Premises Licence in respect of 288 Lonsdale Drive, Rainham, Kent, ME8 9JU.

- 2.2 The details of the application requirements are as follows:

Supply of Alcohol (off the premises)

Monday to Sunday

07:00 – 23:00

- 2.3 A copy of the original application as submitted is at Appendix A.

- 2.4 The application has been correctly advertised in the local press and notices displayed on the premises for the required period.
- 2.5 A copy of a map showing the location of the premises is at Appendix B.

3. Promotion of Licensing Objectives

- 3.1 The applicant is expected to demonstrate that they have dealt with and understand the promotion of the four licensing objectives, where appropriate. Members are referred to section M of the application at Appendix A.
- 3.2 The four licensing objectives are:

- the prevention of crime and disorder
- public safety
- the prevention of public nuisance
- the protection of children from harm

4. Relevant Representations

- 4.1 This matter has been put to the Licensing Hearing Panel because the Council has received representations relating to all four of the licensing objectives from members of the public. Copies of these are attached at Appendix C. To date no agreement has been reached.

5. Policy Considerations

- 5.1 Medway Council has published its Statement of Licensing Policy, which it will consider alongside the amended Guidance issued by the Home Office under section 182 of the Licensing Act 2003 in all applications.
- 5.2 In determining this application, Members may wish to consider information contained in Appendix 4 to the Statement of Licensing Policy that lists examples of good practice against the four licensing objectives as well as Chapters 9 and 10 of the amended Guidance.

6. Risk Management

- 6.1 The Council has to consider and determine this application, which is a function relating to licensing and registration as set out in Schedule 1 to the Functions Regulations, the Licensing Act 2003, the Gambling Act 2005 and other licensing functions reserved by law to the Council's Licensing and Safety Committee and its Sub-Committees, in accordance with the law (both statutory and case law), relevant statutory guidance and statements of policy.

7. Financial and legal implications

- 7.1 There are no direct financial or legal implications at this time.
- 7.2 This hearing is regulated by the Licensing Act 2003 (Hearings) Regulations 2005 (as amended).

- 7.3 There is the possibility of a challenge by way of appeal to the decision by either the applicant or objectors should either have the requisite grounds to do so. Legal advice will be given to Members, as appropriate, at the meeting. However, whatever the decision of the Panel, this must be based on the evidence placed before it, in line with the licensing objectives, and the Panel must decide what weight to attribute to this information.

8. Recommendation

- 8.1 That the Licensing Hearing Panel, having regard to the Licensing Act 2003, the statutory guidance issued under S182, the Council's Statement of Licensing Policy and all matters before it, both written and oral, considers and determines this application for a premises licence .

Lead officer contact:

Mrs Lisa Hopson – Licensing Officer

Telephone: 01634 331925 Email: lisa.hopson@medway.gov.uk

Appendices

Appendix A – Application for new Premises Licence

Appendix B - Location Map

Appendix C – Copies of representations received

Background papers

None

11 OCT 2017

APPENDIX A

**Application for a premises licence to be granted
under the Licensing Act 2003**

PLEASE READ THE FOLLOWING INSTRUCTIONS FIRST

Before completing this form please read the guidance notes at the end of the form. If you are completing this form by hand please write legibly in block capitals. In all cases ensure that your answers are inside the boxes and written in black ink. Use additional sheets if necessary.

You may wish to keep a copy of the completed form for your records.

I/We Priyashalini Muralitharan

(Insert name(s) of applicant)

apply for a premises licence under section 17 of the Licensing Act 2003 for the premises described in Part 1 below (the premises) and I/we are making this application to you as the relevant licensing authority in accordance with section 12 of the Licensing Act 2003

Part 1 – Premises details

Postal address of premises or, if none, ordnance survey map reference or description			
288 Lonsdale Drive			
Post town	Rainham	Postcode	ME8 9JU

Telephone number at premises (if any)	None
Non-domestic rateable value of premises	£

Part 2 - Applicant details

Please state whether you are applying for a premises licence as Please tick as appropriate

- | | | | |
|----|--|-------------------------------------|-----------------------------|
| a) | an individual or individuals * | <input checked="" type="checkbox"/> | please complete section (A) |
| b) | a person other than an individual * | | |
| | i as a limited company/limited liability partnership | <input type="checkbox"/> | please complete section (B) |
| | ii as a partnership (other than limited liability) | <input type="checkbox"/> | please complete section (B) |
| | iii as an unincorporated association or | <input type="checkbox"/> | please complete section (B) |
| | iv other (for example a statutory corporation) | <input type="checkbox"/> | please complete section (B) |
| c) | a recognised club | <input type="checkbox"/> | please complete section (B) |
| d) | a charity | <input type="checkbox"/> | please complete section (B) |

- e) the proprietor of an educational establishment ☐ please complete section (B)
- f) a health service body ☐ please complete section (B)
- g) a person who is registered under Part 2 of the Care Standards Act 2000 (c14) in respect of an independent hospital in Wales ☐ please complete section (B)
- ga) a person who is registered under Chapter 2 of Part 1 of the Health and Social Care Act 2008 (within the meaning of that Part) in an independent hospital in England ☐ please complete section (B)
- h) the chief officer of police of a police force in England and Wales ☐ please complete section (B)

* If you are applying as a person described in (a) or (b) please confirm (by ticking yes to one box below):

I am carrying on or proposing to carry on a business which involves the use of the premises for licensable activities; or ☒

I am making the application pursuant to a

statutory function or ☐

a function discharged by virtue of Her Majesty's prerogative ☐

(A) INDIVIDUAL APPLICANTS (fill in as applicable)

Mr <input type="checkbox"/>	Mrs <input checked="" type="checkbox"/>	Miss <input type="checkbox"/>	Ms <input type="checkbox"/>	Other Title (for example, Rev)	
Surname Muralltharan			First names Priyashalini		
Date of birth: 26.07.1986 or over		I am 18 years old <input checked="" type="checkbox"/> Please tick yes			
Nationality: British					
Current residential address if different from premises address					
Post town				Postcode	
Daytime contact telephone number					
E-mail address (optional)					

SECOND INDIVIDUAL APPLICANT (if applicable)

Mr <input type="checkbox"/>	Mrs <input type="checkbox"/>	Miss <input type="checkbox"/>	Ms <input type="checkbox"/>	Other Title (for example, Rev)	
-----------------------------	------------------------------	-------------------------------	-----------------------------	--------------------------------	--

Surname		First names	
Date of birth over		I am 18 years old or <input type="checkbox"/> Please tick yes	
Nationality			
Current residential address if different from premises address			
Post town		Postcode	
Daytime contact telephone number			
E-mail address (optional)			

(B) OTHER APPLICANTS

Please provide name and registered address of applicant in full. Where appropriate please give any registered number. In the case of a partnership or other joint venture (other than a body corporate), please give the name and address of each party concerned.

Name
Address
Registered number (where applicable)
Description of applicant (for example, partnership, company, unincorporated association etc.)
Telephone number (if any)
E-mail address (optional)

Part 3 Operating Schedule

When do you want the premises licence to start?

DD	MM	YYYY
<input type="text"/>	<input type="text"/>	<input type="text"/>

If you wish the licence to be valid only for a limited period, when do you want it to end?

DD	MM	YYYY
<input type="text"/>	<input type="text"/>	<input type="text"/>

Please give a general description of the premises (please read guidance note 1)

A groceries newsagent shop applying for a Premises licence to be able to sell alcohol on the premises.

If 5,000 or more people are expected to attend the premises at any one time, please state the number expected to attend.

What licensable activities do you intend to carry on from the premises?

(please see sections 1 and 14 and Schedules 1 and 2 to the Licensing Act 2003)

Provision of regulated entertainment (please read guidance note 2)

Please tick all that apply

- | | |
|---|--------------------------|
| a) plays (if ticking yes, fill in box A) | <input type="checkbox"/> |
| b) films (if ticking yes, fill in box B) | <input type="checkbox"/> |
| c) indoor sporting events (if ticking yes, fill in box C) | <input type="checkbox"/> |
| d) boxing or wrestling entertainment (if ticking yes, fill in box D) | <input type="checkbox"/> |
| e) live music (if ticking yes, fill in box E) | <input type="checkbox"/> |
| f) recorded music (if ticking yes, fill in box F) | <input type="checkbox"/> |
| g) performances of dance (if ticking yes, fill in box G) | <input type="checkbox"/> |
| h) anything of a similar description to that falling within (e), (f) or (g) (if ticking yes, fill in box H) | <input type="checkbox"/> |

Provision of late night refreshment (if ticking yes, fill in box I)

☐

Supply of alcohol (if ticking yes, fill in box J)

☒

In all cases complete boxes K, L and M

A

Plays Standard days and timings (please read guidance note 7)			<u>Will the performance of a play take place indoors or outdoors or both – please tick</u> (please read guidance note 3)	Indoors	<input type="checkbox"/>
				Outdoors	<input type="checkbox"/>
				Both	<input type="checkbox"/>
Day	Start	Finish			
Mon			<u>Please give further details here</u> (please read guidance note 4)		
Tue					
Wed			<u>State any seasonal variations for performing plays</u> (please read guidance note 5)		
Thur					
Fri			<u>Non standard timings. Where you intend to use the premises for the performance of plays at different times to those listed in the column on the left, please list</u> (please read guidance note 6)		
Sat					
Sun					

B

Films Standard days and timings (please read guidance note 7)			Will the exhibition of films take place indoors or outdoors or both – please tick (please read guidance note 3)	Indoors	<input type="checkbox"/>
				Outdoors	<input type="checkbox"/>
Day	Start	Finish		Both	<input type="checkbox"/>
Mon			<u>Please give further details here</u> (please read guidance note 4)		
Tue					
Wed			<u>State any seasonal variations for the exhibition of films</u> (please read guidance note 5)		
Thur					
Fri			<u>Non standard timings. Where you intend to use the premises for the exhibition of films at different times to those listed in the column on the left, please list</u> (please read guidance note 6)		
Sat					
Sun					

C

Indoor sporting events Standard days and timings (please read guidance note 7)			<u>Please give further details</u> (please read guidance note 4)
Day	Start	Finish	
Mon			
Tue			<u>State any seasonal variations for indoor sporting events</u> (please read guidance note 5)
Wed			
Thur			
Fri			<u>Non standard timings. Where you intend to use the premises for indoor sporting events at different times to those listed in the column on the left, please list</u> (please read guidance note 6)
Sat			
Sun			

D

Boxing or wrestling entertainments Standard days and timings (please read guidance note 7)			Will the boxing or wrestling entertainment take place indoors or outdoors or both – please tick (please read guidance note 3)	Indoors	<input type="checkbox"/>
				Outdoors	<input type="checkbox"/>
Day	Start	Finish		Both	<input type="checkbox"/>
Mon			Please give further details here (please read guidance note 4)		
Tue					
Wed			State any seasonal variations for boxing or wrestling entertainment (please read guidance note 5)		
Thur					
Fri			Non standard timings. Where you intend to use the premises for boxing or wrestling entertainment at different times to those listed in the column on the left, please list (please read guidance note 6)		
Sat					
Sun					

Live music Standard days and timings (please read guidance note 7)			Will the performance of live music take place indoors or outdoors or both – please tick (please read guidance note 3)		Indoors	<input type="checkbox"/>
					Outdoors	<input type="checkbox"/>
					Both	<input type="checkbox"/>
Day	Start	Finish	Please give further details here (please read guidance note 4)			
Mon						
Tue						
Wed			State any seasonal variations for the performance of live music (please read guidance note 5)			
Thur						
Fri			Non standard timings. Where you intend to use the premises for the performance of live music at different times to those listed in the column on the left, please list (please read guidance note 6)			
Sat						
Sun						

F

Recorded music Standard days and timings (please read guidance note 7)			<u>Will the playing of recorded music take place indoors or outdoors or both – please tick</u> (please read guidance note 3)	Indoors	<input type="checkbox"/>
				Outdoors	<input type="checkbox"/>
				Both	<input type="checkbox"/>
Day	Start	Finish			
Mon			<u>Please give further details here</u> (please read guidance note 4)		
Tue					
Wed			<u>State any seasonal variations for the playing of recorded music</u> (please read guidance note 5)		
Thur					
Fri			<u>Non standard timings. Where you intend to use the premises for the playing of recorded music at different times to those listed in the column on the left, please list</u> (please read guidance note 6)		
Sat					
Sun					

G

Performances of dance Standard days and timings (please read guidance note 7)			<u>Will the performance of dance take place indoors or outdoors or both – please tick</u> (please read guidance note 3)		Indoors	<input type="checkbox"/>
					Outdoors	<input type="checkbox"/>
					Both	<input type="checkbox"/>
Day	Start	Finish				
Mon			<u>Please give further details here</u> (please read guidance note 4)			
Tue						
Wed			<u>State any seasonal variations for the performance of dance</u> (please read guidance note 5)			
Thur						
Fri			<u>Non standard timings. Where you intend to use the premises for the performance of dance at different times to those listed in the column on the left, please list</u> (please read guidance note 6)			
Sat						
Sun						

H

Anything of a similar description to that falling within (e), (f) or (g) Standard days and timings (please read guidance note 7)			Please give a description of the type of entertainment you will be providing	
Day	Start	Finish	<u>Will this entertainment take place indoors or outdoors or both – please tick</u> (please read guidance note 3)	Indoors <input type="checkbox"/>
Mon				Outdoors <input type="checkbox"/>
				Both <input type="checkbox"/>
Tue			<u>Please give further details here</u> (please read guidance note 4)	
Wed				
Thur			<u>State any seasonal variations for entertainment of a similar description to that falling within (e), (f) or (g)</u> (please read guidance note 5)	
Fri				
Sat			<u>Non standard timings. Where you intend to use the premises for the entertainment of a similar description to that falling within (e), (f) or (g) at different times to those listed in the column on the left, please list</u> (please read guidance note 6)	
Sun				

I

Late night refreshment Standard days and timings (please read guidance note 7)			Will the provision of late night refreshment take place indoors or outdoors or both – please tick (please read guidance note 3)	
Day	Start	Finish	Indoors	<input type="checkbox"/>
			Outdoors	<input type="checkbox"/>
			Both	<input type="checkbox"/>
Mon			<u>Please give further details here</u> (please read guidance note 4)	
Tue				
Wed			<u>State any seasonal variations for the provision of late night refreshment</u> (please read guidance note 5)	
Thur				
Fri			<u>Non standard timings. Where you intend to use the premises for the provision of late night refreshment at different times, to those listed in the column on the left, please list</u> (please read guidance note 6)	
Sat				
Sun				

J

Supply of alcohol Standard days and timings (please read guidance note 7)			Will the supply of alcohol be for consumption – please tick (please read guidance note 8)	On the premises	<input type="checkbox"/>
				Off the premises	<input checked="" type="checkbox"/>
				Both	<input type="checkbox"/>
Day	Start	Finish	State any seasonal variations for the supply of alcohol (please read guidance note 5)		
Mon	07:00	23:00			
Tue	07:00	23:00			
Wed	07:00	23:00	Non standard timings. Where you intend to use the premises for the supply of alcohol at different times to those listed in the column on the left, please list (please read guidance note 6)		
Thur	07:00	23:00			
Fri	07:00	23:00			
Sat	07:00	23:00			
Sun	07:00	23:00			

State the name and details of the individual whom you wish to specify on the licence as designated premises supervisor (Please see declaration about the entitlement to work in the checklist at the end of the form):

Name Priyashalini Muralitharan	
Date of birth: 26.07.1986	
Postcode	ME10 2SH
Personal licence number (if known) Medway – 11 – PL – 2266	
Issuing licensing authority (if known) Medway Borough Council	



K

Please highlight any adult entertainment or services, activities, other entertainment or matters ancillary to the use of the premises that may give rise to concern in respect of children (please read guidance note 9).

L

Hours premises are open to the public Standard days and timings (please read guidance note 7)			<u>State any seasonal variations</u> (please read guidance note 5)
Day	Start	Finish	
Mon	05:00	23:00	<u>Non standard timings. Where you intend the premises to be open to the public at different times from those listed in the column on the left, please list</u> (please read guidance note 6)
Tue	05:00	23:00	
Wed	05:00	23:00	
Thur	05:00	23:00	
Fri	05:00	23:00	
Sat	05:00	23:00	
Sun	05:00	23:00	

M Describe the steps you intend to take to promote the four licensing objectives:

a) General – all four licensing objectives (b, c, d and e) (please read guidance note 10)

We will try everything we can to make sure we adhere to the 4 licensing objectives

b) The prevention of crime and disorder

- CCTV Cameras are available (Covers both inside and outside) the premises.
- (2) The CCTV cameras cover the areas where sale and supply of alcohol occurs, entrance, fire exits, the outside of the premises and the rear of the premises.
 - (3) The CCTV equipment will be maintained in good working order. In case of failure, notification will be given to the Police and Local Authority.
 - (4) CCTV images are kept for as minimum of 28 days.
 - (5) The Premises Licence holder is competent in downloading the CCTV images at all times and upon request.
 - (6) The CCTV images are kept on a hard drive.

c) Public safety

A refusals book will be kept on the premises for all refusals of sale of alcohol carried out. The Refusal book will contain the following details: (1) Day, date and time of refusal (2) Nature and reason for refusal (3) The records will be made available on request to the Police or Local Authority or Trading Standards.

d) The prevention of public nuisance

- CCTV Cameras are available (Covers both inside and outside) the premises.
- (2) Challenge 25 posters are on display
 - (3) Posters on display to indicate that CCTV is in operation on the premises.

e) The protection of children from harm

- (1) All Staff are trained in the sale of alcohol.
(2) We adopt a Challenge 25 Policy. We are very strict on proof of age verification.
Passport and Driving licence are used to check for ID. We have a NO ID No Sale policy.
(3) The tills have got an age prompt verification for underage products that would be validated only if ID is being shown.

Checklist:

Please tick to indicate agreement

- I have made or enclosed payment of the fee. ☒
- I have enclosed the plan of the premises. ☒
- I have sent copies of this application and the plan to responsible authorities and others where applicable. ☒
- I have enclosed the consent form completed by the individual I wish to be designated premises supervisor, if applicable. ☒
- I understand that I must now advertise my application. ☒
- I understand that if I do not comply with the above requirements my application will be rejected. ☒
- ☐ [Applicable to all individual applicants, including those in a partnership which is not a limited liability partnership, but not companies or limited liability partnerships] I have included documents demonstrating my entitlement to work in the United Kingdom (please read note 15). ☒

IT IS AN OFFENCE, UNDER SECTION 158 OF THE LICENSING ACT 2003, TO MAKE A FALSE STATEMENT IN OR IN CONNECTION WITH THIS APPLICATION. THOSE WHO MAKE A FALSE STATEMENT MAY BE LIABLE ON SUMMARY CONVICTION TO A FINE OF ANY AMOUNT.

IT IS AN OFFENCE UNDER SECTION 24B OF THE IMMIGRATION ACT 1971 FOR A PERSON TO WORK WHEN THEY KNOW, OR HAVE REASONABLE CAUSE TO BELIEVE, THAT THEY ARE DISQUALIFIED FROM DOING SO BY REASON OF THEIR IMMIGRATION STATUS. THOSE WHO EMPLOY AN ADULT WITHOUT LEAVE OR WHO IS SUBJECT TO CONDITIONS AS TO EMPLOYMENT WILL BE LIABLE TO A CIVIL PENALTY UNDER SECTION 15 OF THE IMMIGRATION, ASYLUM AND NATIONALITY ACT 2006 AND PURSUANT TO SECTION 21 OF THE SAME ACT, WILL BE COMMITTING AN OFFENCE WHERE THEY DO SO IN THE KNOWLEDGE, OR WITH REASONABLE CAUSE TO BELIEVE, THAT THE EMPLOYEE IS DISQUALIFIED.

Part 4 – Signatures (please read guidance note 11)

Signature of applicant or applicant's solicitor or other duly authorised agent (see guidance note 12). **If signing on behalf of the applicant, please state in what capacity.**

Declaration	<ul style="list-style-type: none">◦ [Applicable to individual applicants only, including those in a partnership which is not a limited liability partnership] I understand I am not entitled to be issued with a licence if I do not have the entitlement to live and work in the UK (or if I am subject to a condition preventing me from doing work relating to the carrying on of a licensable activity) and that my licence will become invalid if I cease to be entitled to live and work in the UK (please read guidance note 15).◦ The DPS named in this application form is entitled to work in the UK (and is not subject to conditions preventing him or her from doing work relating to a licensable activity) and I have seen a copy of his or her proof of entitlement to work, if appropriate (please see note 15)
Signature	
Date	10 th October 2017
Capacity	Applicant

For joint applications, signature of 2nd applicant or 2nd applicant's solicitor or other authorised agent (please read guidance note 13). **If signing on behalf of the applicant, please state in what capacity.**

Signature	
Date	
Capacity	

Contact name (where not previously given) and postal address for correspondence associated with this application (please read guidance note 14)			
Post town		Postcode	
Telephone number (if any)			
If you would prefer us to correspond with you by e-mail, your e-mail address (optional)			

Notes for Guidance

1. Describe the premises, for example the type of premises, its general situation and layout and any other information which could be relevant to the licensing objectives. Where your application includes off-supplies of alcohol and you intend to provide a place for consumption of these off-supplies, you must include a description of where the place will be and its proximity to the premises.
2. In terms of specific regulated entertainments please note that:
 - Plays: no licence is required for performances between 08:00 and 23.00 on any day, provided that the audience does not exceed 500.
 - Films: no licence is required for 'not-for-profit' film exhibition held in community premises between 08.00 and 23.00 on any day provided that the audience does not exceed 500 and the organiser (a) gets consent to the screening from a person who is responsible for the premises; and (b) ensures that each such screening abides by age classification ratings.
 - Indoor sporting events: no licence is required for performances between 08.00 and 23.00 on any day, provided that the audience does not exceed 1000.
 - Boxing or Wrestling Entertainment: no licence is required for a contest, exhibition or display of Greco-Roman wrestling, or freestyle wrestling between 08.00 and 23.00 on any day, provided that the audience does not exceed 1000. Combined fighting sports – defined as a contest, exhibition or display which combines boxing or wrestling with one or more martial arts – are licensable as a boxing or wrestling entertainment rather than an indoor sporting event.
 - Live music: no licence permission is required for:
 - a performance of unamplified live music between 08.00 and 23.00 on any day, on any premises.
 - a performance of amplified live music between 08.00 and 23.00 on any day on premises authorised to sell alcohol for consumption on those premises, provided that the audience does not exceed 500.
 - a performance of amplified live music between 08.00 and 23.00 on any day, in a workplace that is not licensed to sell alcohol on those premises, provided that the audience does not exceed 500.
 - a performance of amplified live music between 08.00 and 23.00 on any day, in a church hall, village hall, community hall, or other similar community premises, that is not licensed by a premises licence to sell alcohol, provided that (a) the audience does not exceed 500, and (b) the organiser gets consent for the performance from a person who is responsible for the premises.
 - a performance of amplified live music between 08.00 and 23.00 on any day, at the non-residential premises of (i) a local authority, or (ii) a school, or (iii) a hospital, provided that (a) the audience does not exceed 500, and (b) the organiser gets consent for the performance on the relevant premises from: (i) the local authority concerned, or (ii) the school or (iii) the health care provider for the hospital.
 - Recorded Music: no licence permission is required for:
 - any playing of recorded music between 08.00 and 23.00 on any day on premises authorised to sell alcohol for consumption on those premises, provided that the audience does not exceed 500.
 - any playing of recorded music between 08.00 and 23.00 on any day, in a church hall, village hall, community hall, or other similar community premises, that is not licensed by a premises licence to sell alcohol, provided that (a) the audience does not exceed 500, and (b) the organiser gets consent for the performance from a person who is responsible for the premises.
 - any playing of recorded music between 08.00 and 23.00 on any day, at the non-residential premises of (i) a local authority, or (ii) a school, or

PROPOSED PLAN



This drawing not to be scaled.
This is for layout purposes only.
Any accurate measurements should be carried out by a skilled third party.

BOOKER

Retailer Name:
Trading Name:
Address: Gillingham
Post code:

Drawing No: 1
Drawing Date: 02/10/17
Drawn By: Adam Tingey
E Mail: adam.tingey@booker.co.uk
Promotion Bays: 2
FORMAT: Premier Express
Sq Ft: 530

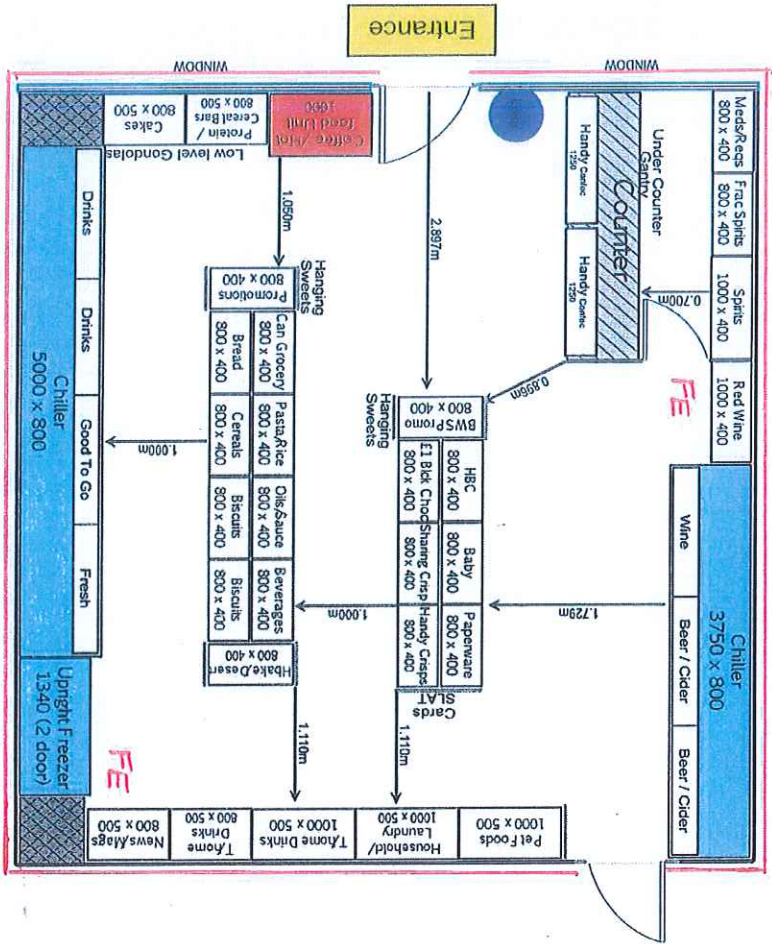

EQUIPMENT LIST

- Shelving requirements: Base + 6 for each bay shown on plan (Based on 1610mm height gondola)
- Silver/Grey slat panels (as shown on plan)
- Silver/Grey Shelf edge strips (data strips)
- 800mm perspex risers x 50 qty
- 1250mm perspex risers x 10 qty
- 150mm Slatwallhooks (for hanging sweets) x 100
- Coffee & Hot Food option to be discussed

Licensable Area

FE ARE EXTINGUISHERS

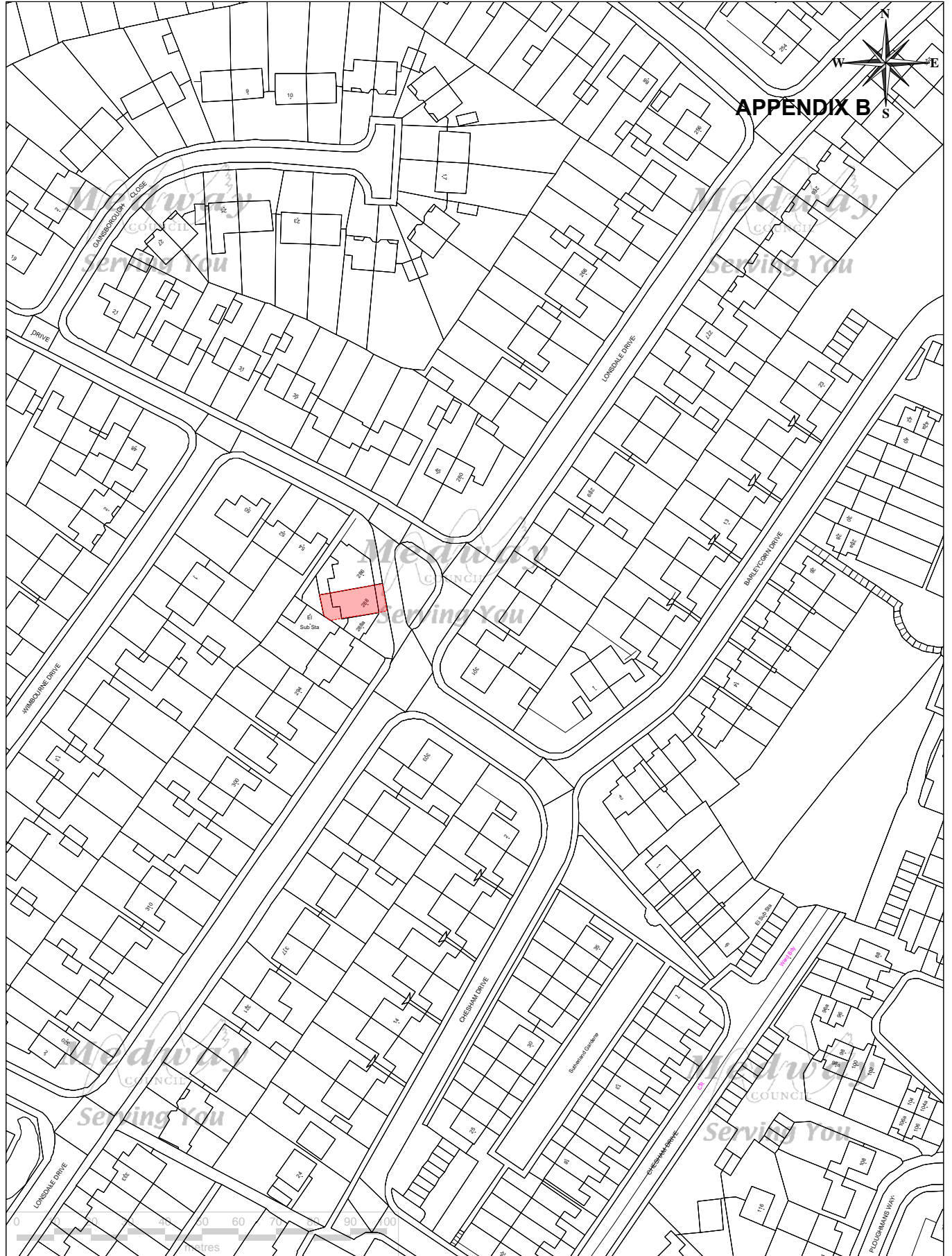

APPENDIX B

288 Lonsdale Drive, Rainham, Gillingham, Medway, ME8 9JU



From: david english <
Sent: 17 October 2017 11:26
To: licensing
Subject: Lonsdale drive newsagents.

Dear Sir or Madam.

I noticed that an application has been submitted for a alcohol license and extended opening hours, with regard to the newsagents on Lonsdale drive Rainham.

I would like to object to this application for the following reasons.

- I don't object in principle to the alcohol license being granted its a business and as such has to be competitive.
- My main objection is the extended proposed opening hours, and selling alcohol that will cause problems for residents in the area.
- From my lounge we constantly hear the movement up of vehicles stopping to use the shops, the some playing loud music. The opening and closing of vehicle doors is quite pronounced as it travels the short distance to our dwelling.
- At the present time we know that after 20:00 hrs it quieters down as the shop closes for the day, it would be unbearable if we had to endure this from the proposed hours of 06:00 hrs until 23:00 seven days a week.
- No other shops in this area opens this late most closing by 21:00 hrs , we would be a magnet for shoppers wanting to buy alcohol late into the evening with all the associated problems it brings.
- If this proposal was granted noted it was refused on an earlier submission, it would blight the residents lives.

Yours Sincerely.

✓
hopson, lisa

From: Don Cocker <...>
Sent: 18 October 2017 18:35
To: licensing
Cc:
Subject: Objection to the Granting of a New Premises Licence at 288 Lonsdale Drive
Attachments: 2017 10 17 Objections to granting of a New Premises Licence to 288 Lonsdale Drive.docx

Importance: High
Sensitivity: Confidential

Dear Sirs,

Please find attached a copy of our objections to the granting of the Subject licence.

Please confirm receipt and our Registration as "interested Parties".

Donald Cocker

Linda Alice Cocker

✓
Mr. D. & Mrs. L.A. Cocker

(By e-mail)
Licensing Unit
Medway Council
Gun Wharf
Dock Road
Chatham
KENT
ME4 4TR

17th October 2017

Dear Sirs;

Subject: Application for a premises licence for the sale of alcohol at Lonsdale Drive Newsagents of 288, Lonsdale Drive, Gillingham, Kent. ME8 9JU.

Please find overleaf our objections to the granting of the Subject licence. These have been drawn up after reviewing Priyashalini Muralitharan's application specifically with reference to the four licensing objectives and in accordance with the guidance for objecting to the granting of a licence as posted on the Medway Council website as of 17th October 2017.

As well as these targeted objections we would like to emphasise that our objections are mainly in the areas of the sale of alcohol and extended opening times. Both of these will seriously affect our local amenity and, on this basis, we would ask that the application be refused and the current opening hours be imposed as a condition of trade.

In addition, we believe that the supply of alcohol in the area is more than adequately catered for. There are at least six small business selling alcohol together with several public houses and at least two seven day a week supermarkets; the latter covering the extended range of opening hours in the proposal.

We would request that the press NOT be excluded, as happened, without warning, in the 2013 Application. We cannot see how it can be other than "in the public interest" for these matters to be discussed in open session.

We also query why the application has been redacted so thoroughly with regard to the applicant's details other than their name? The applicant's residence at least, forms part of any consideration when dealing with lock up premises. We are aware that these comments will be seen by the applicant and/or their agent and would expect the same courtesy to be shown to us.

We would be grateful if you would acknowledge receipt of this and confirm that it will be presented to the panel.

We would also request that you register us as "Interested Parties" and advise us of the date and location that the panel is to sit to consider this application so that we may attend.

Yours faithfully;

Linda A. Cocker

Donald Cocker

**Objections to the Granting of a premises licence for the sale of alcohol at Lonsdale Drive Newsagents of
288, Lonsdale Drive, Gillingham, Kent. ME8 9JU**

The Prevention of Crime and Disorder

The application fails to address all of the areas outlined in the guidance with the exception of CCTV. There is no mention of how the applicant will deal with Drugs or Crime Prevention i.e. Alarms, Lighting, Excess Stock, Safes and Cash Registers. Given that the premises are, to say the least, flimsy, these are areas that need to be addressed in order that local residents will not suffer loss of amenity due to drugs and crime being drawn into a densely residential area.

The recently published statements from the police about their ability to attend public disturbance calls together with their stated intention not to attend unless it is "serious" leaves us without any immediate recourse should such a disturbance occur.

Public Safety

In this case the application fails to address any of the areas outlined in the guidance i.e. Fire Regulations, Food Safety, Disabled Facilities, Health and Safety or Overheating. Whilst many of these are related to the management of the business there should be some description of any Fire Precautions that will be taken given the introduction of highly flammable alcohol. Again, this is a densely residential area and a fire would rapidly spread to adjoining premises.

The Prevention of Public Nuisance

The applicant seems to consider that "A notice will be displayed..." meets all the requirements of this objective. No mention is made of the other areas listed under Noise, neither does the application cover Rubbish and Litter, Car Parking or Residents Association.

All of these will have a seriously detrimental effect on Local Amenity if alcohol is to be sold on a daily basis from 06:00 to 23:00 seven days a week; a total of 119 hours a week (72%) directly opposite our residence.

The green outside the premises already attracts occasional small groups during opening hours and just after closing; currently at 20:00 weekdays and 1500 Sundays. The sale of alcohol will, inevitably, increase the frequency, age, and noise and anti-social behaviour of these gatherings; all to the severe detriment to Local Amenity.

Parking is also a serious issue even with the current opening times. We live directly opposite the premises with a shared drive with rated access onto Sunningdale Drive handling four vehicles. Yellow lines are constantly ignored, Customers regularly park across our drive, Car doors are slammed, Car Radios are routinely left playing loudly. If the operating hours are extended this will continue until 2300 and later and will be an unacceptable loss of Local Amenity in this densely populated residential area.

Litter is already a problem in this area. We regularly have wrappers and drink cans thrown into our garden and our hedge is often abused so that customers can sit on our wall. The introduction of alcohol and the extended opening hours can only exasperate this again, with the loss of Local Amenity.

The applicant has made no attempt to advertise his application other than to put one small notice on the premise's windows. I cannot speak for residents associations but no one in the local area has been approached by the applicant or their representatives.

The Protection of Children From Harm

Whilst the applicant has made a great deal about identifying ages, recording refusals and training there is no mention of the fact that the premises are currently used by many junior and senior school children on their way to and from school and at lunchtime. All of these will be exposed to the temptation of alcohol and some will manage to obtain it regardless of age. With the current emphasis on reducing alcohol consumption making this available in premises in a residential area has to be a retrograde step.

✓

I am writing to object to the application by Mr. Muralitharan for a licence to sell alcohol from his premises at 288 Lonsdale Drive. This local shop has existed in it's current form for many years, and has traded successfully as such in the middle of a residential area. I see no reason for the need to start selling alcohol from these premises from 0700 - 2300 seven days a week. This will only encourage anti social behavior in an area of the towns which has , so far, avoided any such issues. There are already several licenced premises in Rainham and the surrounding areas for the use of those who wish to purchase alcohol, I fail to see the need to have another. This shop has been a great asset to the local area for a long time and it would continue to thrive without selling alcohol.

Andy Salter

Sent from Mail for Windows 10

- ✓
1. It is a residential area and this would increase the late night traffic
 2. Increased litter by those buying alcohol and consuming it locally i.e. outside shop or within the vicinity including rear access alley of houses
 3. This shop is on a school route and is used by children, alcohol within the shop could encourage under age drinking
 4. Drunkenness could increase crime and public disorder in the area and also those on the route of individuals.

Please take my objections into account when reviewing this application.

Mr A Moon

Dear Sir/Madam

I am writing to object to the application by Mr. Muralitharan for a licence to sell alcohol from his shop premises at 288 Lonsdale Drive.

The shop has been part of the local community for some time and is located in a residential area. I do not see any reason why it would need to start selling alcohol from 7.00am until 11pm, seven days a week. There are several shops which sell alcohol in Parkwood and Rainham shopping areas, which are both a short walk away. I believe selling alcohol in this residential area will encourage anti-social behaviour, especially as there is a small green outside the shop which may encourage people to linger.

The shop has always been popular with the local residents, and I do not believe selling alcohol would make it more successful.

With regards

Trevor Felmingham

hopson, lisa

From: janet english
Sent: 29 October 2017 10:31
To: licensing
Subject: Lonsdale drive newsagents.

Dear Sir or Madam.

I noticed that an application has been submitted for a alcohol license and extended opening hours, with regard to the newsagents on Lonsdale drive Rainham.

I would like to object to this application for the following reason.

This is a residential area and although in object to more premises selling cheap alcohol, I understand that a business has to be competitive.

But I strongly object the over extended hours until 23:00 hrs seven days a week, no other premises open until that late hour, and I suggest that most of the late night sales will be Alcohol related.

The disturbance caused at the moment with cars coming and going is bearable because the premises shuts at 20:00 , but if the hours were allowed to be extended we would suffer severe disturbance to our lives.

Sincerely.

Janet English.

hopson, lisa

From: Graham Hunt
Sent: 30 October 2017 12:33
To: licensing
Subject: Objection to New Premises Licence for 288 Lonsdale Drive Rainham

Dear Sirs,

I am writing to you as a resident of Sunningdale Drive and therefore a local resident affected by the application made by Lonsdale Drive Newsagents, 288 Lonsdale Drive for a new premises licence.

I would advise you that in my view nothing has changed since a similar application was made in 2014. I would draw the panels attention to all the arguments put forward by a large number of local residents who objected to that application and state in my view nothing has changed, only that parking due to the three business in the row of shops located where 288 Lonsdale Drive is has actually got worse. I have discussed dangerous parking issues previously with my ward councillor and the local PCSO.

Given that the situation is broadly the same as 2014 I'd remind the panel of the previous decision namely...

Decision:

- (a) That the Panel grant the Premises Licence, but as permitted by law, the Panel impose conditions, as it considers appropriate for the promotion of the licensing objectives.
- (b) The Panel considered that it had heard sufficient evidence that the combination of the green public space with the position of the alcohol amounts to a honey pot in that area.
- (c) The congregation of individuals could amount to public nuisance as evidenced by the objectors. Not all congregation is public nuisance, but in the evening there is a greater risk of public nuisance.
- (d) The Panel therefore reduced the hours of opening to 06:00 hours to 20:00 hours Monday to Sunday and the supply of alcohol would also be 06:00 hours to 20:00 hours Monday to Sunday.
- (e) The Panel also agreed that a condition that commercial deliveries, collections and storage/disposal of waste and recyclables in external areas be restricted to between 08:00 hours and 18:00 hours be added to the Licence.

(source - <https://democracy.medway.gov.uk/mgAi.aspx?ID=9382>)

I'd ask the panel to once again consider the needs of the local residents in this predominantly residential area and impose similar restrictions on the hours of operation noting that operating late in the evening will potentially blight the area with traffic, noise, disturbance etc. issues. In particular I'd support a restriction on late night opening.

Regards Graham Hunt

Agenda item - Licensing Act 2003 New Application for a ...

democracy.medway.gov.uk

Medway Council is a unitary council responsible for providing services, including education and social services, in Rochester, Strood, Chatham, Gillingham, Rainham ...

Sent from Outlook

hopson, lisa

From: :
Sent: 30 October 2017 22:47
To: licensing
Subject: Licensing Act 2003 New Application for a Premises Licence - Objection

Re : Licensing Act 2003 New Application for a Premises Licence for Lonsdale Drive Newsagents, 288 Lonsdale Drive, Rainham, Gillingham, Kent ME8 9JU

I understand that it has been decided to grant a license for the sale of alcohol from the above premises.

As resident of Sunningdale Drive I wish lodge with you my objection to the granting of this licence on the grounds that refusing it would prevent a clear public nuisance which would otherwise occur through traffic issues on an already busy public highway and anti-social behaviour in a quiet residential area.

I would be grateful if you could kindly acknowledge receipt of my objection.

Kind regards
Steven Fleet

Date: Fri, 3 Nov 2017 10:30:42 +0000

Subject: 288 Lonsdale drive Licence to sell alcohol

Dear Sir/Madam,

Please accept this as my objection to the above, on the grounds that this is a residential area, already served by large supermarkets and smaller premises supplying alcohol, most of which close by 8p.m., some of which have already closed due to lack of demand.

As I live in Sunningdale Drive I have put up with litter from this shop, i.e. sweet wrappers and cans being deposited in my front garden. I have also had young people sitting on my wall making a nuisance of themselves and when being asked to move I have been told to f off and called a miserable old c!! which is very unpleasant. The last thing I need is for older youths purchasing alcohol for the underaged and what problems that may cause.

Add to this the problem of parking. Which is very limited. We already suffer from people using the hairdressers and tanning salon clogging up the area, making life difficult, therefore the possibility of people parking in the street to use the alcohol sales up to 23.00 hours, 7 days a week, opening and closing of car doors etc. will be a public nuisance.

I have lived in the area for 30 years and there has been several occasions where youths have used .oxborough woods to consume alcohol and drugs, and believe there was a meeting of residents, Police and Council to stop this, called the Barleycorn agreement and I feel that the granting of this licence could encourage this to happen again. With the present state of policing the likelihood of police attending any incidents is uncertain.

William Coad

hopson, lisa

From: MICHAEL WEST
Sent: 03 November 2017 12:37
To: licensing
Subject: Newsagents - 288 Lonsdale Drive ME8 9JU
Attachments: Newsagent Letter Nov 2017.odt

Dear Sir/Madam

Please find attached our objections to the above premises

Please acknowledge this email and keep us informed of any outcome.

Kind Regards

Michael and Myra West

Trading Name: Lonsdale Drive The Newsagent
Address: 288 Lonsdale Drive Rainham Kent ME8 9JU
Subject: Application for the sale of alcohol and extended opening hours

We are residents of Lonsdale Drive living directly opposite the premises concerned and wish to object on the following grounds.

Prevention of Public Nuisance

This is a quiet residential area where late night trading does not take place. We are already woken at 5.30 am every morning by the newspaper delivery van slamming doors. Having the premises open until 23.00 does not make the required amount of sleep stated by the government to keep us all healthy and would have a serious detrimental effect on residents. It would bring increased litter, car doors slamming, loud car radios. Wrappers, cigarette packets and drinks cans already appear on our front garden. Increased car headlights coming into our windows late at night. Our drive is often blocked by inconsiderate motorists. We have to look five ways to get off the drive – increased hours/parking would make this more hazardous.

Public Safety

Motorists parking on the pavements. This happens a great deal and mums with buggies/prams/wheelchair users and the elderly have to walk in the road. Vehicles are speeding on this road and again exiting our drive is hazardous. If someone has parked across our drive there is not enough room for buses to negotiate the traffic island and have to therefore drive on the right hand side of the island.

Prevention of Crime and Disorder

Selling of alcohol will encourage street drinking and vandalism. Breaking and entering of the premises has been carried out in the past. A gathering of people on the green fronting the premises would be noisy.

Protection of Children from Harm

Many children use the shop on their way to and from school and selling alcohol would expose them to it. Extra parking of vehicles would make the road more dangerous than it already is for children trying to cross.

This premises is a Newsagent and should not be allowed to change it's use and all the associated problems that will come with it. Any longer opening hours and the sale of alcohol are not needed.

We therefore please ask that the Council register our objections, hold a hearing and very strongly reject this application.

9 NOV 2017

6.11.17

To whom it may concern

I would like to object to the application for a liquor licence at the Newsagents at 286 Lonsdale Drive.

This is a residential area. We have previously had problems with youths congregating at the garage down from the newsagents.

I fear that granting a

licence would risk noise and potential disorder right on my doorstep.

The hairdressers and the beauty parlour are both closed at reasonable hours.

I feel that granting a licence will mean that there will be disruption, as the premises will obviously wish to extend their opening hours beyond 7-30pm.

Nowadays there are many premises/stores in the vicinity serving alcohol. We do not need another in this area.

Yours sincerely
KD Rutson

(MRS KATHRYN I RUTSON)

✓
hopson, lisa

From:
Sent: 06 November 2017 15:01
To: licensing
Subject: Objection to licence to sell alcohol
Attachments: alcohol licence.docx

Please find attachED objections to the proposed Licence to sell alcohol at Lonsdale Newsagent, 288 Lonsdale Drive, Gillingham ME8 9JU

Elizabeth McVeigh
James McVeigh

6th November 2017

Dear Sirs,

We are writing to object to the licence to sell alcohol at the above premise. We cannot see the need for the premises, which is in a residential area, to obtain such licence. There are already a number of outlets within a short walking distance where alcohol can be obtained, this number has already increased with the Co-op at Parkwood Shopping Centre now having such a licence and which is open until 22.00 every day. All the health guidelines are placing emphasis on the reduction of alcohol, surely another outlet is not required. Listed below are our objections under your guidelines.

Yours faithfully,

Elizabeth McVeigh

James McVeigh

**Objections to the Granting of a premises licence for the sale of alcohol at Lonsdale Drive
Newsagents, 288 Lonsdale Drive, Gillingham, Kent ME8 9JU**

1. Prevention of Crime and Disorder

The area of concern is that there will be nothing, other than CCTV at the premises to deter crime at the premises. We are concerned that there may be criminal activity, drawn to the area which is primarily a residential area, due to the consumption of alcohol and any related issues ie. Drug misuse, vandalism. The premise is a lock-up shop and therefore the key holder will not be around to take action if any of these problems occur during closing hours.

2. Prevention of Public Nuisance

I am particularly concerned that the opening hours are to be increased and that alcohol is to be sold daily from 06.00 – 23.00. This is a primarily residential area, with a high

proportion of senior citizens and will bring about an increase in noise, rubbish and litter and car parking.

There is already an issue with car parking, cars park as and where they wish, frequently directly opposite each other, or on corners, leaving very little space for a small vehicle to drive through, certainly not enough space should emergency services need to gain access.

The late noise issue is also a concern - at the moment the premises close at 8pm weekdays and 3pm Sunday, the sale of alcohol will inevitably bring about an increase in noise, car parking and litter up to the new proposed closing time of 23.00 on weekdays and also much more traffic and noise on a Sunday, which is a quiet time in the area.

Regarding litter, we frequently have to remove soft drinks cans and bottles, snack and food wrappers from the hedge which surrounds our garden, there is bound to be an increase in the litter.

3. Protecting children from harm

We are concerned that, as the premises are used by a great number of children on their way to and from school and at lunchtimes, they will be exposed to the alcohol and some will manage to obtain it, regardless of age checks. At the moment there is a great emphasis placed on reducing alcohol consumption, so surely opening another outlet is not a good step to take.

hopson, lisa

From: Stan Cokayne
Sent: 06 November 2017 15:13
To: licensing
Subject: Ojection to the Application for Alcohol Licence at 288 Lonsdale Drive, Raiham, Kent.

Dear Sirs,

I have seen the notice displayed in our local shop for an application to sale alcohol on the premises above and would expect it to be refused as it was when applied for in 2015/ 16.

I am surprised that this application has been made as surly the reasons it was refused have not change except that this time they have extended the opening time required to 17 hours each day which would encourage people particularly youngsters to congregate on the green that fronts the shop late at night.

This shop has always been used greatly by school children and it is a meeting point not just on school days but on the holidays. This can be in the late evenings which really gives me cause for concern as if alcohol is made available with young children being exposed to people drinking outside the shop this could well cause some of the younger children to try and look big drinking alcohol.

Parking is already a problem in and around the shop and Sunningdale Drive is only a two car width road which gets really congested with cars being parked partly on the foot path and some in haste park across driveways. This does cause confrontation and these arguments can get very heated which would make things far worse if stoked with alcohol.

There is already an Off Licence at Parkwood Shopping Center which has ample parking and is only some 15 minutes walk away from the Shop in question.

I assume the Police would have objected as the safety on young children these days must play an important part in there policing of areas such as these.

I strongly object to these premises being given a license to sale alcohol for the reason stated above although there are a number of other issues that I raised last time but these are to me the most important.

Kind regards
Stan Cokayne

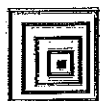

KENT DESIGN PARTNERSHIP ARCHITECT

Stan Cokayne, Rachel Fildes and Elizabeth Southey, 200 Lonsdale Drive, Raiham, Kent, ME11 6JN
Tel: 01795 844162 Fax: 01795 844163 Email: info@kentdesignpartnership.co.uk

Subject: Objections to the Granting of a premises license for the sale of alcohol at Lonsdale Drive Newsagents of 288 Lonsdale Drive Newsagents of 288 Lonsdale Drive Gillingham ME8 9Jo

Rosemary Mitchell
Barry Mitchell

I am writing on behalf of myself and my husband regarding the above issue.

PUBLIC SAFETY

The keeping of alcohol on the premises increases the risk of criminal activities, is a higher risk of fire due to the flammability of alcohol which would have serious affect on the residential properties in close proximity.

PROTECTION OF CHILDREN FROM HARM

There would be an increse in traffic flow and of parked vehicles along the residential streets where children walk to and from the local schools increasing the risk of accidents.

Many of the chidren and young adults use the premises on a daily basis and would be exposed to the temptation of alcohol.

PUBLIC NUISANCE

The increase in parking on residential streets as the premises has no parking facility brings added noise from car radios on at full blast, doors slamming for 17 hours per day 7 days a week. An increase in blocked access to residential properties and an increase in litter on streets and in gardens a problem already suffered by residents from cans and sweet wrappers.

A FINAL POINT

Our present government, the health service and i believe medway council all advocate the lessening of availability of alcohol, surely a license of sale at these premises would not help this situation

Rosemary Mitchell

hopson, lisa

From: Hilary Treays
Sent: 09 November 2017 08:17
To: licensing
Subject: Premises licence application, 288 Lonsdale Drive

We are writing to object to the granting of a premises licence to sell alcohol between 0600 and 2300, 7-days a week at the newsagents at 288 Lonsdale Drive, Rainham. Our objections are on the grounds of the nuisance, noise and litter that would result from the shop being open and selling alcohol all day, 7-days a week. The area immediately around the shop is all residential and many homes have young children. The area already attracts young people late at night standing around talking loudly and in their cars with music playing loudly. The granting of a licence to sell alcohol would make this worse.

Regards

David and Hilary Treays

f

Sent from my iPad

✓
Hello

We understand that an application to sell alcohol has been applied for at 288 Lonsdale Drive, Rainham, Kent.

We would like to state our objection to this.

There are many other retail outlets within walking distance that provide the facility to sell alcohol and I believe the times requested will provide a public nuisance.

We feel that the selling of alcohol will lead to crime and disorder only a short distance from our home and are worried about the safety of our family and the potential for crime and disorder and extra litter, especially outside our home where there is a public bus stop.

Kind Regards

Mr A J Brown and Mrs R Brown

hopson, lisa

From: licensing
Sent: 13 November 2017 09:06
To: hopson, lisa
Subject: FW: Objection to New Premises License - 288 Lonsdale Drive Rainham Kent

-----Original Message-----

From: Natalie Barnes
Sent: 09 November 2017 21:41
To: licensing
Subject: Objection to New Premises License - 288 Lonsdale Drive Rainham Kent

Hi,

I would like to make you aware of my objection to the intended opening hours of the above premises. I have recently found out that the applicant Priyashalini Muralitharan intends to be open 7 days a week 6am to 11pm and to sell alcohol during these times.

I live at 280 Lonsdale Drive, directly opposite this shop on the corner of Sunningdale Drive and these hours are totally unnecessary and not required in a quiet road like this. The majority of the residents in the surrounding area are either elderly or young families.

I have a 5 year old and a 15 month old, their bedrooms face this shop. We bought this house a year ago so they could grow up in a nice area facing a small newsagents. If these opening hours are agreed then they will be disturbed up until 11pm by cars turning up, slamming doors, people talking loudly. All this with my eldest having to go to school the next day.

An off licence open until this time will bring trouble to a quiet area, there is a large grass area out the front which will encourage older children to congregate causing noise and disturbance. The residents around here will not tolerate this and will not hesitate to call the police putting additional pressure on these resources.

If people need alcohol later in the evening there are already an abundance of shops in the surrounding roads for them to go to. Meirscourt farm shop, Londis Maidstone Road, Norreys Road, Co-op Parkwood. If they need food late at night they have these same shops.

I am not so much opposed to them selling alcohol as everywhere does now but the opening hours are ridiculous for this residential quiet street. 6am - 8pm Monday to Saturday and 7am - 4pm on a Sunday is more than reasonable.

Kind regards

Mrs Natalie Barnes

Sent from my iPhone

hopson, lisa

From: licensing
Sent: 13 November 2017 09:06
To: hopson, lisa
Subject: FW: New premises alcohol licence 288 Lonsdale Drive

From: woodcock mike [mailto:]
Sent: 09 November 2017 23:08
To: licensing
Subject: New premises alcohol licence 288 Lonsdale Drive

Dear Sir/Madam,

It has come to my attention that an application for a license to sell alcohol has been put forward for the Newsagent premises at 288 Lonsdale Drive between the hours of 6.00am and 11.00pm seven days a week.

I am extremely concerned that the granting of any such license would have serious, detrimental consequences for all local residents.

1. Prevention of crime and disorder.

Any stock of alcohol would represent a very tempting target for criminals, and the location of the premises with rear access, invisible from the main road, at rooftop level would make the possibility of forced entry very likely indeed. In fact within the last month the neighboring premises 'Tans-Trix' was broken into with the offenders gaining access by precisely that method.

2. Public safety.

Any stock of highly flammable alcohol would represent a serious fire risk endangering not only 288 but also the abutting buildings to which any fire would spread rapidly. The row of buildings in which the newsagent sits is situated in a high density residential area.

3. Prevention of public nuisance.

Were the License to be granted it would bring traffic and people, along with all the noise, litter etc associated with them, into a residential area in the early mornings and late into the night during hours when residents are sleeping. This would certainly cause both disturbance and nuisance. The grassed area in front of 288 already attracts occasional rowdy groups and the granting of a license would, without doubt, exacerbate and increase the problem. It would also increase the amount of parking problems associated with visitors to the newsagent. Cars and vans regularly park across the driveway of my property whilst the occupants of the vehicles rush across the road to visit the newsagent/shop. Not only does this obstruct the driveway to my property and prevent my vehicle's exit but it also creates problems for any vehicles trying to weave their way between the parked vehicle and the traffic island situated directly in front of my property. I have seen many instances where larger vehicles such as buses and lorries have been forced to stop on the carriageway and await the return of the driver of the obstructing vehicle.

4. Protection of children from harm.

It should be noted that the location of the premises on a busy route to the local school means that many children visit regularly. This raises the possibility of attempts by underage individuals to purchase alcohol should the license be granted.

I trust that my views will be taken into account when considering the license application.

Yours Sincerely

Mr. M.G. Woodcock

hopson, lisa

From: .>
Sent: 13 November 2017 12:01
To: , michelle.steward@medway.gov.uk; licensing
Subject: Fw: Licensing Act 2003 -Application for Premises Licence - (288) Lonsdale Drive Newsagents

Importance: High

Dear Don,

Please accept my apologies for the delayed note to you with regards to the recent alcohol application for 288 Lonsdale Drive

Similarly to my previous, below, rejection of this application I state my reasons again

- 1) The shop already draws in crowds that gather making noise and litter the areas. Alcohol being sold all day or indeed at all will only draw in more teenagers and with an escalation of anti social behavior.
- 2) I have 2 children who are at the age where they will be able to go to the sweet shop with minimal supervision, the increased traffic and number of cars parked will increase the risk of harm to my children with the cross junction here.

The significant lack of parking spaces will mean that the increased customer numbers will now being parking in unsafe places or be forced to park across residents own parking bays

- 3) As I mentioned in point 1, we have increased loitering, noise and litter in the area as a result of the shop already, should alcohol licence be granted then we can see a significant increase in the above. We also understand that the coop in parkwood and adjacent Martin has been granted a licence, so do not see why this licence is required.

- 4) The protection of my children is paramount in all of this and we have litter thrown into our front and back garden with lots of noise and swearing.

I am totally against our local newsagents (they call the sweet shop), from becoming a teenage meeting point with all that comes with it.

Along with all of the local residents we do not want this application to be accepted by the council.

Regards

Mr & Mrs O' Shea

From:
Sent: 17 October 2017 15:26
To: lee oshea
Subject: Fw: Licensing Act 2003 -Application for Premises Licence - (288) Lonsdale Drive Newsagents

23 NOV 2017

Ms M. Bennett.

23rd November 2017

The Manager,
Licensing Department,
Medway Council,
Gun Wharf, Dock Road,
Chatham, Kent
ME4 4TR

By Hand

Dear Sir,

Newsagent's Application for 288 Lonsdale Drive, Rainham, Kent premises to sell Alcohol and increase the opening hours to 07.00 hrs - 23.00 hrs Monday to Sunday inclusive

I am writing to register my objection to this application.

We already have a problem with empty alcohol bottles being dropped and broken on the pavements, empty beer cans, and bottles being thrown into front gardens, or pushed into hedges. This can only get worse if another sales outlet for drinks is to open.

Sunningdale Drive forms a T-junction with Lonsdale Drive. Access to the 288 Lonsdale Drive premises is via a slip road cutting the corner of Lonsdale Drive and Sunningdale Drive junction on the Parkwood side. There is a triangular area of grass between the shop and the junction. This is primarily a quiet residential area, consisting mainly of families with young school children, and most shops with licences to sell liquor in the vicinity, mainly Parkwood and Wigmore, close at 9.00pm. So, if this application is granted and attracts custom from these other areas the increase in traffic is likely to cause noise nuisance from car engines, doors banging, and possibly loud voices. In winter the position will also be aggravated by sweeping car headlights as they use the slip road to turn and return in the direction from which they have come.

The junction of Sunningdale Drive and Lonsdale Drive is near a traffic-calming island. This island has reduced the width of Lonsdale Drive here. In the Rainham direction of Lonsdale Drive at this junction there are usually parked cars on either side of the road, so cars driving towards Parkwood, and out of Sunningdale sometimes pass the traffic island on the wrong side. In the past, parked cars have been damaged by traffic on Lonsdale Drive and a pedestrian knocked over. Any increase in traffic is likely to exacerbate the situation.

Whilst I would not wish to prevent the benefits to the community, that a local business can bring, or to impair the viability of that business, I do also question the need for late night openings Monday to Sunday inclusive.

I feel that, if the licence is to be granted, the times should be amended to no later than 9.00pm on all days.

Yours faithfully

Ms M. Bennett

Medway Switch & Save

A 100% impartial energy switching site.

This message is intended only for the use of person(s) ("the intended recipient(s)") to whom it is addressed. It may contain information which is privileged and confidential within the meaning of the law. If you are not the intended recipient, please contact the sender as soon as possible. The views expressed in this communication may not necessarily be the views of Medway Council.

From: Paul Rutson [mailto:]
Sent: 30 November 2017 12:54
To: licensing
Subject: Oppose alcohol licence for 288 Lonsdale Drive Rainham

To Lisa Hopson (Licensing Officer)

I would like to object to this on the grounds that this has already been refused once and nothing has changed.

This is a residential area and the few shops are not open late.

It would cause an increase in traffic and thus nuisance.

There is no shortage of off licence facilities in the area.

The biggest fear is that it will cause youths to congregate in that area bringing more nuisance to the community.

yours sincerely

Paul Rutson

This transmission is intended for the named addressee(s) only and may contain sensitive or protectively marked material up to RESTRICTED and should be handled accordingly. Unless you are the named addressee (or authorised to receive it for the addressee) you may not copy or use it, or disclose it to anyone else. If you have received this transmission in error please notify the sender immediately. This email has been scanned for viruses and all reasonable precautions have been taken to ensure that none are present. Medway Council cannot accept responsibility for any loss or damage arising from the use of this email or attachments. Any views expressed in this email are those of the individual sender and not necessarily those of Medway Council unless explicitly stated. Please be aware that emails sent to or received from Medway Council may be subject to recording and/or monitoring.