

LICENSING HEARING PANEL

14 MARCH 2017

LICENSING ACT 2003 APPLICATION FOR A NEW PREMISES LICENCE PIER 5 BAR & KITCHEN, PIER 5, THE QUAYS, DOCK HEAD ROAD, CHATHAM, KENT ME4 4ZJ

Report from: Perry Holmes, Chief Legal Officer

Author: Mandy Francis, Principal Licensing and Enforcement Officer

Summary

The applicant has applied for a new premises licence for Pier 5 Bar & Kitchen, Pier 5, The Quays, Dock Head Road, Chatham, Kent ME4 4ZJ.

The application is to request recorded music indoors, the provision of late night refreshment indoors and the sale of alcohol on and off the premises.

All responsible authorities have been consulted in line with the Licensing Act 2003.

Following discussion held between Shepherd Neame and representatives of Marina Point West Residents Association, the applicant has amended the opening hours stated in the original application.

A representation in relation to the prevention of public nuisance has been received from a member of the public and to date, no agreement has been reached.

No further representations have been received from other members of the public or responsible authorities.

1. The current application

1.1 In accordance with the Licensing Act 2003, the Council has received an application for a new premises licence in respect of Pier 5 Bar & Kitchen, Pier 5, The Quays, Dock Head Road, Chatham, Kent ME4 4ZJ.

1.2 The details of the application requirements, which include the amendment to the opening hours of the premises are as follows:

Recorded Music – Indoors

Monday to Sunday 10:00 – 00:00

Non Standard timings – From the end of permitted hours on New Year's Eve and to the start of permitted hours on New Year's Day.

Late Night Refreshment – Indoors

Monday to Sunday 23:00 – 00:00

Non Standard timings – From the end of permitted hours on New Year's Eve and to the start of permitted hours on New Year's Day.

Sale of Alcohol – On and off the premises

Monday to Sunday 10:00 – 00:00

Non Standard timings – From the end of permitted hours on New Year's Eve and to the start of permitted hours on New Year's Day.

Hours the premises are open to the public for Licensable Activities

Monday to Sunday 10:00 – 00:15

The premises may open outside authorised hours for non-licensable activities subject to planning or other legislation.

- 1.3 A copy of the application as submitted is at Appendix A.
- 1.4 The application has been correctly advertised in the local press and notices displayed on the premises for the required period.
- 1.5 All responsible authorities have been consulted in line with the Licensing Act 2003.
- 1.6 Details of the amendments to the original application are attached at Appendix B
- 1.7 A copy of the floor plan is attached at Appendix C.
- 1.8 A copy of a map showing the location of the premises is at Appendix D

2. Background

- 2.1 As stated at paragraph 1.2 this is an application for a new premises licence requesting the recorded music indoors, the provision of late night refreshment indoors and the sale of alcohol on and off the premises.
- 2.2 Following discussion held between Shepherd Neame (the applicant) and representatives of Marina Point West Residents Association, the applicant has amended the opening hours in the original application by reducing the time of closing to 00:15 instead of 00:30.

- 2.3 A representation relating to prevention of public nuisance licensing objective has been received from a member of the public (copy attached at Appendix E); to date no agreement has been reached. No further representations have been received from other members of the public or responsible authorities.

3. Promotion of Licensing Objectives

- 3.1 The applicant is expected to demonstrate that they have dealt with the promotion of the four licensing objectives, where appropriate. Members are referred to Section 18 of the application at Appendix A where the applicant has referred to this issue.

- 3.2 The four licensing objectives are:

- the prevention of crime and disorder
- public safety
- the prevention of public nuisance
- the protection of children from harm

4. Relevant Representations

- 4.1 This matter has been put to the Licensing Hearing Panel because the Council has received a representation from a member of the public, which in part, relates to the prevention of public nuisance objective. To date no agreement has been reached. A copy of this is attached at Appendix E.

5. Policy Considerations

- 5.1 Medway Council has published its Statement of Licensing Policy, which it will consider alongside the amended Guidance issued by the Home Office under section 182 of the Licensing Act 2003 in all applications.
- 5.2 In determining this application, Members may wish to consider information contained in Appendix 4 to the Statement of Licensing Policy that lists examples of good practice against the four licensing objectives as well as Chapters 9 and 10 of the amended Guidance.
- 5.3 The objection raised in the representation received relates to the prevention of public nuisance licensing objective.

6. Risk Management

- 6.1 The Council has to consider and determine this application, which is a function relating to licensing and registration as set out in Schedule 1 to the Functions Regulations, the Licensing Act 2003, the Gambling Act 2005 and other licensing functions reserved by law to the Council's Licensing and Safety Committee and its Sub-Committees, in accordance with the law (both statutory and case law), relevant statutory guidance and statements of policy.

7. Financial and legal implications

- 7.1 There are no direct financial or legal implications at this time.
- 7.2 This hearing is regulated by the Licensing Act 2003 (Hearings) Regulations 2005 (as amended).
- 7.3 There is the possibility of a challenge by way of appeal to the decision by either the applicant or objectors should either have the requisite grounds to do so. Legal advice will be given to Members as appropriate at the meeting. However, whatever the decision of the Panel, this must be based on the evidence placed before it in line with the licensing objectives and the Panel must decide what weight to attribute to this information.

8. Recommendation

- 8.1 That the Panel considers and determines this application.

Lead officer contact: Mandy Francis – Principal Licensing and Enforcement Officer
Telephone: 01634 337108
Email: mandy.francis@medway.gov.uk

Appendices

Appendix A – Copy of the application as submitted
Appendix B – Details of the amendments to the application operating schedule
Appendix C – A copy of the floor plan
Appendix D – A copy of a map showing the location of the premises
Appendix E – A copy of representation received from a member of the public

Background Papers

None

Medway Council

Application for a premises licence to be granted
under the Licensing Act 2003

PLEASE READ THE FOLLOWING INSTRUCTIONS FIRST

Before completing this form please read the guidance notes at the end of the form.

If you are completing this form by hand please write legibly in block capitals. In all cases ensure that your answers are inside the boxes and written in black ink. Use additional sheets if necessary.

You may wish to keep a copy of the completed form for your records.

We Shepherd Neame Limited

apply for a premises licence under section 17 of the Licensing Act 2003 for the premises described in Part 1 below (the premises) and I/we are making this application to you as the relevant licensing authority in accordance with section 12 of the Licensing Act 2003

Part 1 – Premises Details

Postal address of premises or, if none, ordnance survey map reference or description			
Pier 5 Bar & Kitchen Pier 5 The Quays Dock Head Road			
Post town	Chatham	Post code	ME4 4ZJ
Telephone number at premises (if any)			
Non-domestic rateable value of premises		Under construction	

Part 2 - Applicant Details

Please state whether you are applying for a premises licence as

Please tick yes

- | | | |
|---|-------------------------------------|-----------------------------|
| a) an individual or individuals * | <input type="checkbox"/> | please complete section (A) |
| b) a person other than an individual * | | |
| i. as a limited company | <input checked="" type="checkbox"/> | please complete section (B) |
| ii. as a partnership | <input type="checkbox"/> | please complete section (B) |
| iii. as an unincorporated association or | <input type="checkbox"/> | please complete section (B) |
| iv. other (for example a statutory corporation) | <input type="checkbox"/> | please complete section (B) |
| c) a recognised club | <input type="checkbox"/> | please complete section (B) |
| d) a charity | <input type="checkbox"/> | please complete section (B) |
| e) the proprietor of an educational establishment | <input type="checkbox"/> | please complete section (B) |
| f) a health service body | <input type="checkbox"/> | please complete section (B) |
| g) a person who is registered under Part 2 of the Care Standards Act 2000 (c14) in respect of an independent hospital | <input type="checkbox"/> | please complete section (B) |
| ga) a person who is registered under Chapter 2 of Part 1 of the Health and Social Care Act 2008 (within the meaning of that Part) in an independent hospital in England | <input type="checkbox"/> | please complete section (B) |
| h) the chief officer of police of a police force in England and Wales | <input type="checkbox"/> | please complete section (B) |

* If you are applying as a person described in (a) or (b) please confirm:

Please tick yes

- I am carrying on or proposing to carry on a business which involves the use of the premises for licensable activities; or ☒
- I am making the application pursuant to a
 - statutory function or ☐
 - a function discharged by virtue of Her Majesty's prerogative ☐

(A) INDIVIDUAL APPLICANTS (fill in as applicable)

Mr <input type="checkbox"/>	Mrs <input type="checkbox"/>	Miss <input type="checkbox"/>	Ms <input type="checkbox"/>	Other Title (for example, Rev)	
Surname			First names		
I am 18 years old or over					<input type="checkbox"/> Please tick yes
Current postal address if different from premises address					
Post Town				Postcode	
Daytime contact telephone number					
E-mail address (optional)					

SECOND INDIVIDUAL APPLICANT (if applicable)

Mr <input type="checkbox"/>	Mrs <input type="checkbox"/>	Miss <input type="checkbox"/>	Ms <input type="checkbox"/>	Other Title (for example, Rev)	
Surname			First names		
I am 18 years old or over					<input type="checkbox"/> Please tick yes
Current postal address if different from premises address					
Post Town				Postcode	
Daytime contact telephone number					
E-mail address (optional)					

(B) OTHER APPLICANTS

Please provide name and registered address of applicant in full. Where appropriate please give any registered number. In the case of a partnership or other joint venture (other than a body corporate), please give the name and address of each party concerned.

Name Shepherd Neame Limited
Address 17 Court Street Faversham Kent ME13 7AX
Registered number (where applicable) 00138256
Description of applicant (for example, partnership, company, unincorporated association etc.) Private limited company
Telephone number (if any)
E-mail address (optional)

Part 3 Operating Schedule

When do you want the premises licence to start?

Day	Month	Year
A	S	A
P		

If you wish the licence to be valid only for a limited period, when do you want it to end?

Day	Month	Year

A

Please give a general description of the premises (please read guidance note1)

This is a new purpose built, ground floor unit which will operate a bar serving food and drink. The ground floor unit includes customer area, a kitchen, other back of house facilities and customer toilets within the Pier 5 shopping and leisure centre. The proposed premises licence is in line with the Provisional Statement granted to Byrne Estates (Chatham) Limited for this site in August 2008.

Shepherd Neame are an established and reputable Kent-based operator and brewery, operating a diverse range of sites with more than 300 pubs and hotels across London and the South East.

If 5,000 or more people are expected to attend the premises at any one time, please state the number expected to attend.

N/A

What licensable activities do you intend to carry on from the premises?

(Please see sections 1 and 14 of the Licensing Act 2003 and Schedules 1 and 2 to the Licensing Act 2003)

Provision of regulated entertainment

Please tick yes

- a) plays (if ticking yes, fill in box A)
b) films (if ticking yes, fill in box B)

<input type="checkbox"/>
<input type="checkbox"/>

- c) indoor sporting events (if ticking yes, fill in box C) ☐
- d) boxing or wrestling entertainment (if ticking yes, fill in box D) ☐
- e) live music (if ticking yes, fill in box E) ☐
- f) recorded music (if ticking yes, fill in box F) ☒
- g) performances of dance (if ticking yes, fill in box G) ☐
- h) anything of a similar description to that falling within (e), (f) or (g) (if ticking yes, fill in box H) ☐

Provision of late night refreshment (if ticking yes, fill in box I) ☒

Supply of alcohol (if ticking yes, fill in box J) ☒

In all cases complete boxes K, L and M

A

Plays Standard days and timings (please read guidance note 6)			Will the performance of a play take place indoors or outdoors or both – please tick (please read guidance note 2)	Indoors	<input type="checkbox"/>
Day	Start	Finish		Outdoors	<input type="checkbox"/>
Mon			Please give further details here (please read guidance note 3)	Both	<input type="checkbox"/>
Tue					
Wed					
Thur			State any seasonal variations for performing plays (please read guidance note 4)		
Fri					
Sat					
Sun			Non standard timings. Where you intend to use the premises for the performance of plays at different times to those listed in the column on the left, please list (please read guidance note 5)		

B

Films Standard days and timings (please read guidance note 6)			Will the exhibition of films take place indoors or outdoors or both – please tick (please read guidance note 2)	Indoors	<input type="checkbox"/>
Day	Start	Finish		Outdoors	<input type="checkbox"/>
Mon			Please give further details here (please read guidance note 3)	Both	<input type="checkbox"/>
Tue					
Wed					
Thur			State any seasonal variations for the exhibition of films (please read guidance note 4)		
Fri					
			Non standard timings. Where you intend to use the premises for the exhibition of films at different times to those listed in the column on the left,		

Sat			<u>please list</u> (please read guidance note 5)
Sun			

C

Indoor sporting events Standard days and timings (please read guidance note 6)			<u>Please give further details</u> (please read guidance note 3)
Day	Start	Finish	
Mon			
Tue			<u>State any seasonal variations for indoor sporting events</u> (please read guidance note 4)
Wed			
Thur			<u>Non standard timings. Where you intend to use the premises for indoor sporting events at different times to those listed in the column on the left, please list</u> (please read guidance note 5)
Fri			
Sat			
Sun			

D

Boxing or wrestling entertainments Standard days and timings (please read guidance note 6)			Will the boxing or wrestling entertainment take place indoors or outdoors or both – please tick (please read guidance note 2)	Indoors <input checked="" type="checkbox"/>
Day	Start	Finish		Outdoors <input type="checkbox"/>
Mon				Both <input type="checkbox"/>
Tue			<u>Please give further details here</u> (please read guidance note 3)	
Wed			<u>State any seasonal variations for boxing or wrestling entertainment</u> (please read guidance note 4)	
Thur				
Fri			<u>Non standard timings. Where you intend to use the premises for boxing or wrestling entertainment at different times to those listed in the column on the left, please list</u> (please read guidance note 5)	
Sat				
Sun				

E

Live music Standard days and timings (please read guidance note 6)			Will the performance of live music take place indoors or outdoors or both – please tick (please read guidance note 2)	Indoors	<input checked="" type="checkbox"/>
				Outdoors	<input type="checkbox"/>
				Both	<input type="checkbox"/>
Day	Start	Finish	Please give further details here (please read guidance note 3)		
Mon					
Tue					
Wed					
Thur			State any seasonal variations for the performance of live music (please read guidance note 4)		
Fri					
Sat					
Sun					
			Non standard timings. Where you intend to use the premises for the performance of live music at different times to those listed in the column on the left, please list (please read guidance note 5)		

F

Recorded music Standard days and timings (please read guidance note 6)			Will the playing of recorded music take place indoors or outdoors or both – please tick (please read guidance note 2)	Indoors	<input checked="" type="checkbox"/>
				Outdoors	<input type="checkbox"/>
				Both	<input type="checkbox"/>
Day	Start	Finish	Please give further details here (please read guidance note 3)		
Mon	10:00	00:00			
Tue	10:00	00:00			
Wed	10:00	00:00			
Thur	10:00	00:00	State any seasonal variations for the playing of recorded music (please read guidance note 4)		
Fri	10:00	00:00			
Sat	10:00	00:00			
Sun	10:00	00:00			
			Non standard timings. Where you intend to use the premises for the playing of recorded music at different times to those listed in the column on the left, please list (please read guidance note 5)		
			From the end of permitted hours on New Year's Eve to the start of permitted hours on New Year's Day.		

G

Performances of dance Standard days and timings (please read guidance note 6)			<u>Will the performance of dance take place indoors or outdoors or both – please tick</u> (please read guidance note 2)		Indoors	<input checked="" type="checkbox"/>
					Outdoors	<input type="checkbox"/>
					Both	<input type="checkbox"/>
Day	Start	Finish				
Mon			<u>Please give further details here</u> (please read guidance note 3)			
Tue						
Wed			<u>State any seasonal variations for the performance of dance</u> (please read guidance note 4)			
Thur						
Fri			<u>Non standard timings. Where you intend to use the premises for the performance of dance at different times to those listed in the column on the left, please list</u> (please read guidance note 5)			
Sat						
Sun						

H

Anything of a similar description to that falling within (e), (f) or (g) Standard days and timings (please read guidance note 6)			<u>Please give a description of the type of entertainment you will be providing</u>			
Day	Start	Finish	<u>Will this entertainment take place indoors or outdoors or both – please tick</u> (please read guidance note 2)		Indoors	<input type="checkbox"/>
Mon					Outdoors	<input type="checkbox"/>
					Both	<input type="checkbox"/>
Tue			<u>Please give further details here</u> (please read guidance note 3)			
Wed						
Thur			<u>State any seasonal variations for entertainment of a similar description to that falling within (e), (f) or (g)</u> (please read guidance note 4)			
Fri						
Sat			<u>Non standard timings. Where you intend to use the premises for the entertainment of a similar description to that falling within (e), (f) or (g) at different times to those listed in the column on the left, please list</u> (please read guidance note 5)			
Sun						

Late night refreshment Standard days and timings (please read guidance note 6)			Will the provision of late night refreshment take place indoors or outdoors or both – please tick (please read guidance note 2)	Indoors	<input checked="" type="checkbox"/>
				Outdoors	<input type="checkbox"/>
				Both	<input type="checkbox"/>
Day	Start	Finish	Please give further details here (please read guidance note 3) Provision of hot food and drink.		
Mon	23:00	00:00			
Tue	23:00	00:00	State any seasonal variations for the provision of late night refreshment (please read guidance note 4)		
Wed	23:00	00:00			
Thur	23:00	00:00	Non standard timings. Where you intend to use the premises for the provision of late night refreshment at different times, to those listed in the column on the left, please list (please read guidance note 5)		
Fri	23:00	00:00			
Sat	23:00	00:00	From the end of permitted hours on New Year's Eve to the start of permitted hours on New Year's Day.		
Sun	23:00	00:00			

Supply of alcohol Standard days and timings (please read guidance note 6)			Will the supply of alcohol be for consumption (Please tick box) (please read guidance note 7)	On the premises	<input type="checkbox"/>
				Off the premises	<input type="checkbox"/>
				Both	<input checked="" type="checkbox"/>
Day	Start	Finish	State any seasonal variations for the supply of alcohol (please read guidance note 4)		
Mon	10:00	00:00			
Tue	10:00	00:00	Non standard timings. Where you intend to use the premises for the supply of alcohol at different times to those listed in the column on the left, please list (please read guidance note 5)		
Wed	10:00	00:00			
Thur	10:00	00:00	From the end of permitted hours on New Year's Eve to the start of permitted hours on New Year's Day.		
Fri	10:00	00:00			
Sat	10:00	00:00			
Sun	10:00	00:00			

State the name and details of the individual whom you wish to specify on the licence as premises supervisor

Name

Address	
Postcode	TN15 7LU
Personal Licence number (if known)	
Issuing licensing authority (if known)	

K

Please highlight any adult entertainment or services, activities, other entertainment or matters ancillary to the use of the premises that may give rise to concern in respect of children (please read guidance note 8)

None

L

Hours premises are open to the public Standard days and timings (please read guidance note 6)			State any seasonal variations (please read guidance note 4)
Day	Start	Finish	
Mon	10:00	00:30	Non standard timings. Where you intend the premises to be open to the public at different times from those listed in the column on the left, please list (please read guidance note 5)
Tue	10:00	00:30	
Wed	10:00	00:30	
Thur	10:00	00:30	
Fri	10:00	00:30	
Sat	10:00	00:30	
Sun	10:00	00:30	

M Describe the steps you intend to take to promote the four licensing objectives:

a) General – all four licensing objectives (b,c,d,e) (please read guidance note 9)

The information provided in this box is solely for information only and not intended to be converted into conditions on the licence.

As stated above, the applicant, Shepherd Neame, are an established Kent-based operator with more than 300 pubs and hotels across London and the South East. The applicant therefore has extensive experience running a wide range of licensed premises and successfully promoting the licensing objectives.

The proposed operation is for a ground floor bar and kitchen to complement the existing retail and leisure space at Pier 5 and to provide the local community with a new venue operated by a local, historic brewery. The premises is comprised of an open internal bar area and an external seating area, as shown on proposed licence drawing number 93.01/A.02 submitted with this application.

We have considered the impact of the proposed new premises licence in conjunction with Medway Council's Licensing Policy, including the Examples of Good Practice for Licensed Premises. With this in mind we have prepared the operating schedule detailed below and do not consider further steps will be required to promote the licensing objectives.

In particular, the applicant has regard for the proactive and preventative approach required for the prevention of crime and disorder and is therefore offering conditions to ensure that staff are appropriately trained to prevent underage and irresponsible sales of alcohol and also for an adequate CCTV system to be in place.

In relation to the prevention of public nuisance, the applicant has taken into account the proximity of the residential community at Marina Point West and would seek to minimise the level of noise by restricting the disposal of glass bottles to between 7am and 11pm and also by ensuring customers are made aware of the need to recognise the rights of local residents when leaving the premises.

Furthermore, the applicant is not seeking any additional licensable activities or hours to those stated in the Provisional Statement granted for this premises, a copy of which is attached.

b) The prevention of crime and disorder

1. A CCTV system shall be installed at the premises and maintained in good working order and used at all times when the premises are open for licensable activities. Any CCTV footage shall be held for at least 28 days and shall be made available to an officer of the Licensing Authority or Police on reasonable request.
2. An incident and refusals log, which may be electronic, will be kept on the premises and be made available for inspection by responsible authorities. The incident and refusal book will be used to record the following:
 - a) Any incident of violence or disorder on or immediately outside the premises.
 - b) Any incident involving drugs (supply/possession/influence) on the premises.
 - c) Any other crime or criminal activity on the premises.
 - d) Any refusal to serve alcohol to persons who are drunk.
 - e) Any refusal to serve alcohol to under 18's or anyone who appears under 18.
 - f) Any call for police assistance to the premises.
 - g) Any ejection from the premises.

c) Public safety

We understand our obligations under existing legislation, and take our responsibilities seriously.

d) The prevention of public nuisance

3. The placing of bottles into receptacles outside the premises shall only be permitted to take place between the hours of 07:00 and 23:00 to minimise disturbance to nearby properties.
4. The premises licence holder shall ensure that reasonable steps are taken to recognise the needs of the local residents and/or businesses and to encourage customers to leave the premises quietly.
5. Notices will be displayed at the premises exits requesting customers to leave quietly and reminding them that they are in a residential area.

e) The protection of children from harm

6. A proof of age scheme such as Challenge 21 will be operated at the premises where the only acceptable forms of identification are photographic identification cards such as a driving licence or passport.
7. Prior to being permitted to undertake the sale of alcohol, all staff without a personal licence will be trained in their responsibilities under the Licensing Act 2003 and any subsequent amendments to that Act - in particular they will receive training with regard to the service of alcohol to persons who are drunk.

Please tick yes

- I have made or enclosed payment of the fee or ☒
- I have not made or enclosed payment of the fee because the application has been made in relation to the introduction of the late night levy ☐
- I have enclosed the plan of the premises ☒
- I have sent copies of this application and the plan to responsible authorities and others where applicable ☒
- I have enclosed the consent form completed by the individual I wish to be designated premises supervisor, if applicable ☒
- I understand that I must now advertise my application ☒
- I understand that if I do not comply with the above requirements my application will be rejected ☒

IT IS AN OFFENCE, LIABLE ON CONVICTION TO A FINE UP TO LEVEL 5 ON THE STANDARD SCALE, UNDER SECTION 158 OF THE LICENSING ACT 2003 TO MAKE A FALSE STATEMENT IN OR IN CONNECTION WITH THIS APPLICATION

Part 4 – Signatures (please read guidance note 10)

Signature of applicant or applicant's solicitor or other duly authorised agent (See guidance note 11). **If signing on behalf of the applicant please state in what capacity.**

Signature	Poppleston Allen
Date	21st December 2016
Capacity	Poppleston Allen – Solicitors for and on behalf of the applicant

For joint applications signature of 2nd applicant or 2nd applicant's solicitor or other authorised agent. (please read guidance note 12). **If signing on behalf of the applicant please state in what capacity.**

Signature	
Date	
Capacity	

Contact name (where not previously given) and postal address for correspondence associated with this application (please read guidance note 13) Poppleston Allen Solicitors The Stanley Building 7 Pancras Square			
Post town	London	Post code	N1C 4AG
Telephone number (if any)	0203 859 7753		
If you would prefer us to correspond with you by e-mail your e-mail address (optional) @popall.co.uk			

Notes for Guidance

1. Describe the premises. For example the type of premises, its general situation and layout and any other information which could be relevant to the licensing objectives. Where your application includes off-supplies of alcohol and you intend to provide a place for consumption of these off-supplies you must include a description of where the place will be and its proximity to the premises.
2. Where taking place in a building or other structure please tick as appropriate. Indoors may include a tent.
3. For example the type of activity to be authorised, if not already stated, and give relevant further details, for example (but not exclusively) whether or not music will be amplified or unamplified.
4. For example (but not exclusively), where the activity will occur on additional days during the summer months.
5. For example (but not exclusively), where you wish the activity to go on longer on a particular day e.g. Christmas Eve.
6. Please give timings in 24 hour clock (e.g. 16:00) and only give details for the days of the week when you intend the premises to be used for the activity.
7. If you wish people to be able to consume alcohol on the premises please tick on, if you wish people to be able to purchase alcohol to consume away from the premises please tick off. If you wish people to be able to do both please tick both.
8. Please give information about anything intended to occur at the premises or ancillary to the use of the premises which may give rise to concern in respect of children, regardless of whether you intend children to have access to the premises, for example (but not exclusively) nudity or semi-nudity, films for restricted age groups, the presence of gaming machines.
9. Please list here steps you will take to promote all four licensing objectives together.
10. The application form must be signed.
11. An applicant's agent (for example solicitor) may sign the form on their behalf provided that they have actual authority to do so.
12. Where there is more than one applicant, both applicants or their respective agents must sign the application form.
13. This is the address which we shall use to correspond with you about this application.

Please Contact: Licensing Unit should you require further information

Your Ref:

Our Ref: 763

Date: 8 September 2008



Byrne Estates (Chatham) Limited
Byrne House
Jeffreys Road
Brimsdown
Enfield
Middlesex EN3 7UB

Pw V

Licensing Unit
Business Support Department
Gun Wharf, Dock Road
Chatham, Kent ME4 4TR
Telephone: (01634) 337110
Fax: (01634) 333548
Email: licensing@medway.gov.uk

This letter is available in larger print size if required. Please contact the author of this letter.

Dear Sir/Madam,

Licensing Act 2003

Provisional Statement - Site J5 South, Chatham Maritime

Your provisional statement has been granted as of 7 August on the following basis:-

Licensable Activities

Sale of Alcohol and Recorded Music

Monday to Sunday 10:00 to 24:00

New Years Eve to end of hours on New Years Day

Late Night Refreshment

Monday to Sunday 23:00 to 24:00

New Years Eve to end of hours on New Years Day

Conditions

1. The use of each unit is strictly managed by the developer. In respect of each individual unit, as and when let to an individual company, the relevant company must also apply for a Premises Licence to cover that specific unit.
2. CCTV to be installed externally, with an incorporated recording facility, so as to cover communal areas and maintained in good working order (in accordance with CCTV Code of Practice). Recordings to be stored for one calendar month. The CCTV system to be fully operational throughout the hours that the premises are open for any licensable activity. CCTV to ensure good coverage of all external public areas. Access to systems and recordings to be made available to Police and Local Authority officers on request.

Plans

Drawing Numbers

CO(80) 450, CO(80) 451, CO(80) 452, CO(80) 453, CO(80) 454, CO(80) 455, CO(80) 456,
CO(80) 457, CO(80) 458, CO(80) 459, CO(80) 460, CO(80) 461, CO(80) 462, CO(80) 463,
CO(80) 464.



2007-2008
Supporting New Dealings



INVESTOR IN PEOPLE

No relevant representations were made in relation to this application.

Yours faithfully

Lynsey Keen
Senior Licensing & Enforcement Officer

hopson, lisa

From: /@popall.co.uk>
Sent: 19 January 2017 16:58
To: hopson, lisa
Cc: George Domleo
Subject: RE: Pier 5 Bar & Kitchen Licence application

Dear Lisa

Many thanks for sending this information over.

I can confirm that my client has agreed to amend the opening hours sought in the application to finish at 00:15 (instead of 00:30) hours.

I look forward to receiving the representation and if I can assist in the meantime please do contact me.

Kind regards

Helen

Helen Cardy | Solicitor

Poppleston Allen

E: @popall.co.uk | T: 0203 859 7751 | W: www.popall.co.uk

London Office: The Stanley Building, 7 Pancras Square, London, N1C 4AG

NOTE: Our London office has moved!

The Stanley Building
 7 Pancras Square
 London N1C 4AG

Tel: 0203 859 7760

[View location](#) 

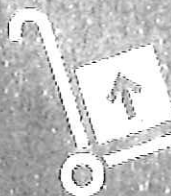

From: hopson, lisa [mailto:lisa.hopson@medway.gov.uk]

Sent: 19 January 2017 12:57

To: George Domleo

Subject: FW: Pier 5 Bar & Kitchen Licence application

Good morning George,

Please see email and attachment. I await your comments. Please note we have received a valid objection we are awaiting further details from the objector and it will be forwarded to you in due course.

Kind Regards,

Lisa.

Lisa Hopson

Licensing Officer
Medway Council
Gun Wharf
Dock Road
Chatham
ME4 4TR
DX 140142 CHATHAM 8
lisa.hopson@medway.gov.uk <[mailto: lisa.hopson@medway.gov.uk](mailto:lisa.hopson@medway.gov.uk)>
www.medway.gov.uk

Beat the winter blues with

Medway Switch & Save

A 100% impartial energy switching site.

This message is intended only for the use of person(s) ("the intended recipient(s)") to whom it is addressed. It may contain information which is privileged and confidential within the meaning of the law. If you are not the intended recipient, please contact the sender as soon as possible. The views expressed in this communication may not necessarily be the views of Medway Council.

From: licensing
Sent: 19 January 2017 11:08
To: 'dshepherdneame.co.uk'
Subject: FW: Pier 5 Bar & Kitchen Licence application

Dear P

I refer to your meeting with Peter Gilham and other residents in respect of the above application by Shepherd Neame.

Following this meeting, I understand that certain agreements were reached as set out in the note of discussion attached.

I look forward to hearing from you formally setting out the conditions agreed and that you are prepared to amend your operating schedule accordingly.

Kind Regards,

Lisa.

Lisa Hopson
Licensing Officer
Medway Council
Gun Wharf
Dock Road
Chatham
ME4 4TR
DX 140142 CHATHAM 8
lisa.hopson@medway.gov.uk <[mailto: lisa.hopson@medway.gov.uk](mailto:lisa.hopson@medway.gov.uk)>
www.medway.gov.uk

Beat the winter blues with

Medway Switch & Save

A 100% impartial energy switching site.

This message is intended only for the use of person(s) ("the intended recipient(s)") to whom it is addressed. It may contain information which is privileged and confidential within the meaning of the law. If you are not the intended recipient, please contact the sender as soon as possible. The views expressed in this communication may not necessarily be the views of Medway Council.

Fire alarm system to BS5839, Category L2
Emergency lighting to BS5266
60min fire separation to adjoining occupiers
ATEF=Approved type emergency fastening

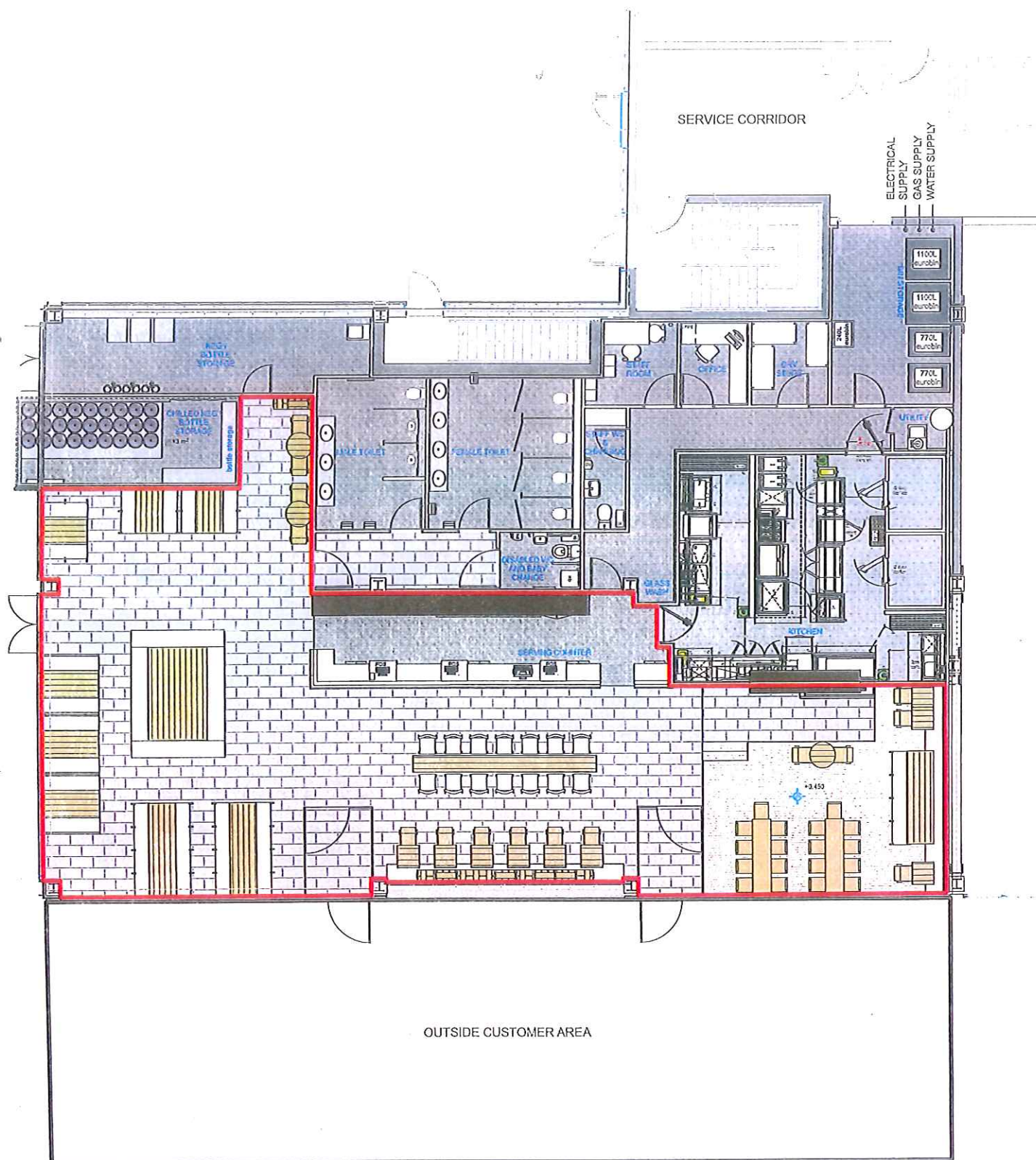

OUTSIDE CUSTOMER AREA

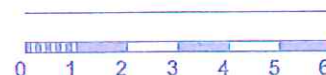

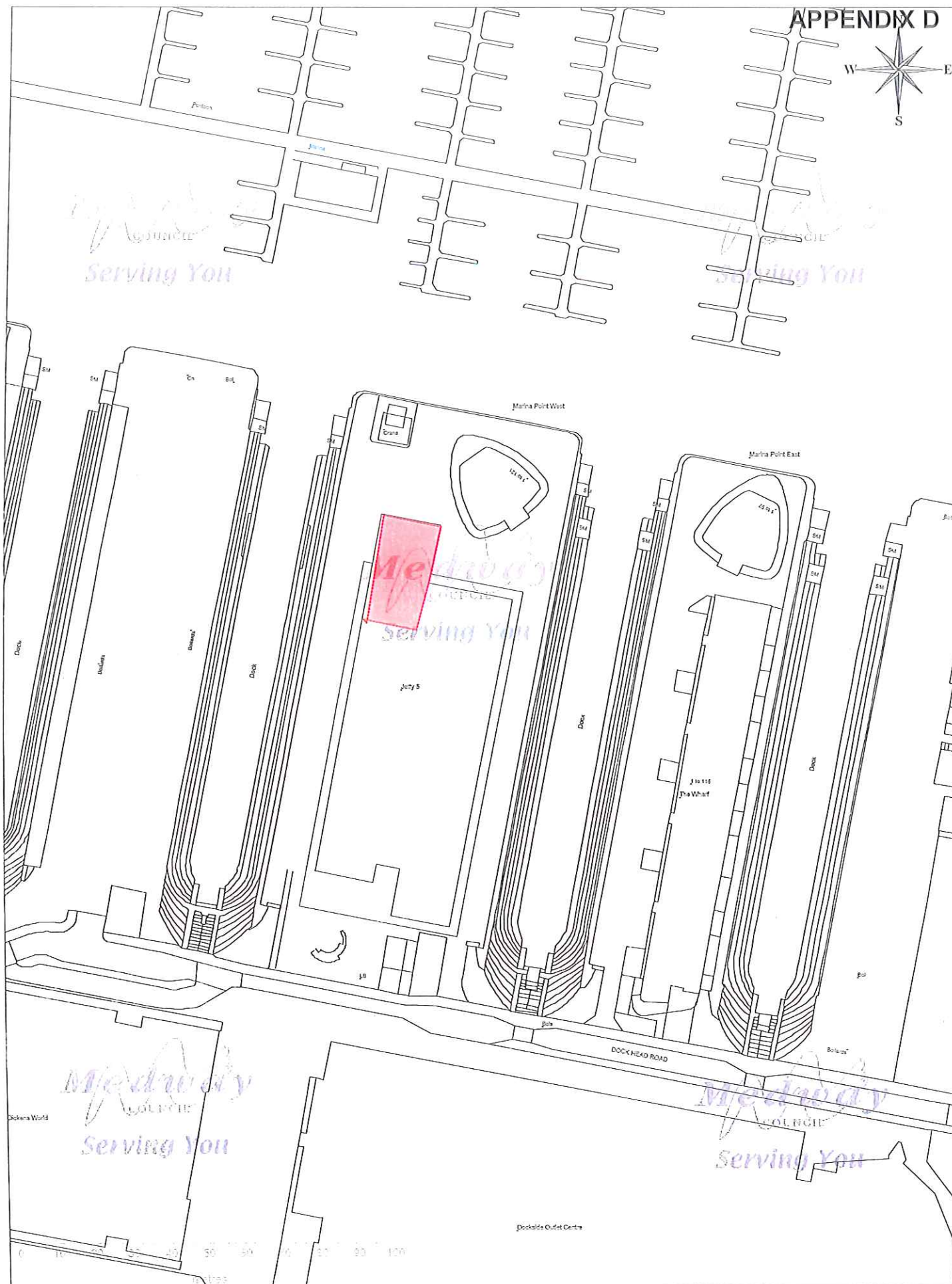
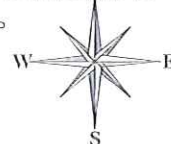

Pier 5 Bar and Kitchen

13 JAN 2017

Date: 12th January 2017

Dear Sir/Madam,

I strongly object to the proposed licence for late night music and drinking. It will de-value my property and it will be unsellable. My apartment is on the 1st floor and is only 20ft away. There is also a terrace opposite my bedroom window. I consider music after 10pm to be anti-social and I believe that it will have a disastrous impact on my life. It is not a suitable environment for music, entertainment and drinking so close to someones bedroom and living room. I only hope that other residents have noticed the small sign and have had enough time to object to this senseless proposal. It will also cause congestion to get into and out of the carpark which is on a busy bus route.

Yours Faithfully
Richard Miles

