



Serving You

Medway Council, Licensing Unit, Gun Wharf, Dock Road, Chatham, Kent ME4 4TR

Application to vary a premises licence under the Licensing Act 2003

**PLEASE READ THE FOLLOWING INSTRUCTIONS FIRST**

Before completing this form please read the guidance notes at the end of the form. If you are completing this form by hand please write legibly in block capitals. In all cases ensure that your answers are inside the boxes and written in black ink. Use additional sheets if necessary.

You may wish to keep a copy of the completed form for your records.

I/We Gurinder Atwal of Atwal Investments Ltd

*(Insert name(s) of applicant)*

being the premises licence holder, apply to vary a premises licence under section 34 of the Licensing Act 2003 for the premises described in Part 1 below

**Premises licence number**

Have not been sent a copy as of yet.

**Part 1 – Premises Details**

Postal address of premises or, if none, ordnance survey map reference or description

70 New Road  
Chatham  
Kent

Post town	Chatham	Postcode	ME4 4QR
-----------	---------	----------	---------

Telephone number at premises (if any)	01634848419
---------------------------------------	-------------

Non-domestic rateable value of premises	:
---	---

**Part 2 – Applicant details**

Daytime contact telephone number	
E-mail address (optional)	
Current postal address if different from premises address	
Post town	Postcode

**Part 3 - Variation**

Please tick as appropriate

Do you want the proposed variation to have effect as soon as possible?

Yes

No

If not, from what date do you want the variation to take effect?

DD	MM	YYYY

**Please describe briefly the nature of the proposed variation (Please see guidance note 1)**

Extending opening hours to the below

Fri - Sat 11:00 - 03:00

Sun 11:00 - 01:00

If your proposed variation would mean that 5,000 or more people are expected to attend the premises at any one time, please state the number expected to attend:

--

#### Part 4 Operating Schedule

Please complete those parts of the Operating Schedule below which would be subject to change if this application to vary is successful.

##### Provision of regulated entertainment

Please tick all that apply

- a) plays (if ticking yes, fill in box A)
- b) films (if ticking yes, fill in box B)
- c) indoor sporting events (if ticking yes, fill in box C)
- d) boxing or wrestling entertainment (if ticking yes, fill in box D)
- e) live music (if ticking yes, fill in box E)
- f) recorded music (if ticking yes, fill in box F)
- g) performances of dance (if ticking yes, fill in box G)
- h) anything of a similar description to that falling within (e), (f) or (g) (if ticking yes, fill in box H)

**Provision of late night refreshment** (if ticking yes, fill in box I)

**Sale by retail of alcohol** (if ticking yes, fill in box J)

**In all cases complete boxes K, L and M**

A

Plays Standard days and timings (please read guidance note 6)			<u>Will the performance of a play take place indoors or outdoors or both – please tick (please read guidance note 2)</u>	Indoors	<input type="checkbox"/>
				Outdoors	<input type="checkbox"/>
				Both	<input type="checkbox"/>
Day	Start	Finish	<u>Please give further details here (please read guidance note 3)</u>		
Mon					
			<u>State any seasonal variations for performing plays (please read guidance note 4)</u>		
Tue					
			<u>Non standard timings. Where you intend to use the premises for the performance of plays at different times to those listed in the column on the left, please list (please read guidance note 5)</u>		
Wed					
Thur					
Fri					
Sat					
Sun					

B

Films Standard days and timings (please read guidance note 6)			<u>Will the exhibition of films take place indoors or outdoors or both – please tick (please read guidance note 2)</u>	Indoors	<input type="checkbox"/>
				Outdoors	<input type="checkbox"/>
				Both	<input type="checkbox"/>
Day	Start	Finish	<u>Please give further details here (please read guidance note 3)</u>		
Mon					
			<u>State any seasonal variations for the exhibition of films (please read guidance note 4)</u>		
Tue					
			<u>Non standard timings. Where you intend to use the premises for the exhibition of films at different times to those listed in the column on the left, please list (please read guidance note 5)</u>		
Wed					
Thur					
Fri					
Sat					
Sun					

C

Indoor sporting events Standard days and timings (please read guidance note 6)			Please give further details (please read guidance note 3)
Day	Start	Finish	
Mon			
Tue			State any seasonal variations for indoor sporting events (please read guidance note 4)
Wed			
Thur			Non standard timings. Where you intend to use the premises for indoor sporting events at different times to those listed in the column on the left, please list (please read guidance note 5)
Fri			
Sat			
Sun			

D

Boxing or wrestling entertainments Standard days and timings (please read guidance note 6)			Will the boxing or wrestling entertainment take place indoors or outdoors or both – please tick (please read guidance note 2)	Indoors	<input type="checkbox"/>
				Outdoors	<input type="checkbox"/>
				Both	<input type="checkbox"/>
Day	Start	Finish	Please give further details here (please read guidance note 3)		
Mon					
			State any seasonal variations for boxing or wrestling entertainment (please read guidance note 4)		
Tue					
			Non standard timings. Where you intend to use the premises for boxing or wrestling entertainment at different times to those listed in the column on the left, please list (please read guidance note 5)		
Wed					
Thur					
Fri					
Sat					
Sun					

E

Live music Standard days and timings (please read guidance note 6)			<u>Will the performance of live music take place indoors or outdoors or both – please tick (please read guidance note 2)</u>	Indoors	<input type="checkbox"/>
				Outdoors	<input type="checkbox"/>
				Both	<input type="checkbox"/>
Day	Start	Finish	<u>Please give further details here (please read guidance note 3)</u>		
Mon					
			<u>State any seasonal variations for the performance of live music (please read guidance note 4)</u>		
Tue					
			<u>Non standard timings. Where you intend to use the premises for the performance of live music at different times to those listed in the column on the left, please list (please read guidance note 5)</u>		
Wed					
Thur					
Fri					
Sat					
Sun					



F

Recorded music Standard days and timings (please read guidance note 6)			<u>Will the playing of recorded music take place indoors or outdoors or both – please tick (please read guidance note 2)</u>	Indoors	<input type="checkbox"/>
				Outdoors	<input type="checkbox"/>
				Both	<input type="checkbox"/>
Day	Start	Finish	<u>Please give further details here (please read guidance note 3)</u>		
Mon					
			<u>State any seasonal variations for the playing of recorded music (please read guidance note 4)</u>		
Tue					
			<u>Non standard timings. Where you intend to use the premises for the playing of recorded music at different times to those listed in the column on the left, please list (please read guidance note 5)</u>		
Wed					
Thur					
Fri					
Sat					
Sun					

G

<b>Performances of dance</b> Standard days and timings (please read guidance note 6)			<b><u>Will the performance of dance take place indoors or outdoors or both – please tick</u></b> (please read guidance note 2)	Indoors	<input type="checkbox"/>
				Outdoors	<input type="checkbox"/>
				Both	<input type="checkbox"/>
Day	Start	Finish	<b><u>Please give further details here</u></b> (please read guidance note 3)		
Mon					
			<b><u>State any seasonal variations for the performance of dance</u></b> (please read guidance note 4)		
Tue					
			<b><u>Non standard timings. Where you intend to use the premises for the performance of dance at different times to those listed in the column on the left, please list</u></b> (please read guidance note 5)		
Wed					
Thur					
Fri					
Sat					
Sun					

H

<b>Anything of a similar description to that falling within (e), (f) or (g)</b> Standard days and timings (please read guidance note 6)			Please give a description of the type of entertainment you will be providing		
Day	Start	Finish	<b>Will this entertainment take place indoors or outdoors or both – please tick</b> (please read guidance note 2)	Indoors	<input type="checkbox"/>
Mon				Outdoors	<input type="checkbox"/>
				Both	<input type="checkbox"/>
Tue			<b>Please give further details here</b> (please read guidance note 3)		
Wed					
Thur			<b>State any seasonal variations for entertainment of a similar description to that falling within (e), (f) or (g)</b> (please read guidance note 4)		
Fri					
Sat			<b>Non standard timings. Where you intend to use the premises for the entertainment of a similar description to that falling within (e), (f) or (g) at different times to those listed in the column on the left, please list</b> (please read guidance note 5)		
Sun					

Late night refreshment Standard days and timings (please read guidance note 6)			<b><u>Will the provision of late night refreshment take place indoors or outdoors or both – please tick</u></b> (please read guidance note 2)	Indoors	<input type="checkbox"/>
				Outdoors	<input checked="" type="checkbox"/>
				Both	<input type="checkbox"/>
Day	Start	Finish	<b><u>Please give further details here</u></b> (please read guidance note 3) We would be willing to do deliveries only if we was granted an extension of our licence. We would lock the doors at 12:30 and not serve any members of the public.		
Mon	11:00	23:00			
Tue	11:00	23:00			
Wed	11:00	23:00			
Thur	11:00	23:00			
Fri	11:00	03:00	<b><u>Non standard timings. Where you intend to use the premises for the provision of late night refreshment at different times, to those listed in the column on the left, please list</u></b> (please read guidance note 5)		
Sat	11:00	03:00			
Sun	11:00	01:00			

J

<b>Supply of alcohol</b> Standard days and timings (please read guidance note 6)			<b>Will the supply of alcohol be for consumption – please tick</b> (please read guidance note 7)	On the premises	<input type="checkbox"/>			
				Off the premises	<input type="checkbox"/>			
				Both	<input type="checkbox"/>			
<b>Day</b>	<b>Start</b>	<b>Finish</b>	<b><u>State any seasonal variations for the supply of alcohol</u></b> (please read guidance note 4)					
Mon								
Tue								
Wed								
Thur						<b><u>Non-standard timings. Where you intend to use the premises for the supply of alcohol at different times to those listed in the column on the left, please list</u></b> (please read guidance note 5)		
Fri								
Sat								
Sun								

K

<p><b>Please highlight any adult entertainment or services, activities, other entertainment or matters ancillary to the use of the premises that may give rise to concern in respect of children</b> (please read guidance note 8).</p>
---

<b>Hours premises are open to the public</b> Standard days and timings (please read guidance note 6)			<b><u>State any seasonal variations</u></b> (please read guidance note 4)          <b><u>Non standard timings. Where you intend the premises to be open to the public at different times from those listed in the column on the left, please list</u></b> (please read guidance note 5)
Day	Start	Finish	
Mon	11:00	23:00	
Tue	11:00	23:00	
Wed	11:00	23:00	
Thur	11:00	23:00	
Fri	11:00	03:00	
Sat	11:00	03:00	
Sun	11:00	01:00	

Please identify those conditions currently imposed on the licence which you believe could be removed as a consequence of the proposed variation you are seeking.  
The timings would change,

Please tick as appropriate

- I have enclosed the premises licence
- I have enclosed the relevant part of the premises licence

If you have not ticked one of these boxes, please fill in reasons for not including the licence or part of it below

Reasons why I have not enclosed the premises licence or relevant part of premises licence.  
I have not received a copy as of yet from midway council.

## **M**

Describe any additional steps you intend to take to promote the four licensing objectives as a result of the proposed variation:

### **a) General – all four licensing objectives (b, c, d and e) (please read guidance note 9)**

### **b) The prevention of crime and disorder**

We have installed a high tech CCTV system. Since our opening there has been a huge drop in prostitution in the area. We report to the police any suspicious activity we see.

Our business is primarily delivery and if the licence was to be extended to 03:00, then we would be willing to do deliveries only. We would close the doors and not serve any customers in the shop, therefore eliminating the chance for there to be any additional noise or nuisance.

We are generally quite far away from any night clubs or pubs.

### **c) Public safety**

We have a fully integrated Fire alarm system with automatic gas cut off switches. Fire extinguishers are also in place.

### **d) The prevention of public nuisance**

The shop internally has been sound proofed. Litter is cleared on a daily basis

### **e) The protection of children from harm**

We have first aid equipment on site to treat any small injuries. We do not sell alcohol on site and neither do we have any gambling machines



Checklist:

Please tick to indicate agreement

- I have made or enclosed payment of the fee.
- I have sent copies of this application and the plan to responsible authorities and others where applicable.
- I understand that I must now advertise my application.
- I have enclosed the premises licence or relevant part of it or explanation.
- I understand that if I do not comply with the above requirements my application will be rejected.

**IT IS AN OFFENCE, LIABLE ON SUMMARY CONVICTION TO A FINE NOT EXCEEDING LEVEL 5 ON THE STANDARD SCALE, UNDER SECTION 158 OF THE LICENSING ACT 2003, TO MAKE A FALSE STATEMENT IN OR IN CONNECTION WITH THIS APPLICATION.**

**Part 5 – Signatures** (please read guidance note 10)

**Signature of applicant (the current premises licence holder) or applicant’s solicitor or other duly authorised agent** (please read guidance note 11). **If signing on behalf of the applicant, please state in what capacity.**

Signature	
Date	10/12/14
Capacity	Director

**Where the premises licence is jointly held, signature of 2nd applicant (the current premises licence holder) or 2nd applicant’s solicitor or other authorised agent** (please read guidance note 12). **If signing on behalf of the applicant, please state in what capacity.**

Signature	
Date	
Capacity	

<b>Contact name (where not previously given) and address for correspondence associated with this application</b> (please read guidance note 13)			
<b>Post town</b>		<b>Post code</b>	
<b>Telephone number (if any)</b>			
<b>If you would prefer us to correspond with you by e-mail, your e-mail address (optional)</b>			

## Notes for Guidance

**This application cannot be used to vary the licence so as to extend the period for which the licence has effect or to vary substantially the premises to which it relates. If you wish to make that type of change to the premises licence, you should make a new premises licence application under section 17 of the Licensing Act 2003.**

1. Describe the premises. For example the type of premises, its general situation and layout and any other information which could be relevant to the licensing objectives. Where your application includes off-supplies of alcohol and you intend to provide a place for consumption of these off-supplies, you must include a description of where the place will be and its proximity to the premises.
2. Where taking place in a building or other structure please tick as appropriate (indoors may include a tent).
3. For example state type of activity to be authorised, if not already stated, and give relevant further details, for example (but not exclusively) whether or not music will be amplified or unamplified.
4. For example (but not exclusively), where the activity will occur on additional days during the summer months.
5. For example (but not exclusively), where you wish the activity to go on longer on a particular day e.g. Christmas Eve.
6. Please give timings in 24 hour clock (e.g. 16:00) and only give details for the days of the week when you intend the premises to be used for the activity.
7. If you wish people to be able to consume alcohol on the premises, please tick 'on the premises'. If you wish people to be able to purchase alcohol to consume away from the premises, please tick 'off the premises'. If you wish people to be able to do both, please tick 'both'.
8. Please give information about anything intended to occur at the premises or ancillary to the use of the premises which may give rise to concern in respect of children regardless of whether you intend children to have access to the premises, for example (but not exclusively) nudity or semi-nudity, films for restricted age groups or the presence of gaming machines.
9. Please list here steps you will take to promote all four licensing objectives together.
10. The application form must be signed.
11. An applicant's agent (for example solicitor) may sign the form on their behalf provided that they have actual authority to do so.
12. Where there is more than one applicant, each of the applicants or their respective agents must sign the application form.
13. This is the address which we shall use to correspond with you about this application.

---

**From:** . . . . .  
**Sent:** 03 March 2014 10:49  
**To:** licensing  
**Subject:** Re: Premises Licence Variation - Papa Johns, New Road  
To licensing

I'm happy and agree with the suggestions made by the police. Licensing.

Thanks gurinder atwal

---

**From:** . . . . .  
**Sent:** 28 February 2014 16:09  
**To:** Christopher Hill PC 46012000  
**Subject:** Re: Premises Licence Variation - Papa Johns, New Road

Hi Chris

Your suggestions are fine and we shall conform to these conditions 100%.

Thank you

Gurinder Atwal

----- Original message -----

From: Christopher Hill PC 46012000

Date: 28/02/2014 16:04 (GMT+00:00)

To: '

Subject: Premises Licence Variation.- Papa Johns, New Road

Mr Atwal,

I have reviewed your application to extend the hours of the premises licence for Papa Johns, 70 New Road, Chatham. I do have some concerns over the hours and as a result I would wish to add the following conditions to your licence to counter any potential problems:

After 0030 hours no items of hot food or refreshments will be available for sale from within the premises or for collection.

After 0030 hours all items sold must be delivered to a specified address and not to persons waiting in a street.

I feel that these conditions will promote the licensing objectives by preventing any additional noise from customers in the area and prevent people (particularly those who are intoxicated) hanging around the location of the premises.

I propose these conditions in addition to your already present CCTV conditions which will remain.

I ask that you consider the content of this email and if you are in agreement then please inform me as such by responding to this email, I will ask Medway Council to add these conditions to your operating schedule and let them know that Kent Police have no formal representation to make regarding this application.

If you wish to discuss this matter with me then please feel free to give me a call.

Kind Regards

Chris

**PC Chris Hill**

North Division Licensing Officer

[Chris.hill@kent.pnn.police.uk](mailto:Chris.hill@kent.pnn.police.uk)

☒ Medway Police Station, Purser Way, Gillingham, Kent. ME 7 1NE.

*Please observe the confidentiality requirements with regard to the information contained within this email or any attached documents and do not forward it onto any other agency/professional without the prior permission of the author.*

*Should this email be received by an unintended recipient, please notify the author immediately. Misuse of any information in this email may constitute a criminal offence.*

## MEDWAY COUNCIL

Licensing Authority, Gun Wharf, Dock Road, Chatham, Kent ME4 4TR

### Premises Licence

Premises Licence Number

**Medway/14/00068/PREM**

#### Part 1 - Premises Details

Postal address of premises, or if none, ordnance survey map reference or description <b>Papa Johns 70 New Road</b>	
Post town	<b>Chatham, Kent</b>
Post code	<b>ME4 4QR</b>
Telephone number	<b>Not Known</b>
Where the licence is time limited the dates:	<b>Not Applicable</b>
Licensable Activities authorised by the licence	<b>Late Night Refreshment (on and off the premises).</b>
The times the licence authorises the carrying out of licensable activities	<b>Friday to Saturday 23:00 to 00:30.</b>
The opening hours of the premises	<b>Monday to Thursday 11:00 to 23:00, Friday to Saturday 11:00 to 00:30 and Sunday 11:00 to 22:30.</b>
Where the licence authorises supplies of alcohol whether these are on and/or off supplies	<b>Not Applicable</b>

#### Part 2

Name, (registered) address, telephone number and e-mail (where relevant) of holder of premises licence <b>Atwal Investments Limited</b>
Registered number of holder, for example company number, charity number (where applicable)

Name, address and telephone number of designated premises supervisor where the premises licence authorises the supply of alcohol <b>Not Applicable</b>
Personal licence number and issuing authority of personal licence held by designated premises supervisor where the premises licence authorises the supply of alcohol <b>Not Applicable</b>

Annex 1 – Mandatory Conditions

**Not Applicable**

Annex 2 – Conditions consistent with the Operating Schedule

**Condition 1**

A CCTV system installed and used for prevention of crime and disorder.

**Condition 2**

Litter is cleared on a daily basis.

Annex 3 – Conditions attached after a hearing by the licensing authority

**Not Applicable**

Annex 4 – Plans

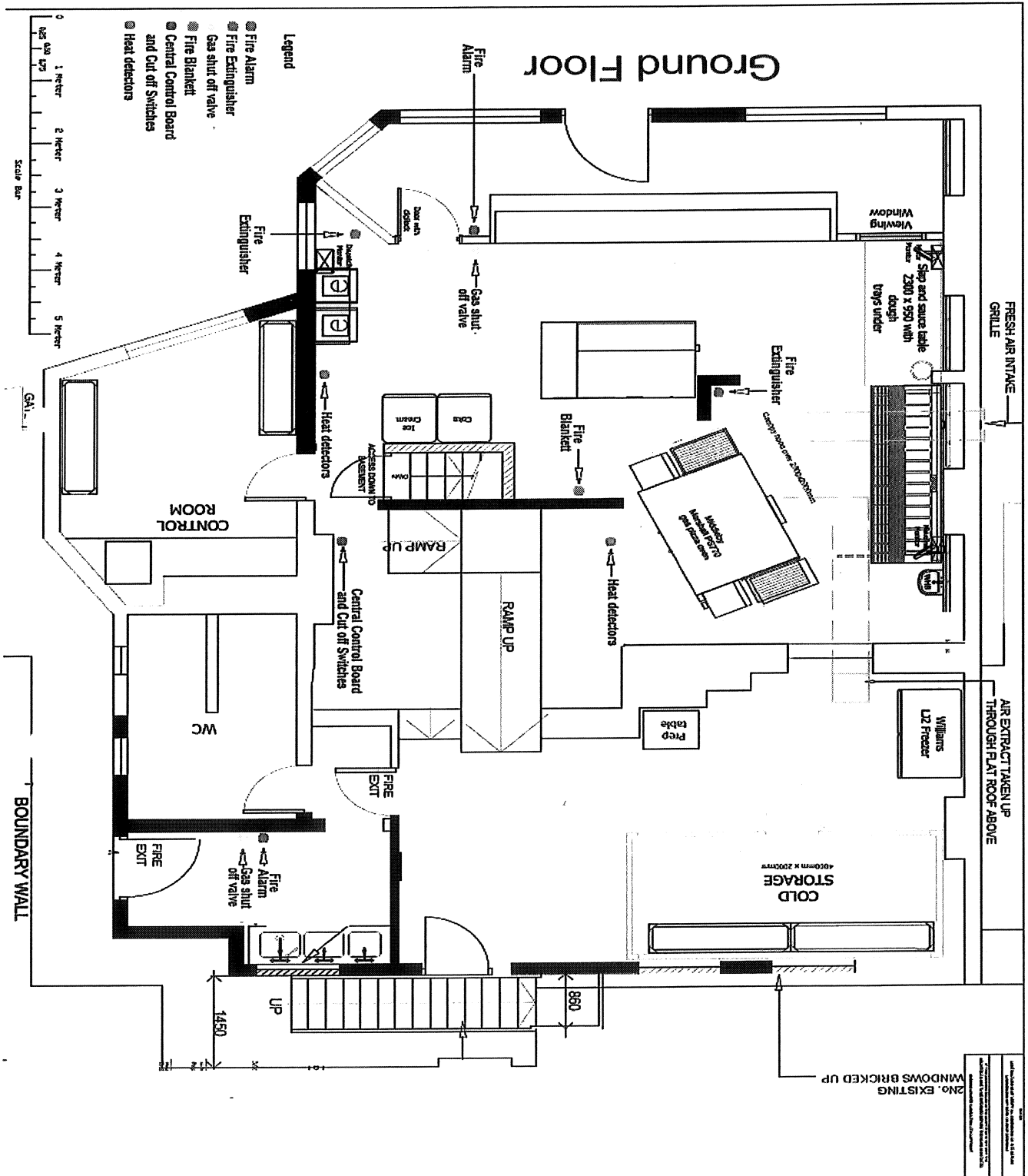

# NORTHGATE SE GIS Print Template



This material has been reproduced from Ordnance Survey digital map data with the permission of the controller of Her Majesty's Stationery Office, © Crown Copyright.

# **CAROL A GILL**

25<sup>th</sup> February 2014

Licensing Unit  
Medway Council  
Gun Wharf  
Dock Road,  
Chatham,  
Kent  
ME4 4TR

Dear Sirs

**LOCATION:** Papa John's, The Ropemaker's Arms, 70 New Road,  
Chatham, ME4 4QR

**PROPOSAL:** Variation of Premises Licence to alter the opening hours  
to Friday-Saturday 11:00am – 03:00am and Sunday  
11:00am – 01:00am

I am writing to object to the above Application as I believe it contravenes the Medway licensing objectives, as follows:-

## **THE PREVENTION OF CRIME AND DISORDER:**

The application to open Papa John's Pizza Take-Away outlet until 03:00am on Friday and Saturday, and 01:00am on Sunday will encourage clients of the OMG nightclub at 3a New Road, Chatham, to remain in the vicinity after the club's closing time of 2am. The club's clients will be traversing the length of Gibraltar Terrace and the homes of local residents to access the Take-Away pizza outlet with the potential to cause noise and public disturbance. There have already been incidents when residents have been roused from sleep because of fights and shouting from clients of the nightclub and the Police have been notified and attended.

Many customers would then be returning along New Road passed Gibraltar Terrace and the homes of local residents to access the railway station and taxicabs, and the bus terminal at the bottom of Maidstone Road. Providing further potential for noise, public disturbance, increased activity levels and traffic generation.

## **PUBLIC SAFETY & THE PREVENTION OF PUBLIC NUISANCE**

With people visiting Papa John's at this time of night after leaving the nightclub it will encourage them to collect outside the Take-Away outlet at the junction of New Road and Old Road with the potential to cause a traffic hazard at the top of the hill.



Customers of Papa John's at this time of night would not be purchasing food to take home but would be consuming it on the street causing the potential for noise, public disturbance and littering.

**PROTECTION OF CHILDREN FROM HARM**

Many of the residents of Gibraltar Terrace and New Road, Chatham are families with young children. The potential for the outbreak of fights, shouting and general public disturbance from clients of OMG Nightclub accessing Papa John's Pizza Take-Away outlet in the early hours of the morning would disturb children's sleep and has the potential to be alarming, frightening or even terrifying for them.

I consider that 12.30am is an appropriate closing time for a Take-Away food outlet in a predominantly residential area.

Yours sincerely

A handwritten signature in black ink, appearing to read 'Mrs Carol A Gill', with a large circular flourish at the bottom.

Mrs Carol A Gill

28 FEB 2014

Licensing Unit  
Medway Council  
Gun Wharf  
Dock Road  
Chatham  
Kent  
ME4 4TR

26 February 2014

Dear Sir/Madam

**Premises Licence Variation for Papa Johns; 70 New Road Chatham**

We wish to register our objection to the Premises licence variation.

We object to this application as we believe it is contrary to the Licensing Objectives of Medway Council in that it will compromise public safety, will give rise to public nuisance and will not contribute to preventing crime and disorder. Our grounds for objecting are:

**Public safety**

- The application means the premises can open from 11am to 3am on Friday and Saturday nights and 1am on Sunday night. No business in this part of the road is open this late and it could impact on the many residents and businesses nearby.
- It is the applicant's intention to attract people to a venue which is situated in a largely residential area and also on a busy main road. Recent experience has seen large numbers of clubbers assemble in the adjacent car park. This appears to be a risk to public safety.

**Prevention of Crime and Disorder**

- This venue seeks to attract customers in the early hours of Friday, Saturday and Sunday morning. It seems likely it will attract people from nearby nightclubs and drinking venues. We note that, unlike a similar application from a sandwich shop in Rochester, no proposal is made for Security staff and this is of concern given the late night opening hours.

**The Prevention of Public Nuisance**

- The proposed licensing hours are from 11am to 3am Friday and Saturday and until 1am on Sunday night. This is a considerable increase on the present time of 11am to 12.30am Friday and Saturday and Sunday until 10.30pm. This will almost certainly cause noise and disturbance to local residents.

Yours faithfully

James Jeffryes

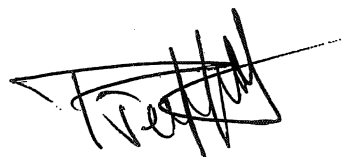

Pascale Jeffryes

---

**From:** Bryan Fowler [  
**Sent:** 28 February 2014 16:56  
**To:** licensing  
**Cc:** g/  
**Subject:** Premises Licence Variation for Papa Johns; 70 New Road Chatham ME4 4QR

## **Premises Licence Variation for Papa Johns; 70 New Road Chatham**

I register my objection to the Premises licence variation.

This is because I believe the application does not meet the Licensing Objectives of Medway Council in that it will compromise public safety, may give rise to public nuisance and will not contribute to preventing crime and disorder. My grounds for objecting are:

### **Public safety**

- The application anticipates that the premises will open from 11am to 3am on Friday and Saturday nights and 1am on Sunday night. No business in this part of the road opens this late and it could impact on the many residents and businesses nearby.
- It is the applicant's intention to attract people to a venue which is situated in a largely residential area and also on a busy main road. Recent experience has seen large numbers of clubbers assemble in the adjacent car park.
- This could attract a number of people arriving either on foot and by vehicles into the early hours of the morning. This take-away venue is situated on the brow of a hill at a challenging bend. To attract more people there in the early hours of the morning appears to be an increased risk to public safety.

### **The Prevention of Public Nuisance**

- The proposed licensing hours are from 11am to 3am Friday and Saturday and until 1am on Sunday night. This is a considerable increase on the present time of 11am to 12.30am Friday and Saturday and Sunday until 10.30pm. This will almost certainly cause noise and disturbance to local residents. While I believe it is seeking to attract customers arriving on by foot and by vehicles, I am also opposed to hot food delivery vehicles, including mopeds, leaving this venue when the majority of neighbours will be asleep.

### **Prevention of Crime and Disorder**

- This venue seeks to attract customers in the early hours of Friday, Saturday and Sunday morning. It seems likely it will attract people from nearby nightclubs and drinking venues. The majority (64%) of all violence occurs in the evening or at night and one-fifth of all violent incidents take place in or around a pub or club\*.  
This proposal may be compared to a recent application from a sandwich shop in Rochester. No proposal is made for Security staff and this is of concern given the late night opening hours.

\*Dealing with the problems of late night drinking [Home Office Consultation document 2012]

Bryan Fowler

3-MAR 2014

Highways Dept.  
Medway Council  
CUN WHARF.  
DOCK ROAD.  
CHATHAM.

02-03-2014.

DEAR SIR.

RE. LARA JOHNS PREMISES HIGHWAY VARIATION.

HAVING READ THE NOTICE IN THE PREMISES WINDOW.

WE WISH TO OBJECT TO THE APPLICATION, ON THE FOLLOWING  
GROUNDS.

1/ PUBLIC SAFETY.

THE PREMISES IS SITUATED ON THE JUNCTION OF  
OLD ROAD AND NEW ROAD ON THE BROW OF THE HILL.  
WE ALREADY EXPERIENCE DIFFICULTY GETTING OUT OF  
OLD ROAD AT BUSY TIMES DUE TO VEHICLES PARKED ON  
THE DOUBLE YELLOW LINES AT THE JUNCTION WHILE CUSTOMERS  
QUE IN THE PREMISES. LATE NIGHT/EARLY MORNINGS WILL  
BE THE SAME. AND DANGEROUS WITH VEHICLES SPEEDING UP  
THE HILL. ADD TO THIS VERY MERELY PEDESTRIANS AND IT  
BECOMES A SERIOUS/FATAL ACCIDENT WAITING TO HAPPEN.

2/ PUBLIC NUISANCE.

WE HAVE ALREADY EXPERIENCED NOISE FROM PEDESTRIANS  
LEAVING LOCAL HIGHSEED PREMISES GOING TO LARA JOHNS.  
AND RUBBISH LEFT AS THEY WALK BACK.

3/ CRIME + DISORDER.

WE HAVE WITNESSED VIOLENT INCIDENTS IN THE PAST  
WITH PATRONS LEAVING HIGHSEED PREMISES, THIS WILL GET  
WORSE WHEN THEY WALK PAST OUR HOMES TO GET ~~LATE NIGHT~~  
EARLY MORNING FOOD. IT WILL CERTAINLY INCREASE THE  
RISK OF CRIME.

YOURS FAITHFULLY

D-S BORLEY

Mrs M A Borley

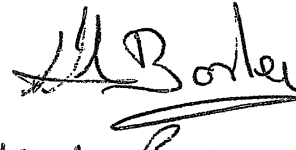
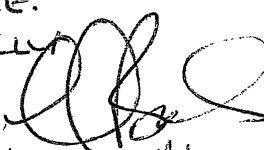

---

: Kyra Harwood-Lucas

06 March 2014 14:02

ensing

ct: Premises Licence Variation for Papa Johns; 70 New Road Chatham ME4 4QR

**ises Licence Variation for Papa Johns; 70 New Road Chatham**

ister our objection to the Premises licence variation.

is because I believe it will give rise to public nuisance and will not contribute to  
enting crime and disorder. My grounds for objecting are:

The application anticipates that the premises will open from 11am to 3am on  
Friday and Saturday nights and 1am on Sunday night. No business in this part  
of the road opens this late and it will impact on the many residents especially  
those with young families.

It is the applicant's intention to attract people to a venue which is situated in a  
largely residential area and also on a busy main road. The last thing my young  
family need is increased reasons for late night disturbance from drunken pub  
and club goers.

This could attract a number of people arriving either on foot and by vehicles into  
the early hours of the morning.

**Prevention of Public Nuisance**

- The proposed licensing hours are from 11am to 3am Friday and Saturday and  
until 1am on Sunday night. This is a considerable increase on the present time  
of 11am to 12.30am Friday and Saturday and Sunday until 10.30pm. This will  
almost certainly cause noise and disturbance to local residents. While I believe  
it is seeking to attract customers arriving on by foot and by vehicles, I am also  
opposed to hot food delivery vehicles, including mopeds, leaving this venue  
when the majority of neighbours will be asleep.

**vention of Crime and Disorder**

- This venue seeks to attract customers in the early hours of Friday, Saturday and  
Sunday morning. It seems likely it will attract people from nearby nightclubs  
and drinking venues. They will then use our front walls to perch on whilst  
eating and talking/arguing loudly.

and James Harwood-Lucas