

# Licensing Hearing Panel – Supplementary Agenda No. 1

**A meeting of the Licensing Hearing Panel will be held on:**

**Date:** 21 December 2021

**Time:** 9.30am

**Venue:** Civic Suite – Level 2, Gun Wharf, Dock Road, Chatham ME4 4TR

## Item

- 6 Application for new Premises Licence, Famous Pizza, 44a Luton Road, Chatham, Kent, ME4 5AB (Pages 3 - 4)**

The agenda for this meeting was published on 13 December 2021, and included, at Appendix A, the application for the new premises licence. The application plan which forms part of Appendix A was not originally provided and is therefore now included.

For further information please contact Debbie Yau, Democratic Services Officer on Telephone: 01634 332947 or Email: [democratic.services@medway.gov.uk](mailto:democratic.services@medway.gov.uk)

**Date: 20 December 2021**

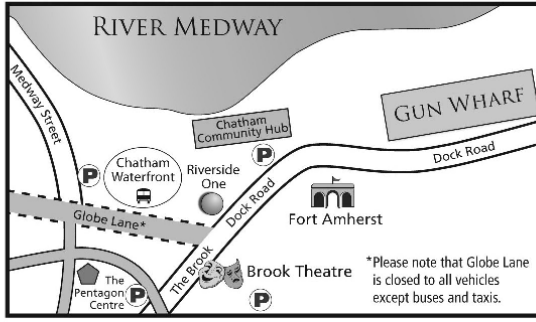

This agenda and reports are available on our website  
[www.medway.gov.uk](http://www.medway.gov.uk)

A summary of this information can be made available in other formats from **01634 333333**

If you have any questions about this meeting and you want to speak to someone in your own language please ring **01634 335577**

বাংলা	331780	ગુજરાતી	331782	ਪੰਜਾਬੀ	331784	كوردی	331841	اروو	331785	Русский	332374
中文	331781	हिंदी	331783	Polski	332373	ଏହେଞ୍ଚକବ	331786	فارسی	331840	Lietuviškai	332372

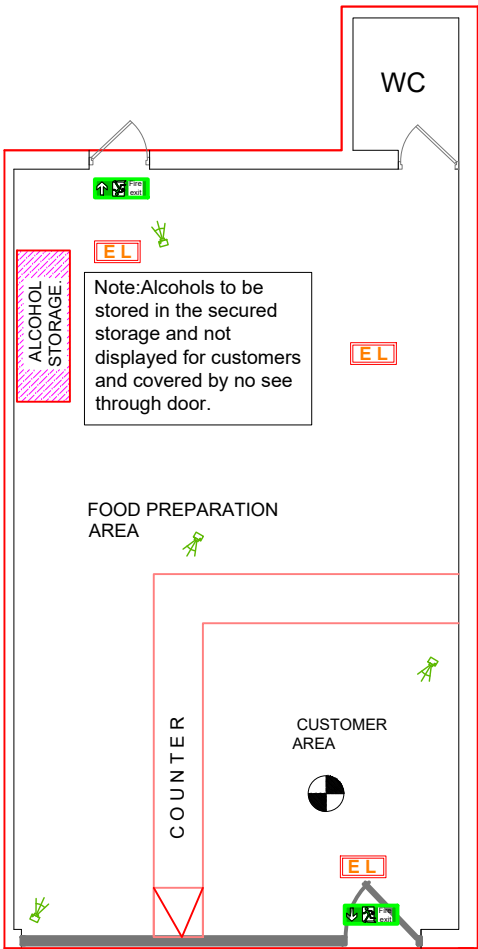

- Key Notes**
1. This shop to have external metal shutter with heavy duty professional locks.
  2. 24Hour recording with cctv cameras to be fixed as shown on the plan.
  3. Fire extinguishers kept in the shop as shown on the plan.
  4. Emergency light fixed to the ceiling as shown.

DESCRIPTION	KEY
FIRE EXIT -	
EMERGENCY LIGHT -	
CCTV CAMERA -	
FIRE EXTINGUISHER -	
ALCOHOL DISPLAY AREA -	
SMOKE DETECTOR -	

**TITLE: SHOP FLOOR LAYOUT**

NAME : MR RUBAN  
 ADDRESS : 44A LUTON ROAD, CHATHAM, ME4 5AS

ARCCI DESIGNS  
 Tel : 079 036 85211 Web : www.arccidesigns.com  
 Fax: 020 8318 9756 Email: admin@arccidesigns.com

**Notes:**  
 • This Drawing is Copyright of ARCCI DESIGNS and may not be reproduced or copied, in whole or in part, without express permission.  
 • This plan drawn for licensing purposes only. ( Licensing Act 2003)  
 • Do not use this drawing for construction/land registry purposes.

DATE : 28.10.2021	Drw No : AD/21/LUT44A/OL 01
Drwn By : ST	SCALE : 1:100 PAGE : 1 OF 1

This page is intentionally left blank